

890mm OVEN HOUSING

Diagram below shows Wooden dowel & mini fix bolt positions for 890mm Oven

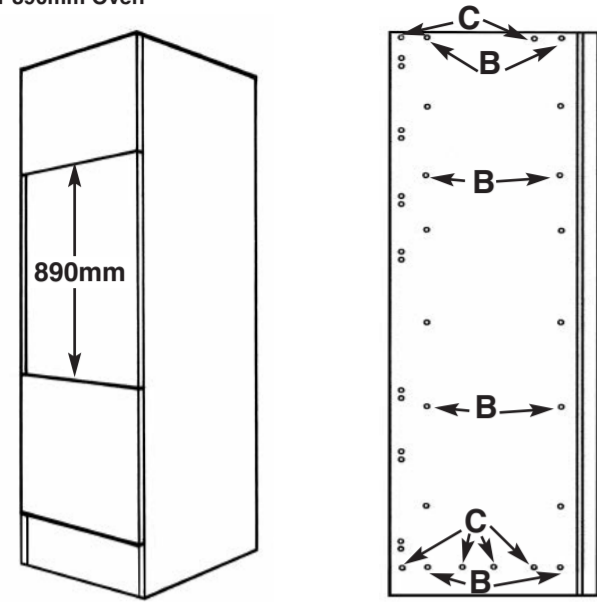

Prior to assembling unit and size of oven has been determined. Fit hinges into doors, place doors against front edge and top & bottom edges of end panel on material that will not damage face of door. The hinges will overlap a pair of hinge plate holes, were they do not the customer will be required to drill a pair of holes to accept hinge plate which screws have a maximum depth of 12mm.

Assembly shows door fitted to left hand end panel. Doors can be fitted either left or right hand hinge. To avoid any surface damage when assembling always ensure panels to be worked on are always placed onto a non abrasive protective surface. It is recommended that door/s and adjustable shelves should only be fitted once units have been installed.

MIDI HEIGHT HOUSINGS:
Assembly for midi height appliance and larder housings are as assembly method illustrated.

INTEGRATED APPLIANCE

Diagram below shows Wooden dowel & mini fix bolt positions for top & bottom shelf only. Other shelf position can only be determine once appliance configuration has been decided.

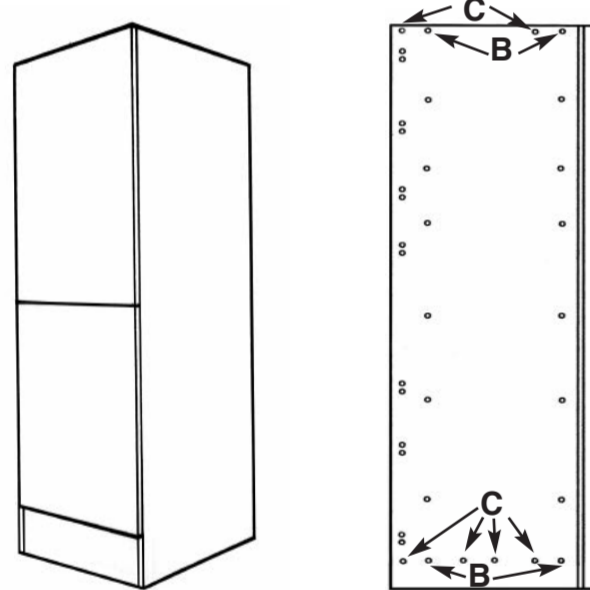

Prior to assembling unit and size of appliance/s has been determined. Fit hinges into doors, place doors against front edge and top & bottom edges of end panel on material that will not damage face of door. The hinges will overlap a pair of hinge plate holes, were they do not the customer will be required to drill a pair of holes to accept hinge plate which screws have a maximum depth of 12mm.

LARDER

Diagram opposite shows Wooden dowel & mini fix bolt positions for top & bottom shelf. The position of internal fixed shelf, mini fix bolts is show by the letter 'B'. This set up is for 715mm top door & 1275mm lower door.

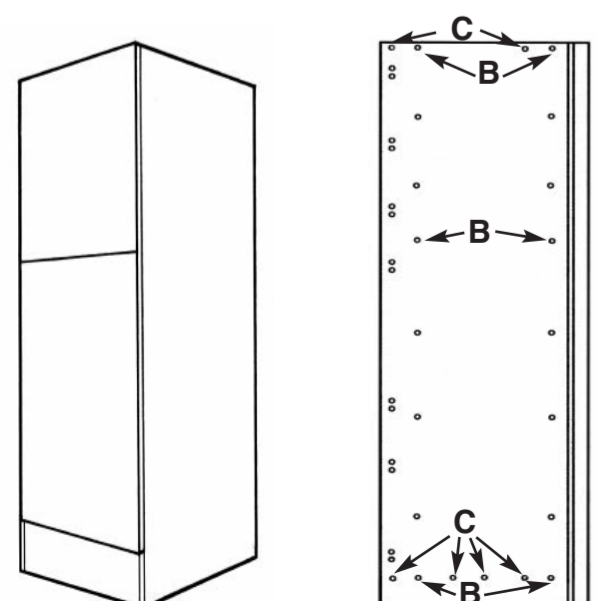

Prior to assembling unit and door configuration has been determined. Fit hinges into doors, place doors against front edge and top & bottom edges of end panel on material that will not damage face of door. The hinges will overlap a pair of hinge plate holes, were they do not the customer will be required to drill a pair of holes to accept hinge plate which screws have a maximum depth of 12mm.

1 **IMPORTANT:** Once handing of unit has been decided, place doors into position against front edge of end panel to establish positioning of hinge plates and internal shelves.
NOTE: Top door top hinge & bottom door bottom hinge positions are fixed. Other hinge positions may need drilling, see online for diagrams.

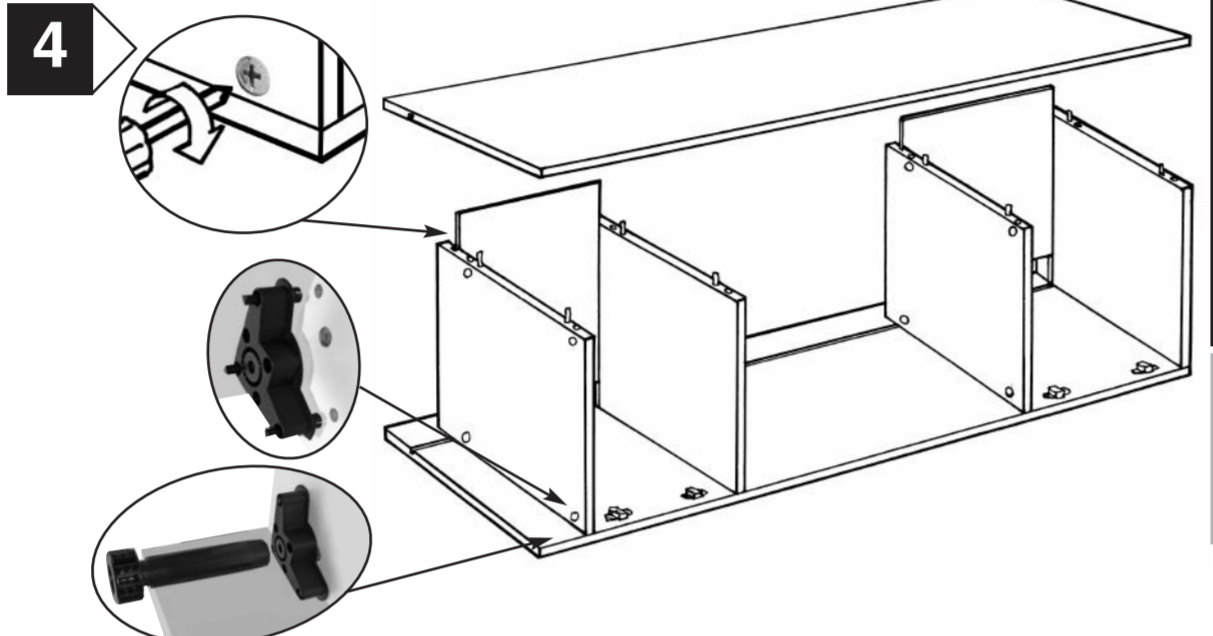
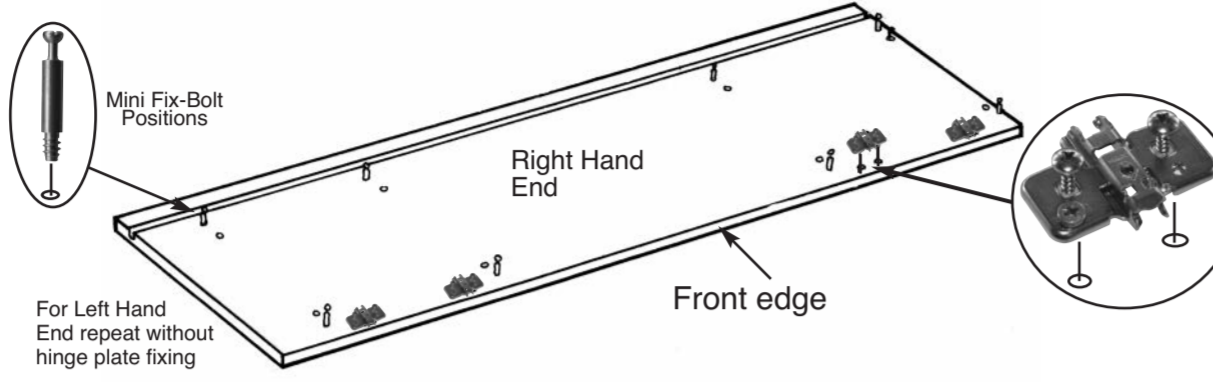

2 Mini-fix cams are fitted to underneath. Groove for back panel is inside cabinet

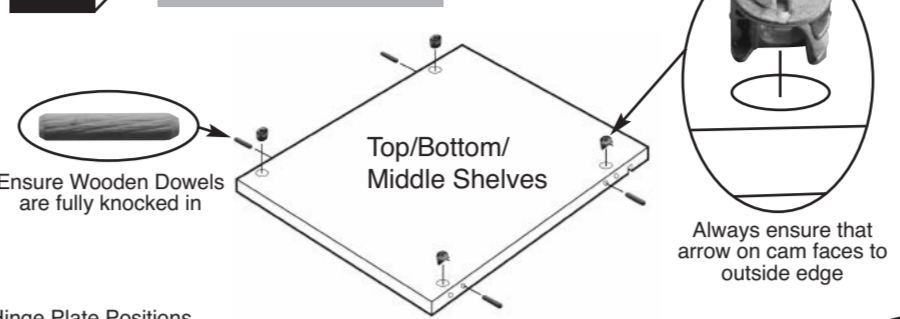

Hinge Plate Positions (Always ensure hinge plate is fitted with arrow facing to outside edge of end panel).

IMPORTANT: Back Panels. As there are various options for the sizes of appliances that can be used, it will be required for back panels to be cut down on site to the required sizes. Once they have been cut to the correct size follow assembly sequence below.

Slide back panels into grooves in shelves and end panels. Place other end panel onto wooden dowels & locate mini-fix bolts into cams and lock. Fit adjustable legs. Bring unit into upright position.

3

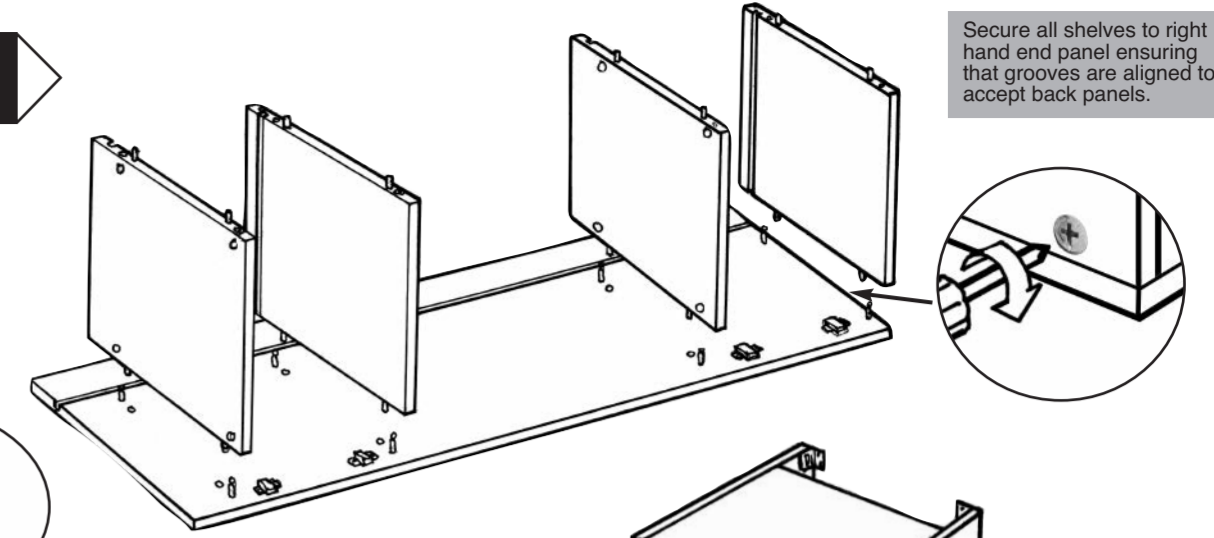

5 **Bracket x 2**
Secure Unit to Wall
Once unit is in correct position secure to wall through brackets fitted to inside face of end panels.

Levelling & Alignment.
Position the unit against the wall, but do not fix it in place. Check that the units are level with each other and the ends are vertical, if they are not then the foot of each leg can be screwed UP or DOWN to bring the unit level.

6

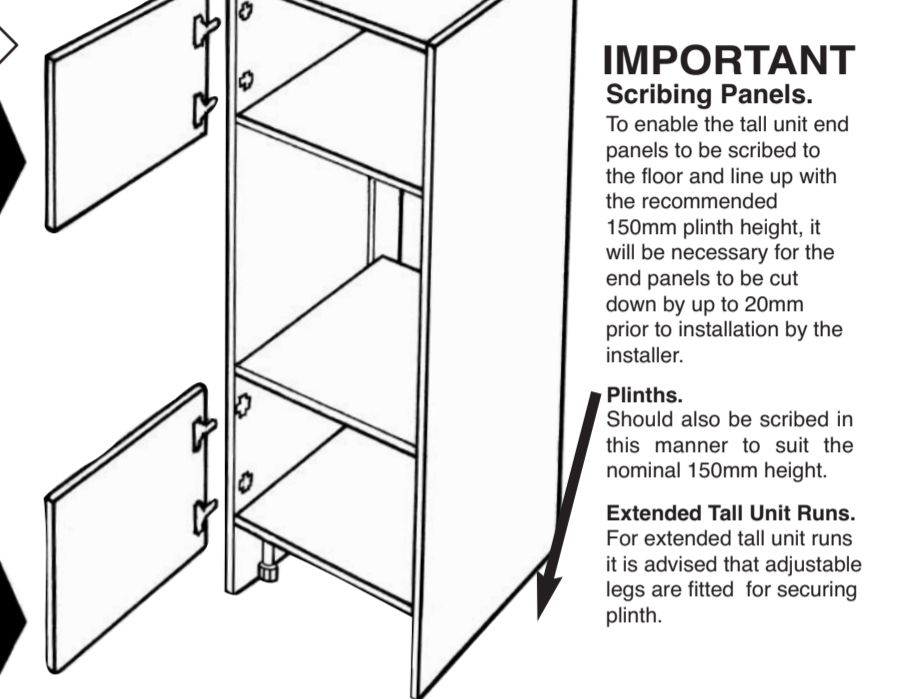

3

Assembly shows positioning for 50/50 split appliances. Other options are available see website: info@jjoplc.com for individual unit details.

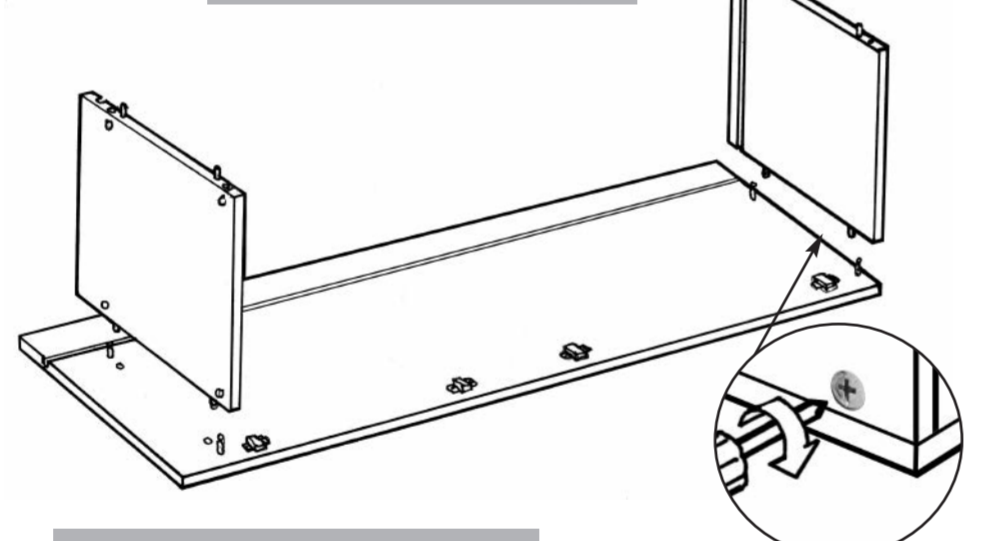

Repeat Steps 1 & 2 from oven housing assembly above.

Secure all shelves to right hand end panel as illustrated. No back panels are required

4

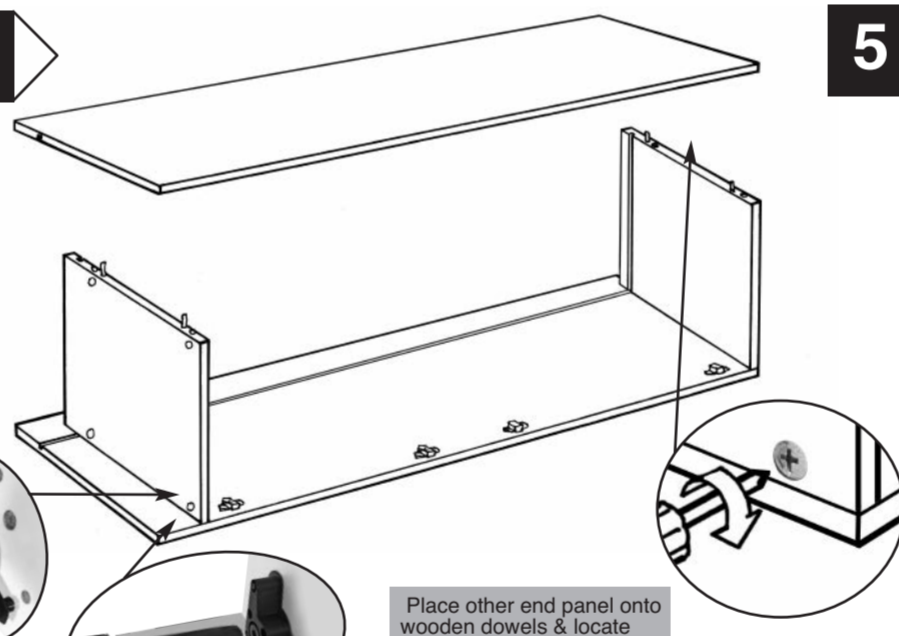

Place other end panel onto wooden dowels & locate mini-fix bolts into cams and lock. Fit adjustable legs. Bring unit into upright position.

5

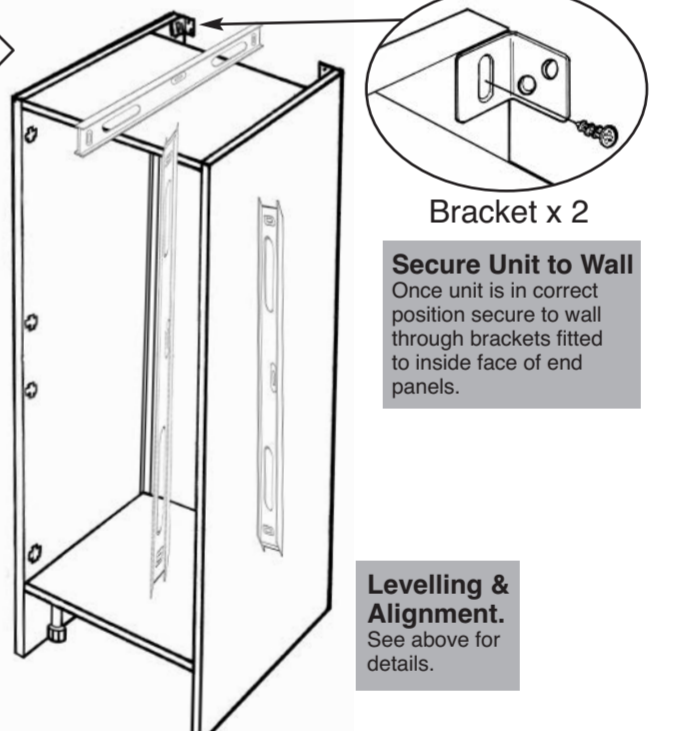

6

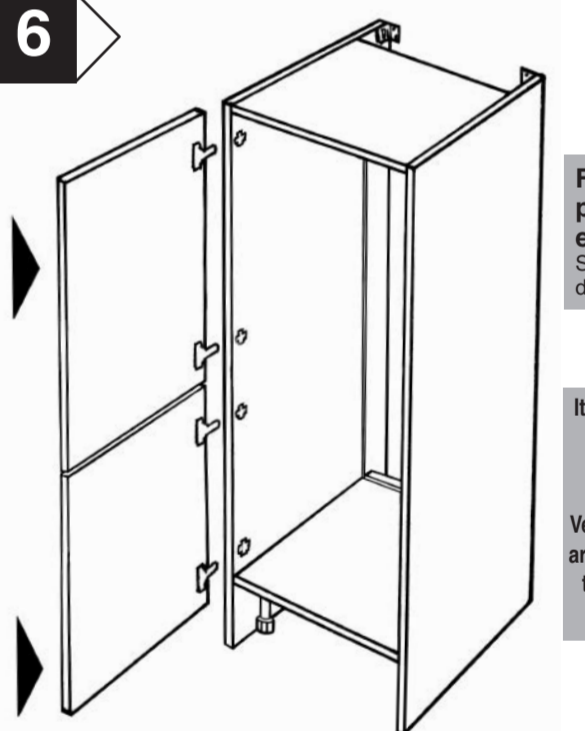

For scribing, plinths & extended runs. See above for details.

It is essential that the Appliance Manufacturers requirement for Ventilation Installation are adhered to. Failure to do so invalidates your guarantee.

3

Secure all shelves to right hand end panel ensuring that grooves are aligned to accept back panels.

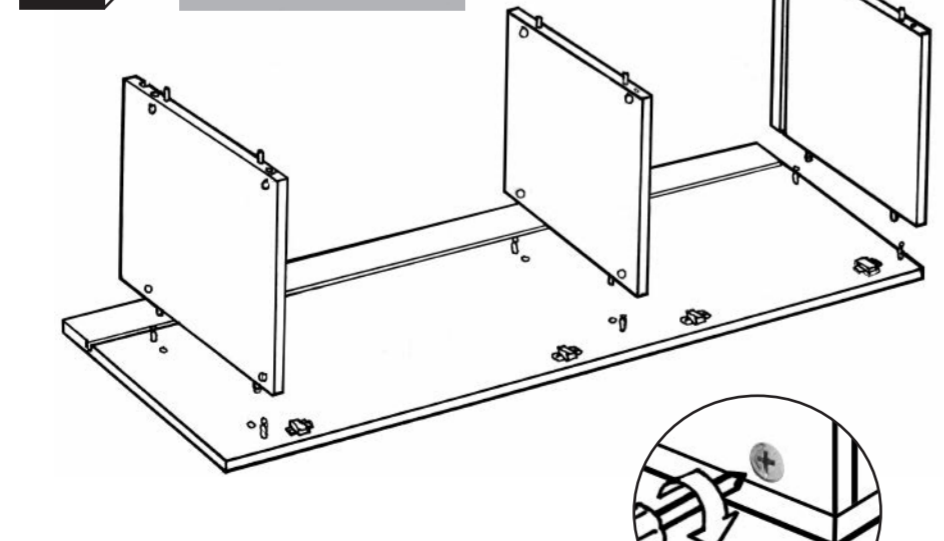

Repeat Steps 1 & 2 from oven housing assembly above.

4

IMPORTANT: There are two options the Larder can be used for. Option 1. With fixed internal shelf. (As shown below). Option 2. For pull out wirework (no fixed internal shelf).

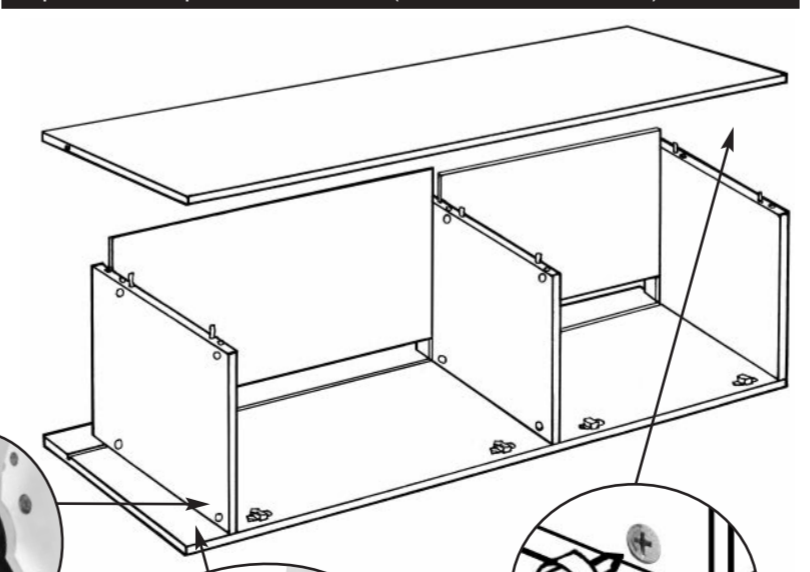

Option 1. As the top back panel is oversized it will be required to be cut down in height by 7mm, once this has been done slide back panels into grooves in shelves and end panel. Place other end panel onto wooden dowels & locate mini-fix bolts into cams and lock. Fit adjustable legs and bring unit into upright position.

Option 2. Slide back panels into grooves in top & bottom shelves and end panel. Place other end panel onto wooden dowels & locate mini-fix bolts into cams and lock. Fit adjustable legs and bring unit into upright position. (If required on the reverse side where both back panels meet a strip of adhesive tape can be used to secure, tape not supplied).

5

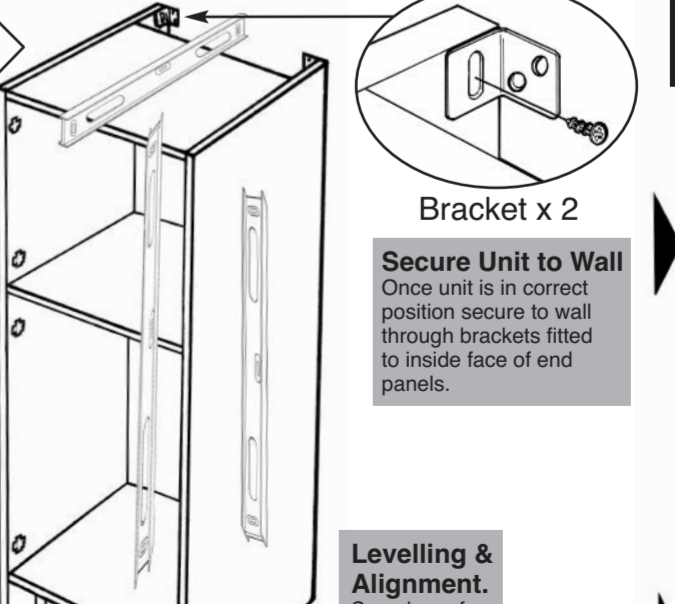

6

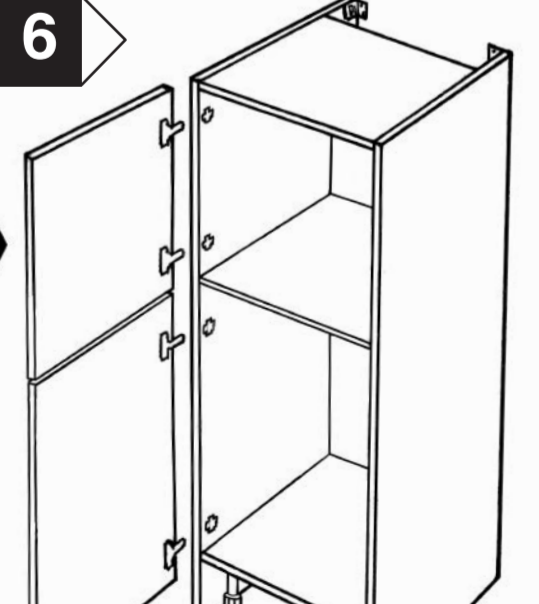

For scribing, plinths & extended runs. See above for details.