

# HOLCOMBE

---

## BEDROOM FURNITURE

---

### ASSEMBLY INSTRUCTIONS

### & AFTER CARE

---



# HOLCOMBE BEDROOMS

## PROUD TO BE MADE IN BRITAIN



### 10-Year Guarantee

We are very confident within the quality of the bedrooms we manufacture.

In the unlikely event that any of the units prove defective as a result of faulty design, materials or manufacturing processes, during a period of ten years from date of purchase.

We will replace or repair at our discretion, providing proof of purchase has been retained by the original purchaser.

The guarantee applies to units & doors only and excludes colour fade, due to mellowing & sunlight.

Any claims must be made as soon as the fault becomes apparent by the original purchaser, through the retailer whom the product was purchased.

Guarantee covers domestic installation only.

**Please ensure the homeowner retains this document after installation is completed**

# Index

<b>Assembly Instructions</b>	<b>– Single &amp; Double Robes</b>	<b>Page 4 - 5</b>
<b>Assembly Instructions</b>	<b>– Robe Internal Drawer Chests</b>	<b>Page 6 - 7</b>
<b>Assembly Instructions</b>	<b>– Combi Robes</b>	<b>Page 8 - 9</b>
<b>Assembly Instructions</b>	<b>– Diagonal Corner Robes</b>	<b>Page 10</b>
<b>Assembly Instructions</b>	<b>Stable Robes</b>	<b>Page 11</b>
<b>Assembly Instructions</b>	<b>– Angled Robes</b>	<b>Page 12</b>
<b>Assembly Instructions</b>	<b>– Bridging Cupboards</b>	<b>Page 13</b>
<b>Assembly Instructions</b>	<b>– Single, Double &amp; Bedside Chests</b>	<b>Page 14 - 15</b>
<b>Assembly Instructions</b>	<b>– Tall Boy Drawer Chests</b>	<b>Page 16 - 17</b>
<b>Assembly Instructions</b>	<b>– Single &amp; Double Drawer Window Seats</b>	<b>Page 18 - 19</b>
<b>Assembly Instructions</b>	<b>– Dressing Tables &amp; Knee Holes</b>	<b>Page 20 - 21</b>
<b>Assembly Instructions</b>	<b>– Floating Bedside Cabinets</b>	<b>Page 22 - 23</b>
<b>Assembly Instructions</b>	<b>– Single &amp; Double Cabinets</b>	<b>Page 24</b>
<b>Assembly Instructions</b>	<b>– Double Corner Base Cabinets</b>	<b>Page 25</b>
<b>Guarantee Detail</b>		<b>Page 26</b>
<b>Care / Maintenance Detail</b>		<b>Page 27</b>

Please examine these drawings very carefully prior to assembly to determine the correct positions for hardware. Failure to do so could result in incorrect fitting or even damage to the items. Do not dispose of any packaging until you have checked the contents and completed assembly. Please check all panels for defects or damage, prior to installation.

#### CONTENTS CHECK LIST



#### DOORS

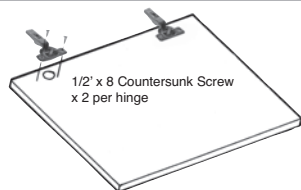

#### CLIP-ON HINGE ADJUSTMENT

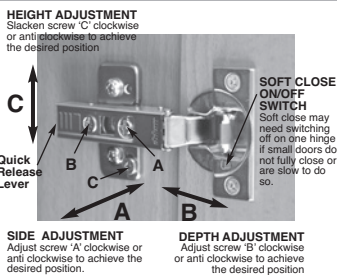

To avoid any surface damage when assembling units always ensure panels to be worked on are always placed onto a non abrasive protective surface.

It is recommended that door/s and adjustable shelves should only be fitted once units have been installed.

#### Robe Assembly - Upright Position

If ceiling height limitations exist, the robe can be assembled in an upright position. If this is the case it will require two people to complete assembly.

## HOLCOMBE BEDROOM FURNITURE

Note: End panels are handed, right or left. when assembling groove in panels should always face rear.

#### SINGLE/DOUBLE ROBE UNITS

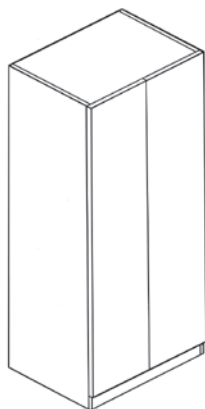

#### Hardware Fixing Positions

A = Hinge Plate Positions  
B = Large Fixing Bolt Positions  
C = Wooden Dowels  
D = Mini Fixing Bolt Positions

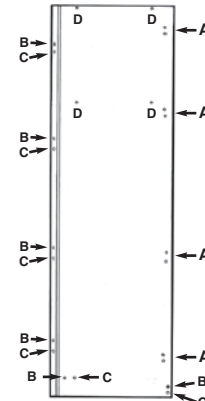

#### DOUBLE ROBE UNIT

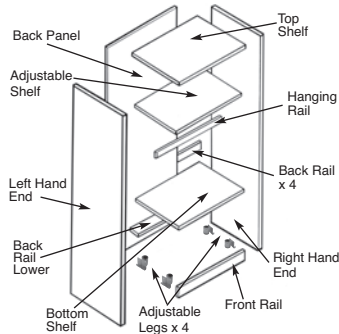

1

Lay end panel face down on protective surface with groove facing upwards. Fix Large Fixing Bolts, Mini Fix Bolts & Hinge Plates into positions indicated. Repeat operation for Left Hand End Panel.

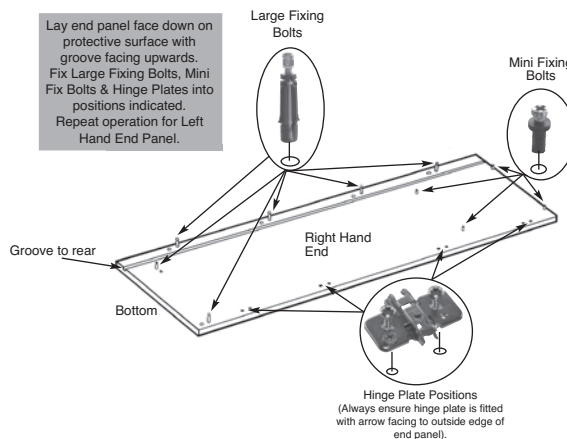

4

Bring all rails into position and secure to end panel as shown. Ensuring all Mini-fix cams are locked fully. Bring top shelf into position and secure to end panel ensuring Fixed shelf cams are locked fully.

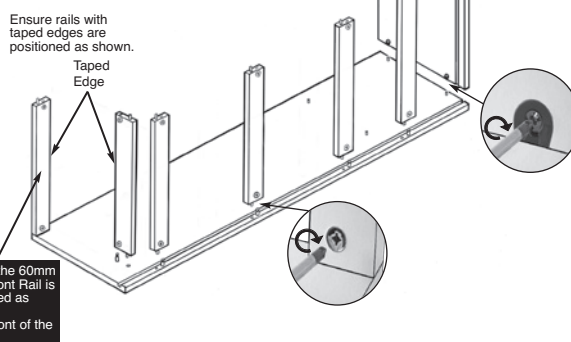

6

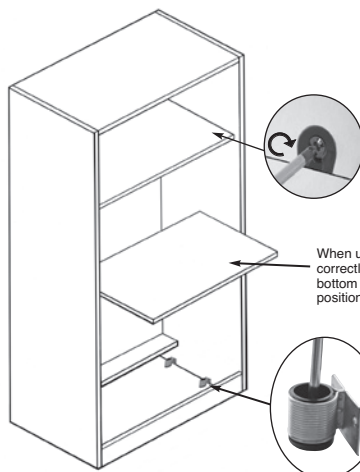

Place unit into position where it is to be located. Level unit by adjusting height in adjustable feet. Once unit is levelled place bottom shelf into position on back rail and front rail. Bring adjustable shelf into position and fully press down onto Mini-fixing bolts. Fully lock all Fixed shelf cams.

When unit has been correctly levelled place bottom shelf into position.

Levelling:  
To adjust legs insert flat head screwdriver, turn clockwise to raise, anti clockwise to lower.

2

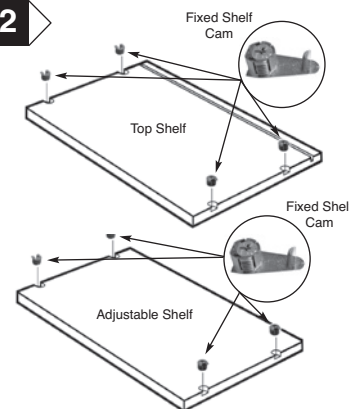

Lay Top Shelf & Adjustable Shelf face down on protective surface (with groove in Top Shelf facing upwards). Firmly press home Fixed Shelf Cams into pre-bored holes ensuring opening in cams face outwards. As an option additional adjustable shelves can be purchased to increase storage capacity. Assembly & installation is as shown in this instruction.

5

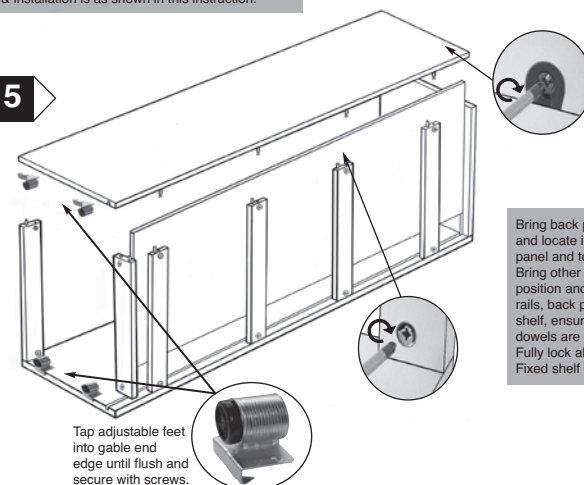

Bring back panel into position and locate into grooves in end panel and top shelf. Bring other end panel into position and place onto all rails, back panel and top shelf, ensuring all cams & dowels are located correctly. Fully lock all Mini-fix cams & Fixed shelf cams.

7

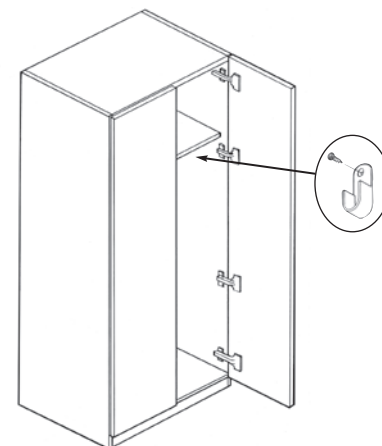

Once adjustable shelf has been placed into position, secure hanging rail support to end panels and place hanging rail into position. Bring door/s into position and place onto hinge plates, lock into position by firmly pressing arm on hinge home. Adjust as shown in diagram opposite. If required the unused pre-bored holes in end panels can be plugged with the 5mm cover caps supplied.

Plant on Panel(s). Will be required to any exposed gable ends to ensure colour co-ordination is maintained. If robes are fitted within a recess they are not required

For more information on product go to: [www.jjoplc.com](http://www.jjoplc.com)

## SINGLE & DOUBLE ROBE UNITS. ASSEMBLY INSTRUCTIONS

3

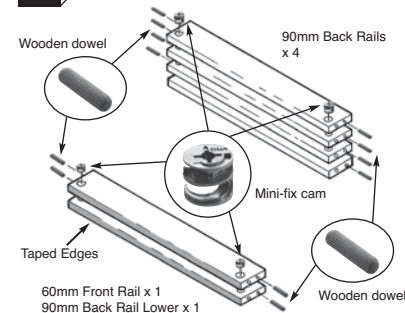

Lay Rails face down on protective surface. Firmly press home Mini Fix Cams into pre-bored holes ensuring arrow on cam faces outwards. Firmly press home wooden dowels into pre-bored holes, ensuring they are fully knocked in. NB: All back rails and back rail lower are 90mm deep, the front rail is 60mm deep. Always ensure the front rail is placed in the correct position when assembling.



Please examine these drawings very carefully prior to assembly to determine the correct positions for hardware. Failure to do so could result in incorrect fitting or even damage to the items. Do not dispose of any packaging until you have checked the contents and completed assembly. Please check all panels for defects or damage, prior to installation.

#### CONTENTS CHECK LIST

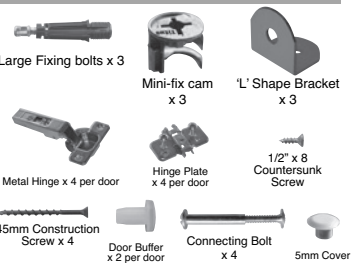

#### DOORS

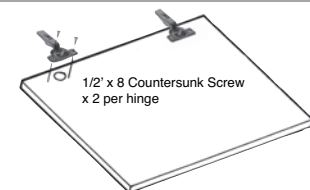

#### CLIP-ON HINGE ADJUSTMENT

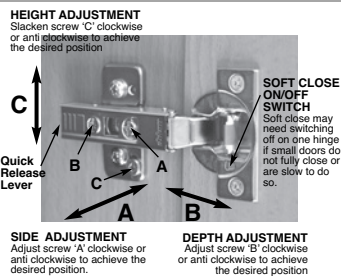

To avoid any surface damage when assembling units always ensure panels to be worked on are always placed onto a non abrasive protective surface.

It is recommended that door/s and adjustable shelves should only be fitted once units have been installed.

#### Robe Assembly - Upright Position

If ceiling height limitations exist, the robe can be assembled in an upright position. If this is the case it will require two people to complete assembly.

## HOLCOMBE BEDROOM FURNITURE

Please Note: Follow steps 1 - 6 of single & double robe assembly. (Do not fit hinge plates to end panels). Prior to fitting corner post please ensure that the correct handing of door has been decided. Failure to do so could result in unnecessary damage.

#### DOUBLE CORNER ROBE UNITS

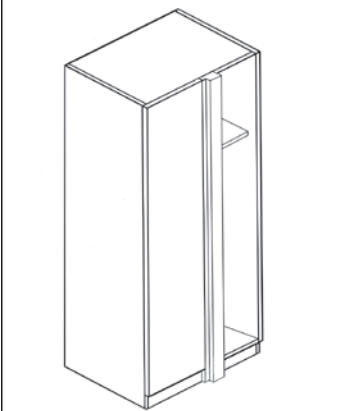

#### DOUBLE CORNER ROBE UNIT

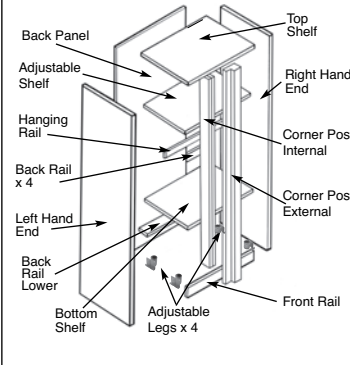

1

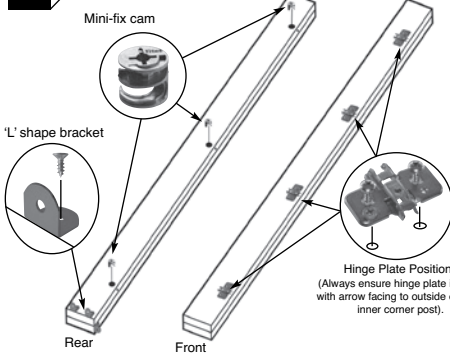

Lay inner corner post face down on protective surface with pre-bored holes facing upwards, firmly press home into holes Mini Fix Cams ensuring arrow on cam faces outwards. Fit 'L' shape brackets x 3 to inner corner post with screws provided. Turn post over and fix Hinge Plates into positions indicated.

1A

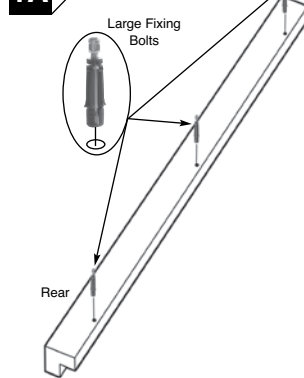

Lay corner post face down on protective surface with pre-bored holes facing upwards. Fix Large Fixing Bolts into positions indicated.

2

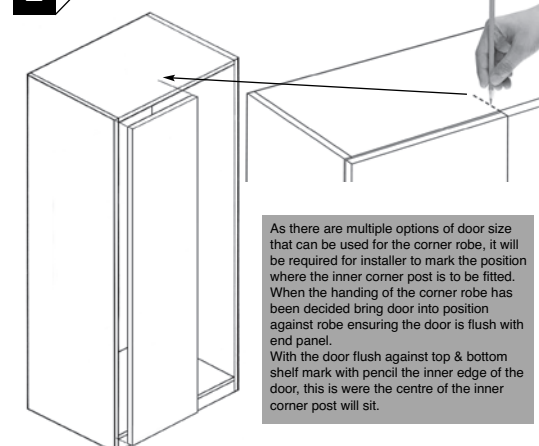

As there are multiple options of door size that can be used for the corner robe, it will be required for installer to mark the position where the inner corner post is to be fitted. When the handing of the corner robe has been decided bring door into position against robe ensuring the door is flush with end panel. With the door flush against top & bottom shelf mark with pencil the inner edge of the door, this is where the centre of the inner corner post will sit.

3

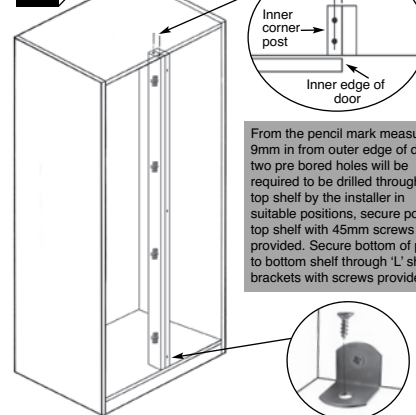

From the pencil mark measure 9mm in from outer edge of door, two pre bored holes will be required to be drilled through the top shelf by the installer in suitable positions, secure post to top shelf with 45mm screws provided. Secure bottom of post to bottom shelf through 'L' shape brackets with screws provided.

4

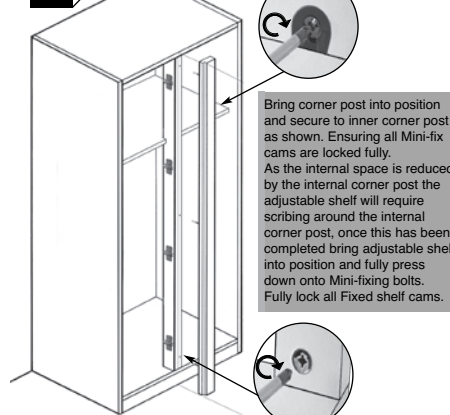

Bring corner post into position and secure to inner corner post as shown. Ensuring all Mini-fix cams are locked fully. As the internal space is reduced by the internal corner post the adjustable shelf will require scribing around the internal corner post, once this has been completed bring adjustable shelf into position and fully press down onto Mini-fixing bolts. Fully lock all Fixed shelf cams.

5

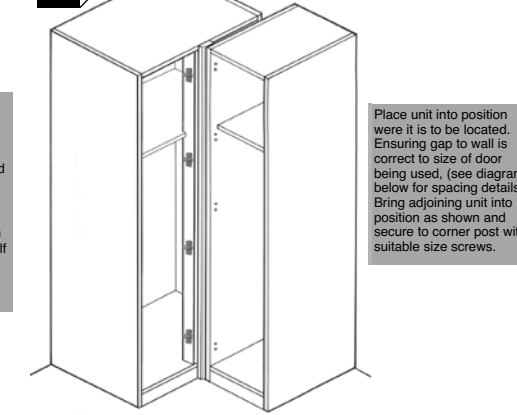

Place unit into position where it is to be located. Ensuring gap to wall is correct to size of door being used, (see diagrams below for spacing details). Bring adjoining unit into position as shown and secure to corner post with suitable size screws.

6

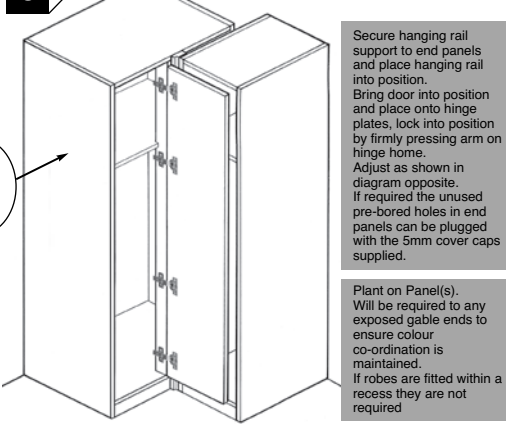

Secure hanging rail support to end panels and place hanging rail into position. Bring door into position and place onto hinge plates, lock into position by firmly pressing arm on hinge home. Adjust as shown in diagram opposite. If required the unused pre-bored holes in end panels can be plugged with the 5mm cover caps supplied.

Plant on Panel(s). Will be required to any exposed gable ends to ensure colour co-ordination is maintained. If robes are fitted within a recess they are not required

#### CORNER SITUATIONS

All dimensions in Millimeters

When fitting corner robes the following dimensions should be used.

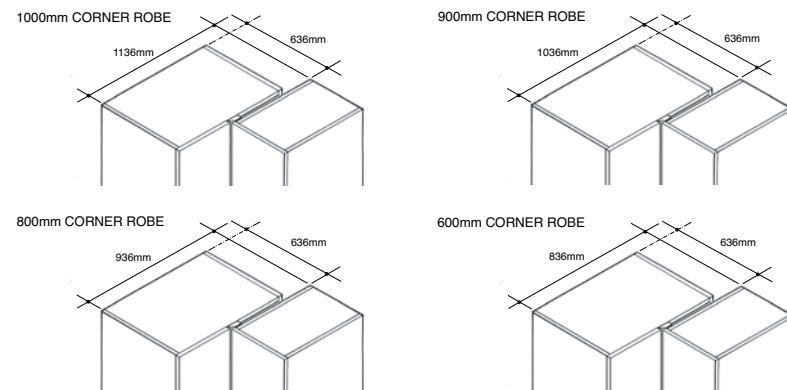

Please examine these drawings very carefully prior to assembly to determine the correct positions for hardware. Failure to do so could result in incorrect fitting or even damage to the items. Do not dispose of any packaging until you have checked the contents and completed assembly. Please check all panels for defects or damage, prior to installation.

## HOLCOMBE BEDROOM FURNITURE

## INTERNAL DRAWER CHESTS.

For more information on product go to: [www.jjoplc.com](http://www.jjoplc.com)

Note: End panels are universal and handed, right or left. when assembling always ensure correct handing has been selected.

### ANTARO DRAWER SYSTEM

#### INTERNAL DRAWER CHESTS

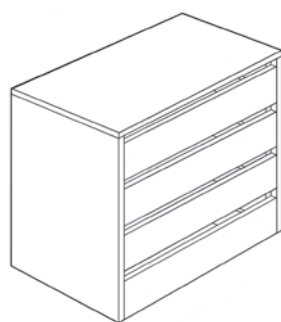

#### INTERNAL DRAWER CHESTS

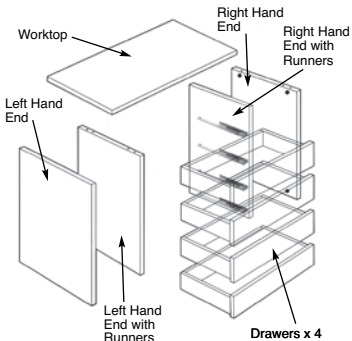

#### CONTENTS CHECK LIST

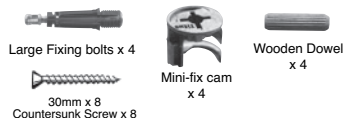

#### CLIP-ON HINGE ADJUSTMENT

**HEIGHT ADJUSTMENT**  
Slacken screw 'C' clockwise or anti clockwise to achieve the desired position

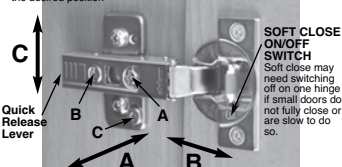

**SIDE ADJUSTMENT**  
Adjust screw 'A' clockwise or anti clockwise to achieve the desired position.

**DEPTH ADJUSTMENT**  
Adjust screw 'B' clockwise or anti clockwise to achieve the desired position

#### DRAWER BRACKET



#### FIXING DRAWER BRACKET TO DRAWER FRONT

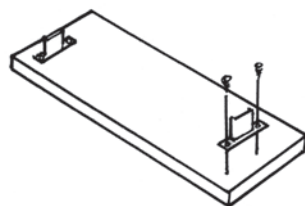

To avoid any surface damage when assembling units always ensure panels to be worked on are always placed onto a non abrasive protective surface.

It is recommended that drawers should only be fitted once units have been installed.

1

As the end panels are universal it is only required for mini-fix cams and wooden dowels to be installed as shown below.  
Lay end panels face down on protective surface. Firmly press home Mini Fix cams into pre-bored holes ensuring arrow on cam faces outwards.  
Firmly press home wooden dowels into pre-bored holes, ensuring they are fully knocked in.  
Repeat operation for Left hand end panel.

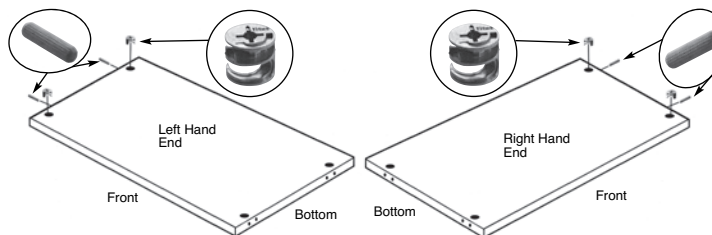

4

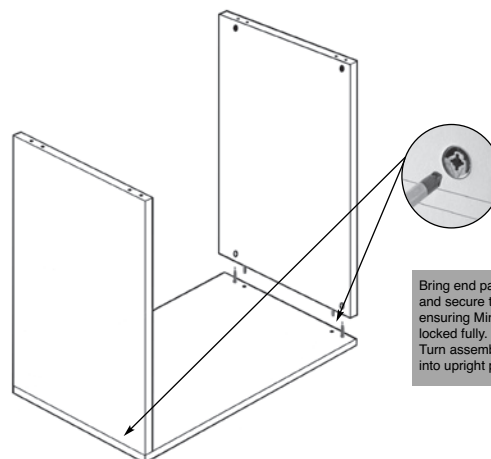

2

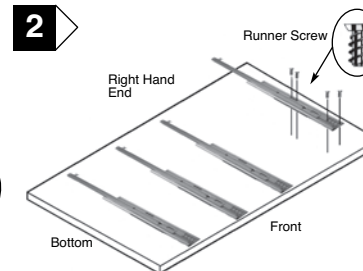

Lay end panels for drawer runners face down on protective surface.  
Bring Drawer runners into position and fix to end panels into pre-bored holes with runner screws.  
Repeat operation for Left hand end panel.

3

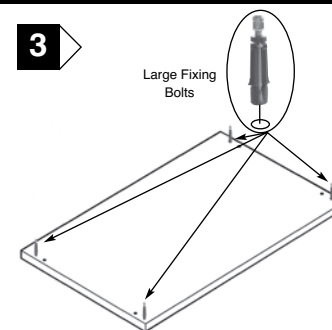

Lay worktop face down on protective surface.  
Fix Large Fixing Bolts into positions indicated.

5

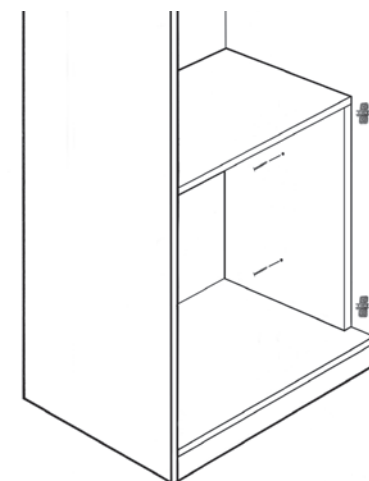

Place assembled panels into robe ensuring it is fully pressed home against back panel.  
Both end panels require to be secured to robe end panels with screws provided.  
It is left for installer to decide on position where holes are to be drilled for screws to be secured.

7

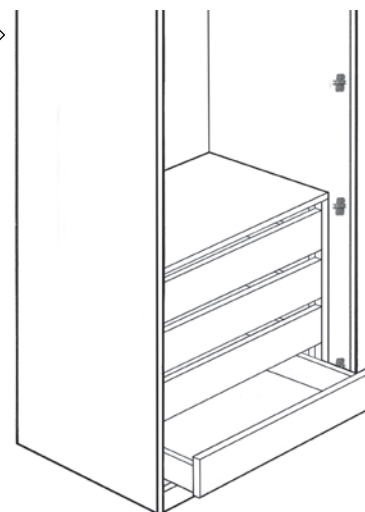

Once drawer fronts are fitted to drawer boxes bring drawers into position and place onto fully extended runners. Ensure drawer runner locates into the rear of the drawer box (small pre drilled hole). Firmly close the drawer into the unit. The drawer should locate onto the runner. Repeat this action with each drawer.

8

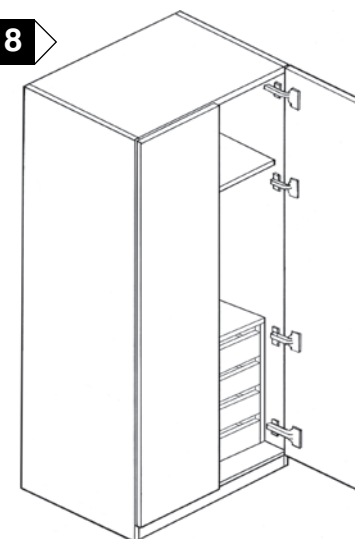

Once adjustable shelf has been placed into position, secure hanging rail support to end panels and place hanging rail into position.  
Bring door/s into position and place onto hinge plates, lock into position by firmly pressing arm on hinge home.  
Adjust as shown in diagram opposite.  
If required the unused pre-bored holes in end panels can be plugged with the 5mm cover caps supplied.

Plant on Panel(s). Will be required to any exposed gable ends to ensure colour co-ordination is maintained.

Please examine these drawings very carefully prior to assembly to determine the correct positions for hardware. Failure to do so could result in incorrect fitting or even damage to the items. Do not dispose of any packaging until you have checked the contents and completed assembly. Please check all panels for defects or damage, prior to installation.

#### CONTENTS CHECK LIST

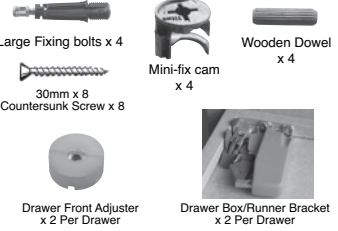

#### FIXING DRAWER FRONT TO DRAWER BOX

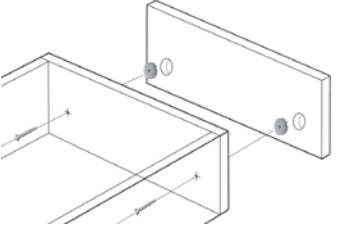

Firmly press drawer front adjusters into pre-bored holes in drawer front, bring drawer box into position and secure to drawer front with screws provided through pre-bored holes in drawer box.

Turn drawer over and fit drawer runner brackets to underside of drawer box with screws provided as shown below.

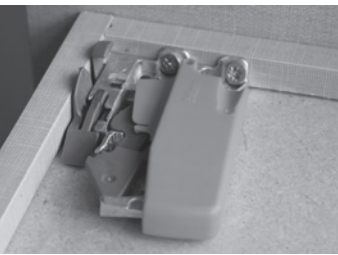

#### CLIP-ON HINGE ADJUSTMENT

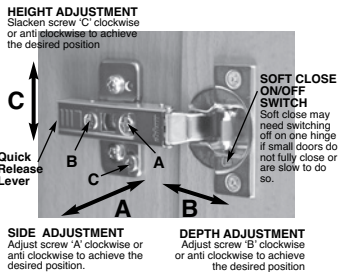

## HOLCOMBE BEDROOM FURNITURE

## INTERNAL DRAWER CHESTS.

For more information on product go to: [www.jjopl.com](http://www.jjopl.com)

### GREY TEXTILE DRAWER SYSTEM

#### INTERNAL DRAWER CHESTS

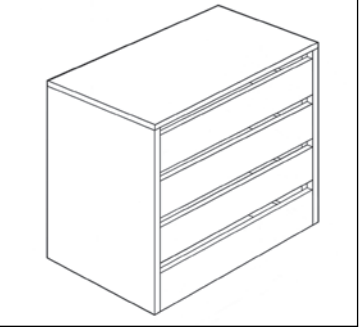

#### INTERNAL DRAWER CHESTS

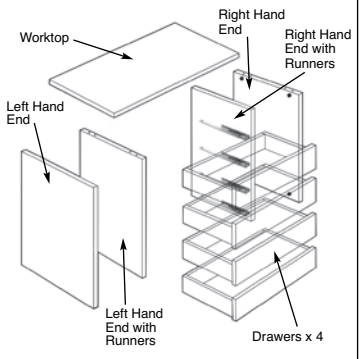

1

As the end panels are universal it is only required for mini-fix cams and wooden dowels to be installed as shown below.  
Lay end panels face down on protective surface. Firmly press home Mini Fix cams into pre-bored holes ensuring arrow on cam faces outwards.  
Firmly press home wooden dowels into pre-bored holes, ensuring they are fully knocked in.  
Repeat operation for Left hand end panel.

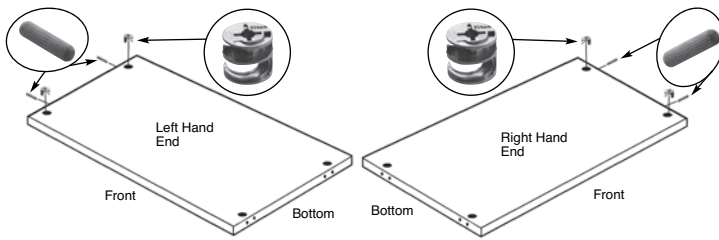

4

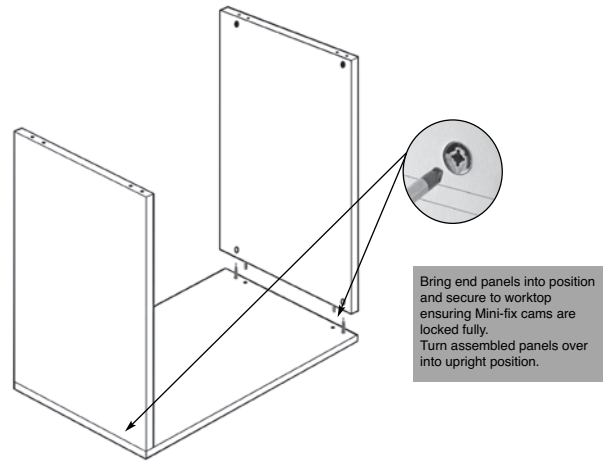

2

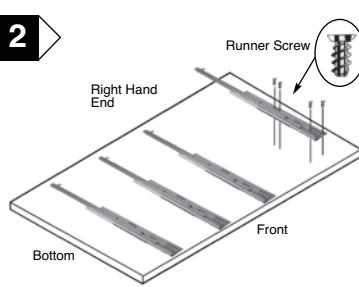

Lay end panels for drawer runners face down on protective surface.  
Bring Drawer runners into position and fix to end panels into pre-bored holes with runner screws.  
Repeat operation for Left hand end panel.

3

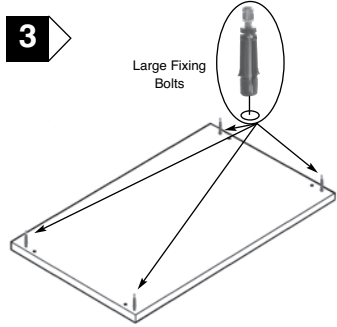

Lay worktop face down on protective surface.  
Fix Large Fixing Bolts into positions indicated.

5

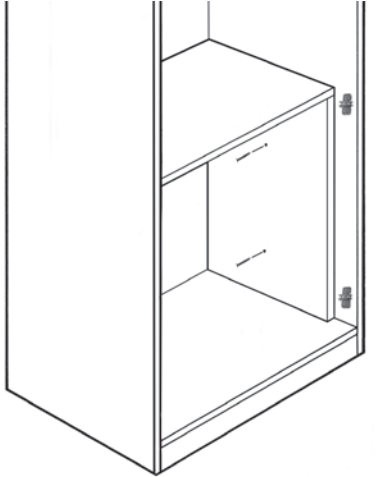

Place assembled panels into robe ensuring it is fully pressed home against back panel.  
Both end panels require to be secured to robe end panels with screws provided.  
It is left for installer to decide on position where holes are to be drilled for screws to be secured.

6

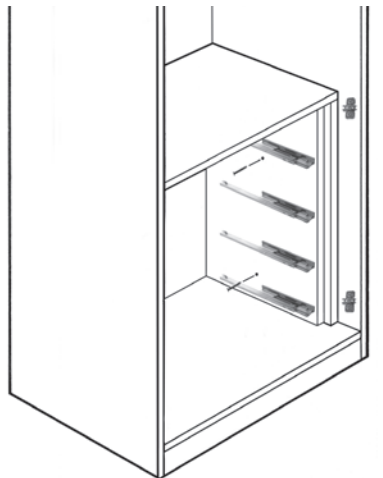

7

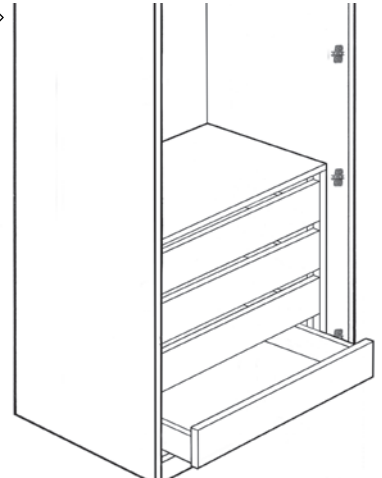

Place end panels with drawer runners fitted into position against unit end panels.  
Both end panels with drawer runners fitted require to be secured to unit end panels with screws provided.  
It is left for installer to decide on position where holes are to be drilled for screws to be secured.

8

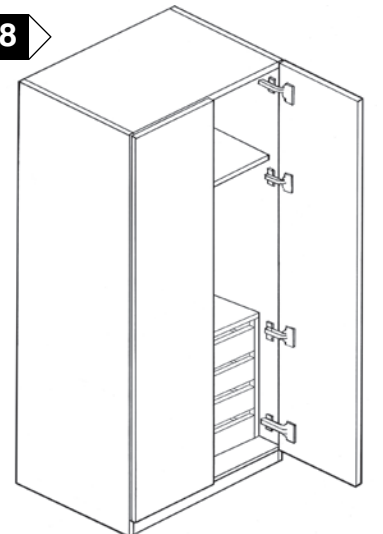

Bring drawers into position and place on to fully extended runners.  
Ensure drawer runner locates into the rear of the drawer box (small pre drilled hole). Firmly close the drawer into the unit.  
The drawer should locate onto the runner. Repeat this action with each drawer.  
If drawer fascia adjustment is required, slacken drawer fascia retaining screws. Within the drawer front adjuster there is a floating mechanism which allows for 2mm adjustment in two directions. Adjust as necessary and tighten drawer fascia retaining screws.  
If required unused pre bored holes in end panels can be plugged using 5mm cover caps supplied.

Once adjustable shelf has been placed into position, secure hanging rail support to end panels and place hanging rail into position.  
Bring door/s into position and place onto hinge plates, lock into position by firmly pressing arm on hinge home.  
Adjust as shown in diagram opposite.  
If required the unused pre-bored holes in end panels can be plugged with the 5mm cover caps supplied.

Plant on Panel(s). Will be required to any exposed gable ends to ensure colour co-ordination is maintained.



Please examine these drawings very carefully prior to assembly to determine the correct positions for hardware. Failure to do so could result in incorrect fitting or even damage to the items. Do not dispose of any packaging until you have checked the contents and completed assembly. Please check all panels for defects or damage, prior to installation.

### CONTENTS CHECK LIST

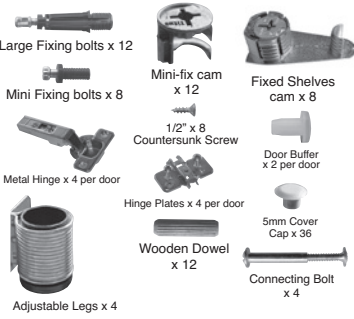

### DOORS

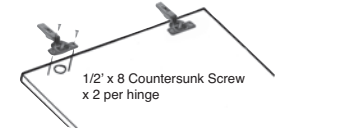

### CLIP-ON HINGE ADJUSTMENT

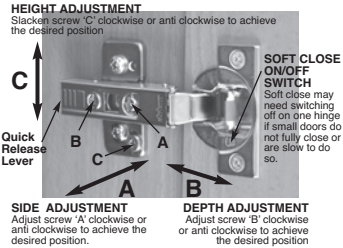

### FIXING DRAWER BRACKET TO DRAWER FRONT

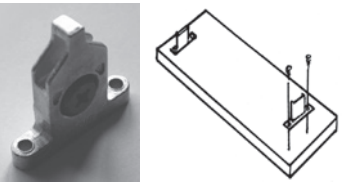

It is recommended that door/s and adjustable shelves should only be fitted once units have been installed.

### Robe Assembly - Upright Position

If ceiling height limitations exist, the robe can be assembled in an upright position. If this is the case it will require two people to complete assembly.

## HOLCOMBE BEDROOM FURNITURE

Note: End panels are handed, right or left, when assembling groove in panels should always face to rear.

### ANTARO DRAWER SYSTEM

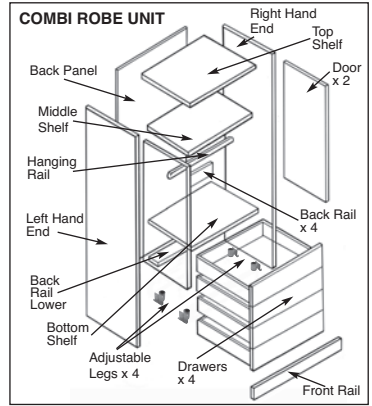
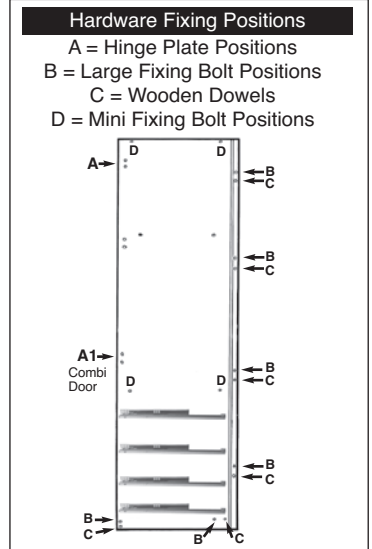
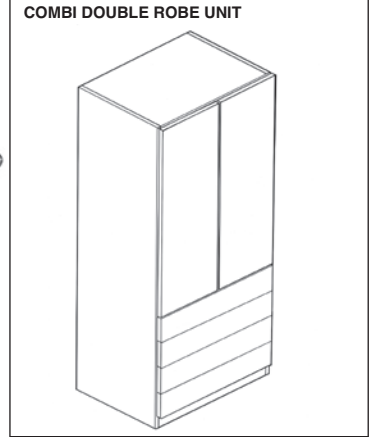

## COMBI ROBE UNIT. ASSEMBLY INSTRUCTIONS

For more information on product go to: [www.jjoplc.com](http://www.jjoplc.com)

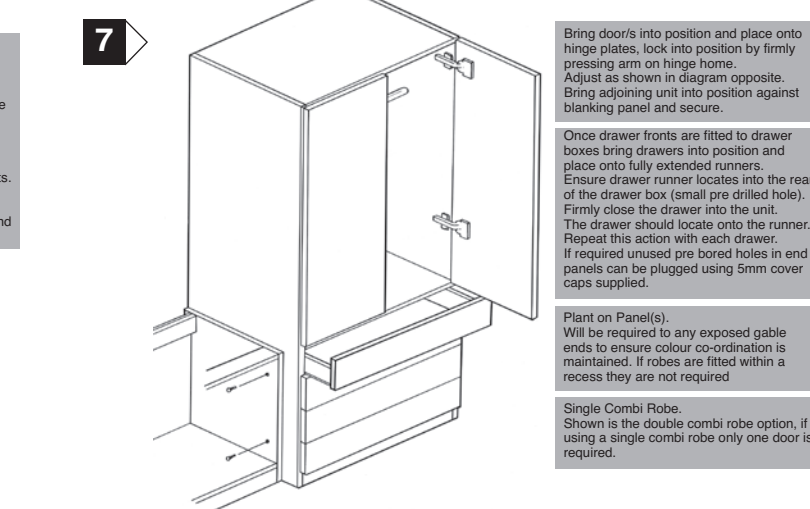
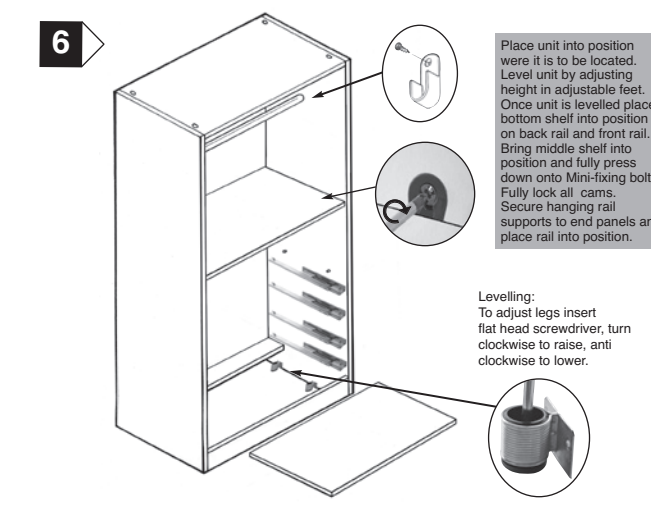
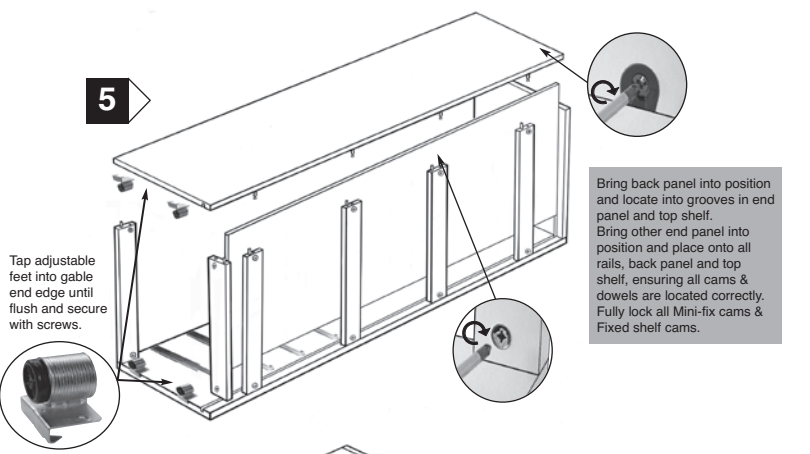
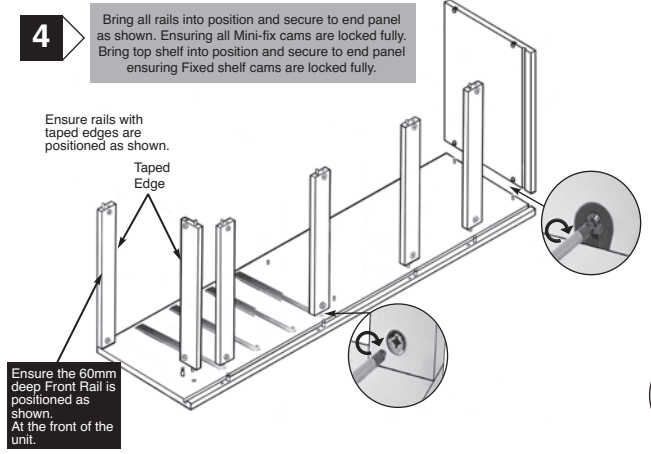
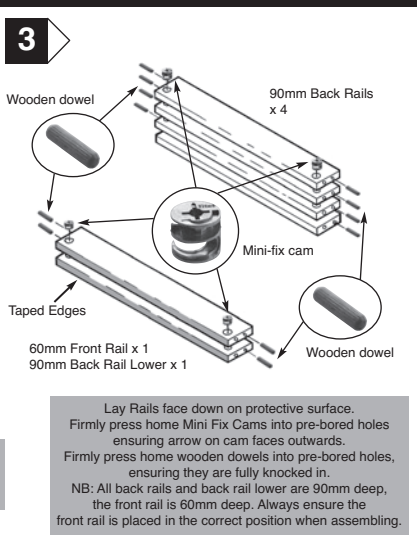
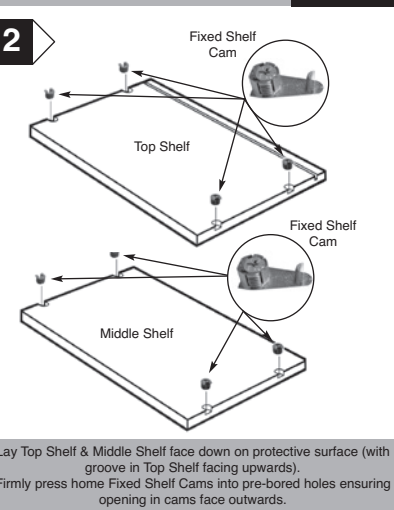
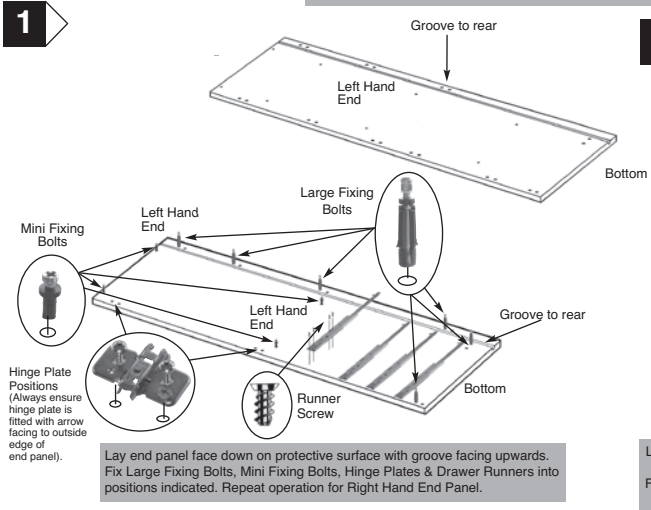



Please examine these drawings very carefully prior to assembly to determine the correct positions for hardware. Failure to do so could result in incorrect fitting or even damage to the items. Do not dispose of any packaging until you have checked the contents and completed assembly. Please check all panels for defects or damage, prior to installation.

#### CONTENTS CHECK LIST



#### DOORS

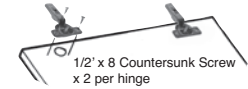

#### CLIP-ON HINGE ADJUSTMENT

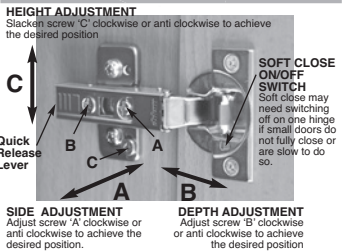

#### FIXING DRAWER FRONT TO DRAWER BOX

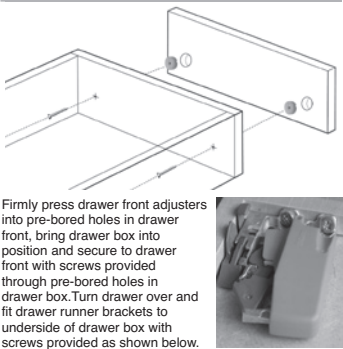

It is recommended that door/s and adjustable shelves should only be fitted once units have been installed.

## HOLCOMBE BEDROOM FURNITURE

Note: End panels are handed, right or left, when assembling groove in panels should always face to rear.

### GREY TEXTILE DRAWER SYSTEM

#### COMBI DOUBLE ROBE UNIT

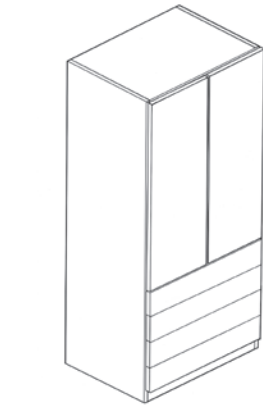

#### Hardware Fixing Positions

A = Hinge Plate Positions  
B = Large Fixing Bolt Positions  
C = Wooden Dowels  
D = Mini Fixing Bolt Positions

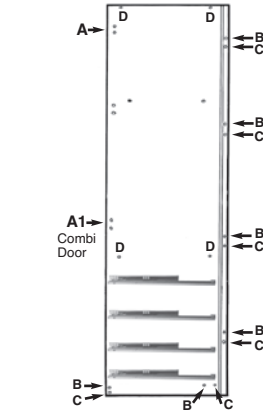

#### COMBI ROBE UNIT

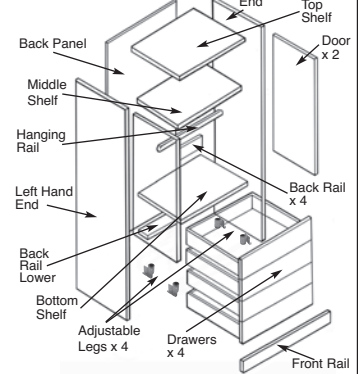

## COMBI ROBE UNIT. ASSEMBLY INSTRUCTIONS

For more information on product go to: [www.jjoplc.com](http://www.jjoplc.com)

1

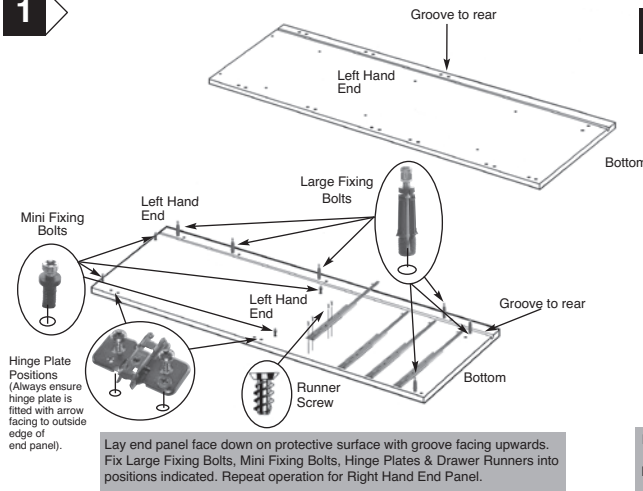

2

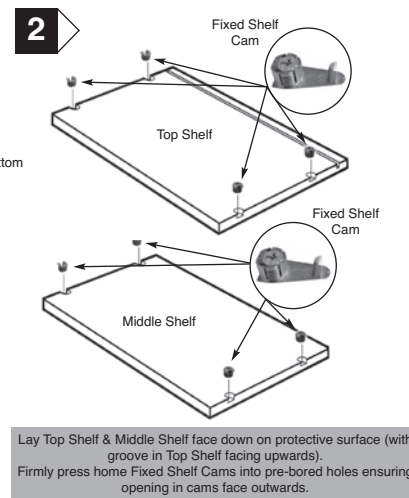

3

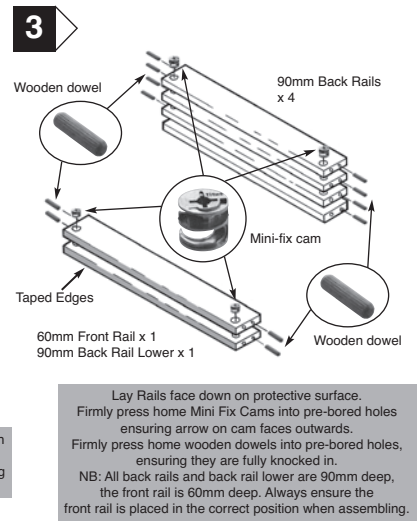

4

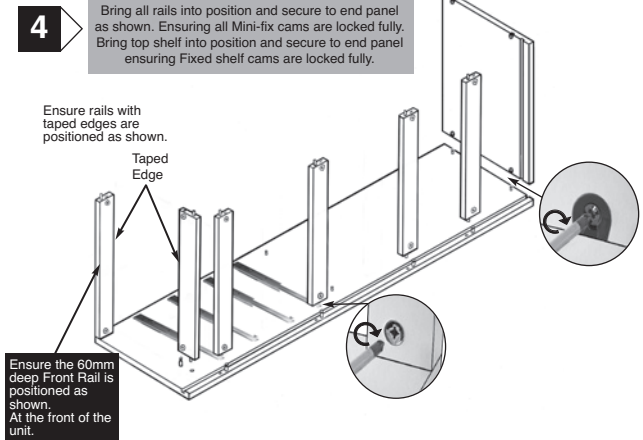

5

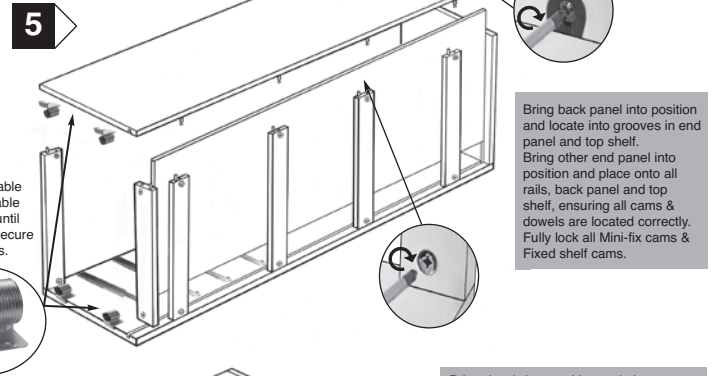

6

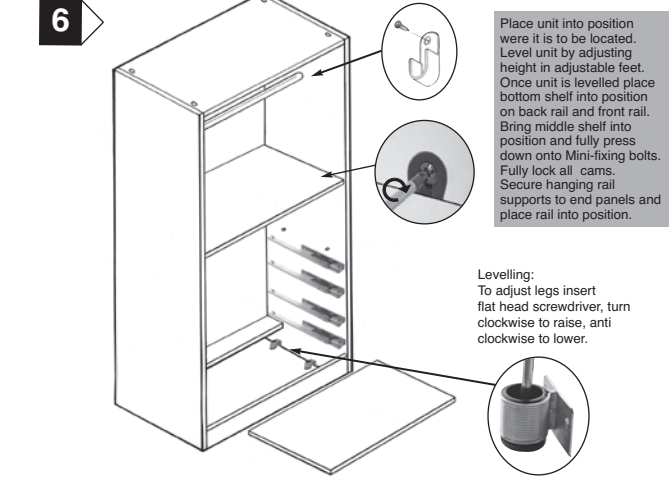

7

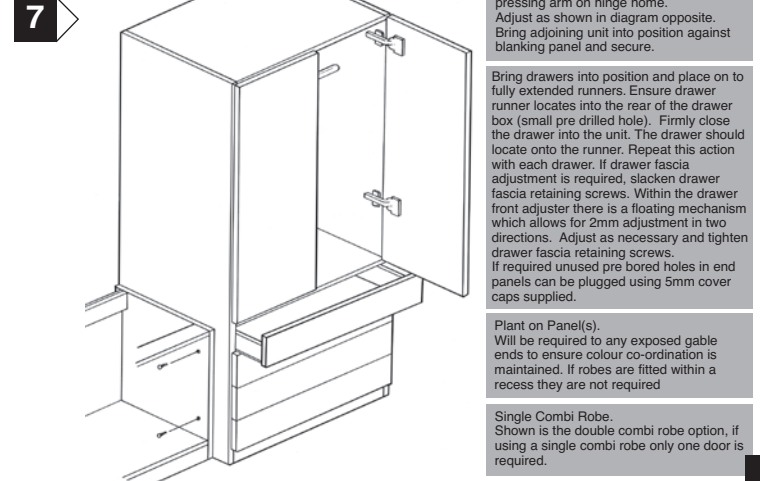

**WARNING!** Due to the size and weight of this unit we recommend that two people are used for the assembly and installation.

Please examine these drawings very carefully prior to assembly to determine the correct positions for hardware. Failure to do so could result in incorrect fitting or even damage to the items. Do not dispose of any packaging until you have checked the contents and completed assembly. Please check all panels for defects or damage, prior to installation.

**CONTENTS CHECK LIST**



**DOORS**



**CLIP-ON HINGE ADJUSTMENT**

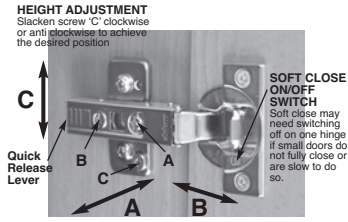

**HEIGHT ADJUSTMENT**  
Slacken screw 'C' clockwise or anti clockwise to achieve the desired position.

**SOFT CLOSE ON/OFF SWITCH**  
Soft close may need switching off on one hinge if small doors do not fully close or are slow to do so.

**SIDE ADJUSTMENT**  
Adjust screw 'A' clockwise or anti clockwise to achieve the desired position.

**DEPTH ADJUSTMENT**  
Adjust screw 'B' clockwise or anti clockwise to achieve the desired position.

**Adjustable Leg Adjustment**

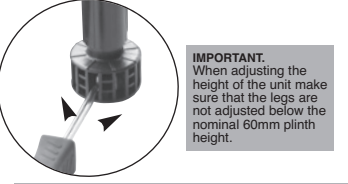

It is recommended that door/s and adjustable shelves should only be fitted once units have been installed.

**HOLCOMBE BEDROOM FURNITURE**

Note: End panels are handed, right or left, when assembling groove in panels should always face to rear.

**DIAGONAL CORNER ROBE UNIT**

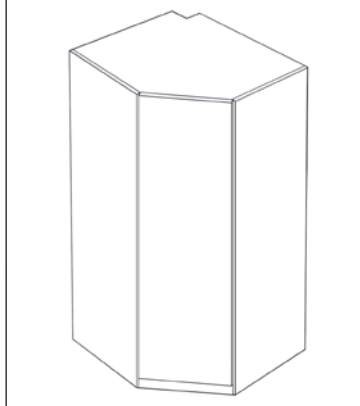

**Hardware Fixing Positions**

A = Hinge Plate Positions  
B = Large Fixing Bolt Positions  
C = Wooden Dowels  
D = Mini Fixing Bolt Positions

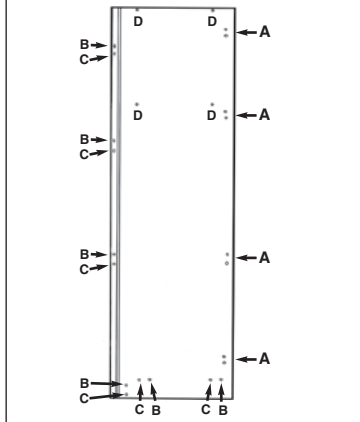

**DIAGONAL CORNER ROBE UNIT**

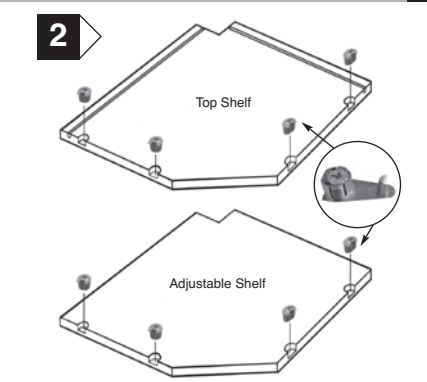
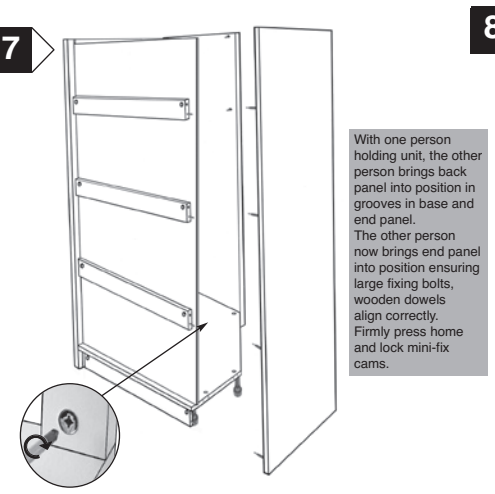
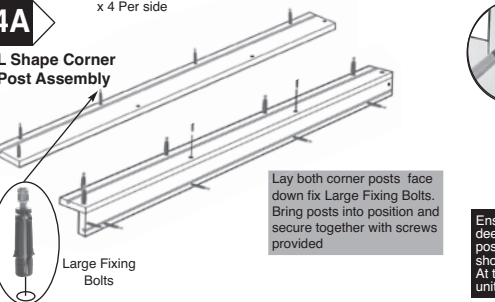
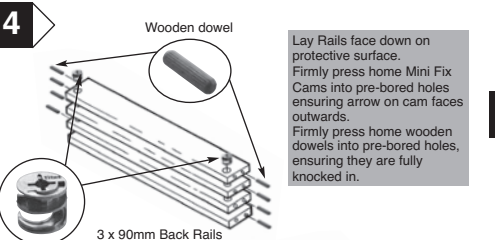
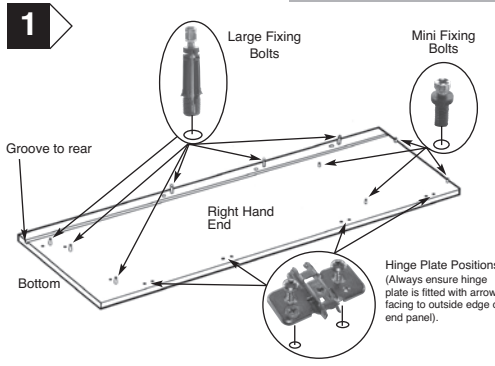
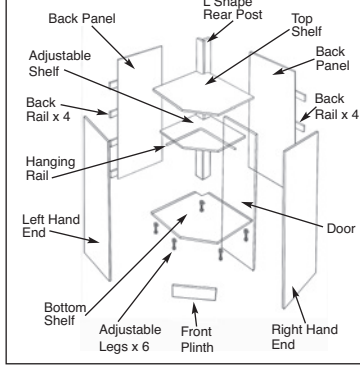

Lay Top Shelf & Adjustable Shelf face down on protective surface (with groove in Top Shelf facing upwards). Firmly press home Fixed Shelf Cams into pre-bored holes ensuring opening in cams face outwards. As an option additional adjustable shelves can be purchased to increase storage capacity. Assembly & installation is as shown in this instruction.

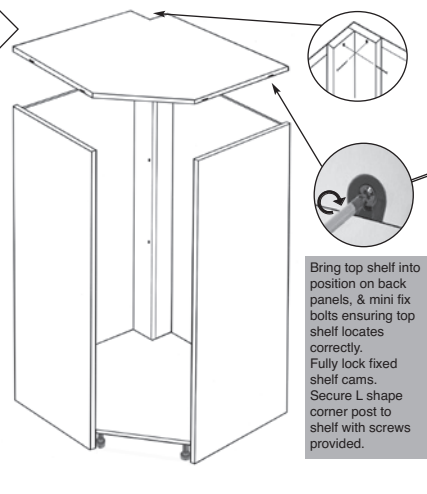
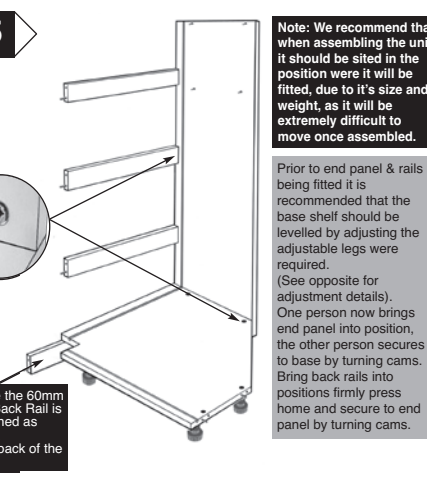

For more information on product go to: [www.jjoplc.com](http://www.jjoplc.com)

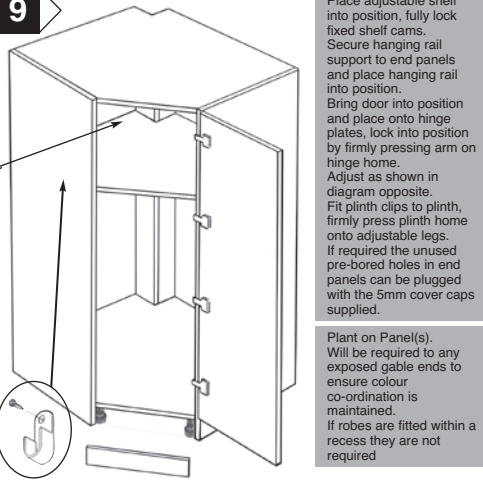
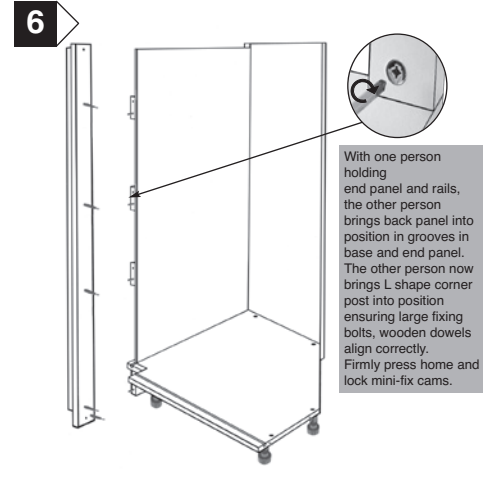
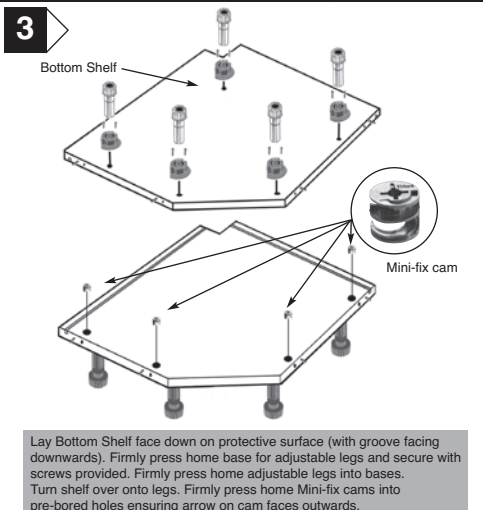



Please examine these drawings very carefully prior to assembly to determine the correct positions for hardware. Failure to do so could result in incorrect fitting or even damage to the items. Do not dispose of any packaging until you have checked the contents and completed assembly. Please check all panels for defects or damage, prior to installation.

#### CONTENTS CHECK LIST



#### DOORS

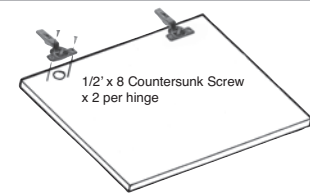

#### CLIP-ON HINGE ADJUSTMENT

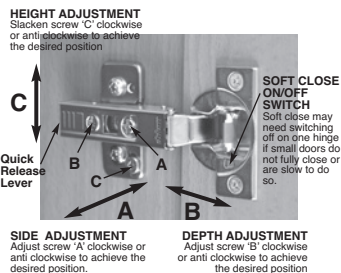

To avoid any surface damage when assembling units always ensure panels to be worked on are always placed onto a non abrasive protective surface.

It is recommended that door/s and adjustable shelves should only be fitted once units have been installed.

#### Robe Assembly - Upright Position

If ceiling height limitations exist, the robe can be assembled in an upright position. If this is the case it will require two people to complete assembly.

## HOLCOMBE BEDROOM FURNITURE

Note: End panels are handed, right or left, when assembling groove in panels should always face to rear.

#### SINGLE/DOUBLE ROBE UNITS

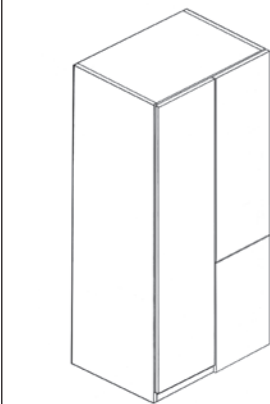

#### Hardware Fixing Positions

A = Hinge Plate Positions  
B = Large Fixing Bolt Positions  
C = Wooden Dowels  
D = Mini Fixing Bolt Positions

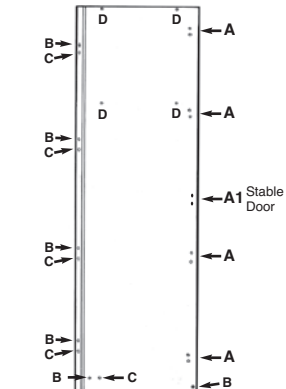

#### DOUBLE ROBE UNIT

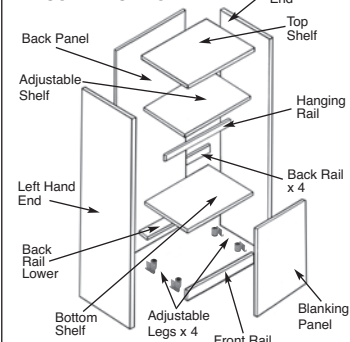

1

Lay end panel face down on protective surface with groove facing upwards. Fix Large Fixing Bolts, Mini Fix Bolts & Hinge Plates into positions indicated. Repeat operation for Left Hand End Panel.

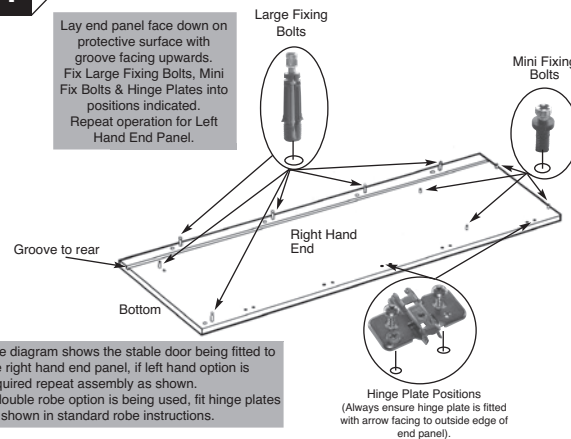

The diagram shows the stable door being fitted to the right hand end panel, if left hand option is required repeat assembly as shown. If double robe option is being used, fit hinge plates as shown in standard robe instructions.

4

Bring all rails into position and secure to end panel as shown. Ensuring all Mini-fix cams are locked fully. Bring top shelf into position and secure to end panel ensuring Fixed shelf cams are locked fully.

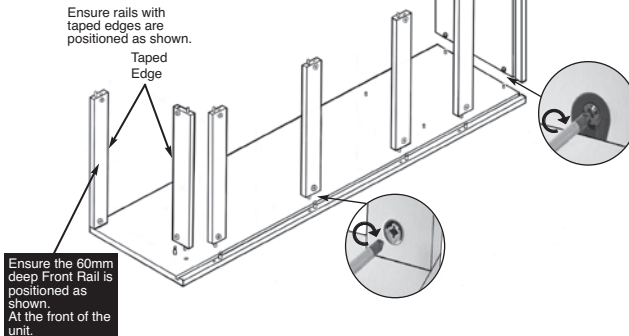

6

Place unit into position where it is to be located. Level unit by adjusting height in adjustable feet. Once unit is levelled place bottom shelf into position on back rail and front rail. Bring adjustable shelf into position and fully press down onto Mini-fixing bolts. Fully lock all Fixed shelf cams.

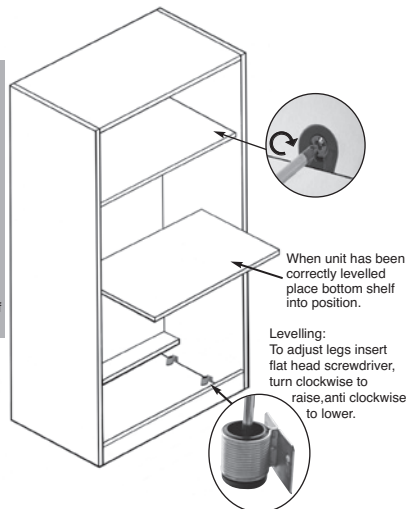

## ASSEMBLY INSTRUCTIONS

2

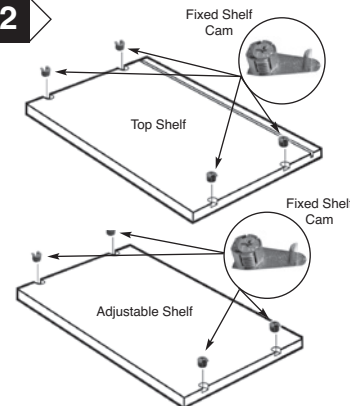

Lay Top Shelf & Adjustable Shelf face down on protective surface (with groove in Top Shelf facing upwards). Firmly press home Fixed Shelf Cams into pre-bored holes ensuring opening in cams face outwards. As an option additional adjustable shelves can be purchased to increase storage capacity. Assembly & installation is as shown in this instruction.

5

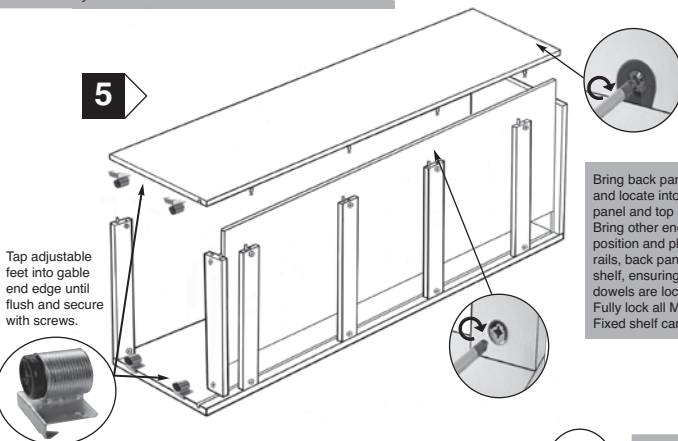

Bring back panel into position and locate into grooves in end panel and top shelf. Bring other end panel into position and place onto all rails, back panel and top shelf, ensuring all cams & dowels are located correctly. Fully lock all Mini-fix cams & Fixed shelf cams.

7

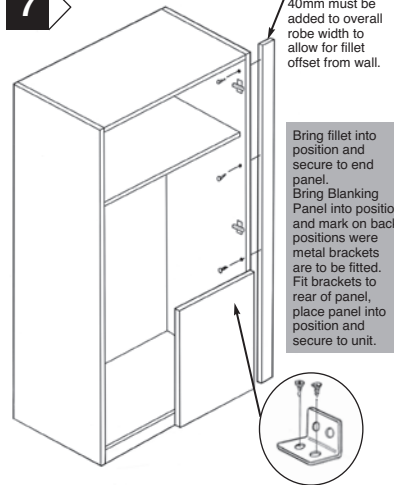

Please Note: An additional 40mm must be added to overall robe width to allow for fillet offset from wall.

Bring fillet into position and secure to end panel. Bring Blanking Panel into position and mark on back positions were metal brackets are to be fitted. Fit brackets to rear of panel, place panel into position and secure to unit.

8

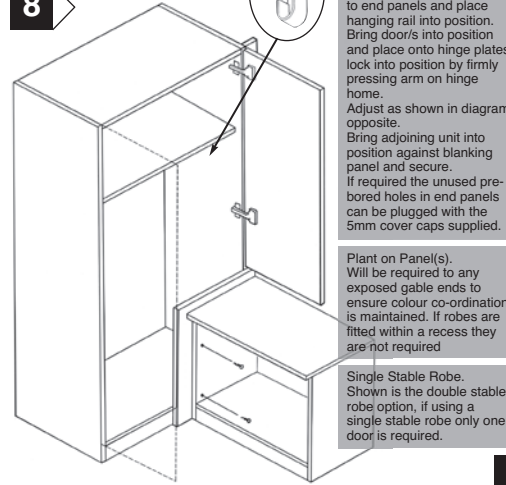

Once adjustable shelf has been placed into position, secure hanging rail support to end panels and place hanging rail into position. Bring door/s into position and place onto hinge plates, lock into position by firmly pressing arm on hinge home. Adjust as shown in diagram opposite. Bring adjoining unit into position against blanking panel and secure. If required the unused pre-bored holes in end panels can be plugged with the 5mm cover caps supplied.

Plant on Panel(s). Will be required to any exposed gable ends to ensure colour co-ordination is maintained. If robes are fitted within a recess they are not required.

Single Stable Robe. Shown is the double stable robe option, if using a single stable robe only one door is required.

For more information on product go to: [www.jjoplc.com](http://www.jjoplc.com)



Please examine these drawings very carefully prior to assembly to determine the correct positions for hardware. Failure to do so could result in incorrect fitting or even damage to the items. Do not dispose of any packaging until you have checked the contents and completed assembly. Please check all panels for defects or damage, prior to installation.

#### CONTENTS CHECK LIST

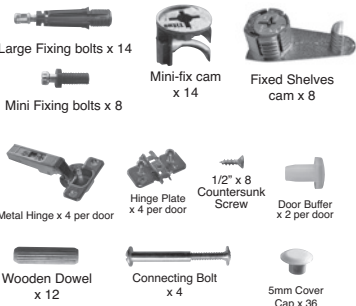

#### DOORS

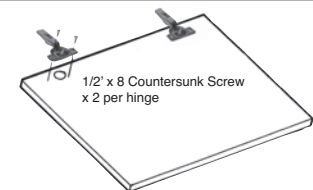

#### CLIP-ON HINGE ADJUSTMENT

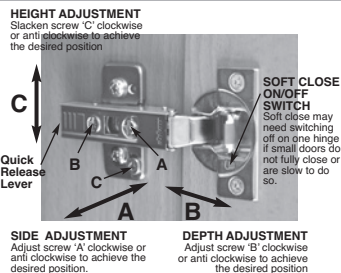

To avoid any surface damage when assembling units always ensure panels to be worked on are always placed onto a non abrasive protective surface.

It is recommended that door/s and adjustable shelves should only be fitted once units have been installed.

#### Robe Assembly - Upright Position

If ceiling height limitations exist, the robe can be assembled in an upright position. If this is the case it will require two people to complete assembly.

## HOLCOMBE BEDROOM FURNITURE

## ANGLED ROBE UNITS. ASSEMBLY INSTRUCTIONS

For more information on product go to: [www.jjoplc.com](http://www.jjoplc.com)

Note: End panels are handed, right or left, when assembling groove in panels should always face rear.

#### SINGLE ANGLED ROBE UNITS

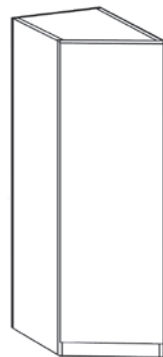

#### Hardware Fixing Positions

A = Hinge Plate Positions  
B = Large Fixing Bolt Positions  
C = Wooden Dowels  
D = Mini Fixing Bolt Positions

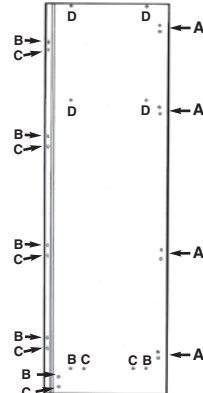

#### ANGLED ROBE UNIT

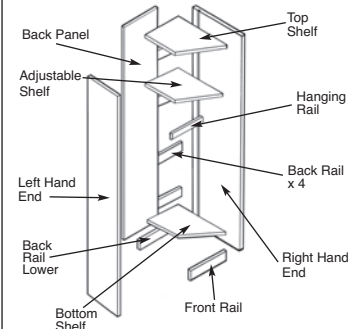

1

Lay Right Hand End Panel face down on protective surface with groove facing upwards. Fix Large Fixing Bolts, Mini Fix Bolts & Hinge Plates into positions indicated. Repeat operation for Left Hand End Panel. NB: No hinge plates are to be fitted to Left Hand End Panel.

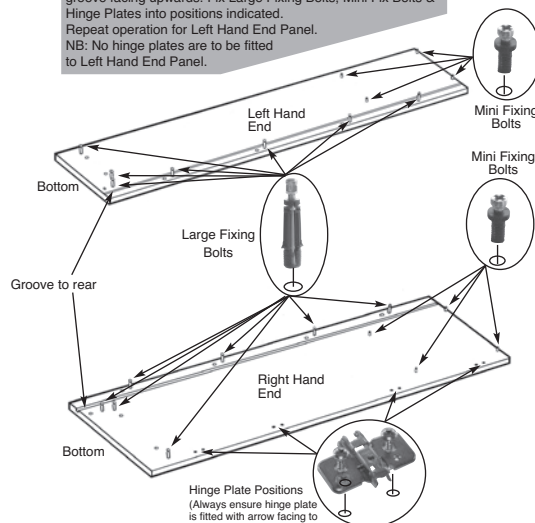

2

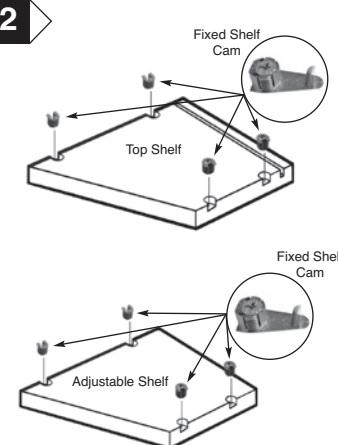

Lay Top Shelf face down on protective surface (with groove in Top Shelf facing upwards). Lay Adjustable Shelf face down on protective surface, firmly press home Fixed Shelf Cams into pre-bored holes in both shelves ensuring opening in cams face outwards.

3

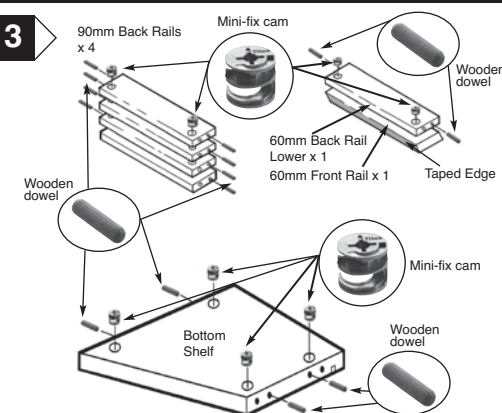

Lay Rails face down on protective surface. Firmly press home Mini Fix Cams into pre-bored holes ensuring arrow on cam faces outwards. Firmly press home wooden dowels into pre-bored holes, ensuring they are fully knocked in. NB: All back rails are 90mm deep. The front rail and back rail lower are 60mm deep. Always ensure the front rail is placed in the correct position when assembling. Lay Bottom Shelf face down on protective surface (with groove facing downwards). Firmly press home Mini Fix Cams into pre-bored holes ensuring arrow on cam faces outwards. Firmly press home wooden dowels into pre-bored holes, ensuring they are fully knocked in.

4

Bring bottom shelf and all rails into position and secure to end panel as shown. Ensuring all Mini-fix cams are locked fully. Bring top shelf into position and secure to end panel ensuring Fixed shelf cams are locked fully.

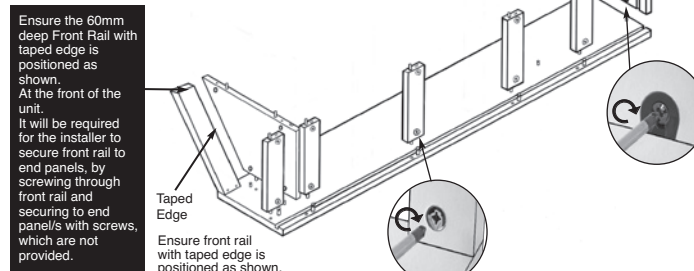

5

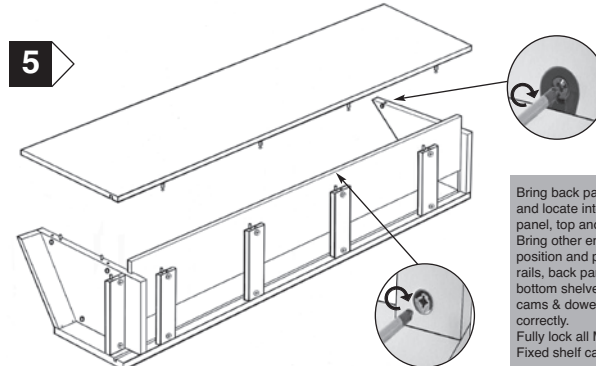

Bring back panel into position and locate into grooves in end panel, top and bottom shelves. Bring other end panel into position and place onto all rails, back panel, top and bottom shelves, ensuring all cams & dowels are located correctly. Fully lock all Mini-fix cams & Fixed shelf cams.

6

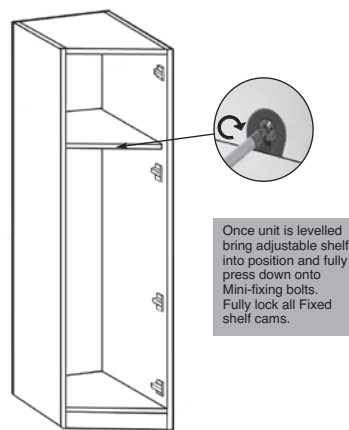

Once unit is levelled bring adjustable shelf into position and fully press down onto Mini-fixing bolts. Fully lock all Fixed shelf cams.

7

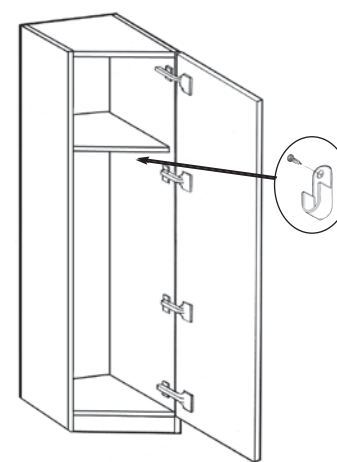

Once adjustable shelf has been placed into position, secure hanging rail support to end panels and place hanging rail into position. Bring door into position and place onto hinge plates, lock into position by firmly pressing arm on hinge home. Adjust as shown in diagram opposite. If required the unused pre-bored holes in end panels can be plugged with the 5mm cover caps supplied.

Plant on Panel(s). Will be required to any exposed gable ends to ensure colour co-ordination is maintained. If robes are fitted within a recess they are not required.

Please examine these drawings very carefully prior to assembly to determine the correct positions for hardware. Failure to do so could result in incorrect fitting or even damage to the items. Do not dispose of any packaging until you have checked the contents and completed assembly. Please check all panels for defects or damage, prior to installation.

#### CONTENTS CHECK LIST

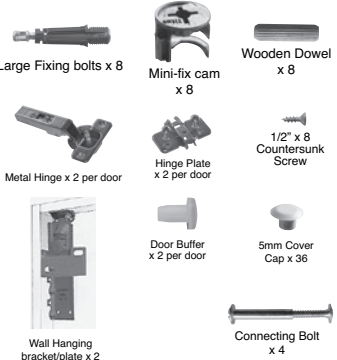

#### DOORS

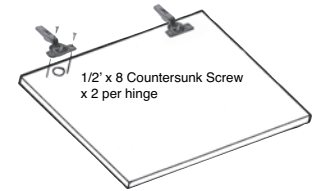

#### CLIP-ON HINGE ADJUSTMENT

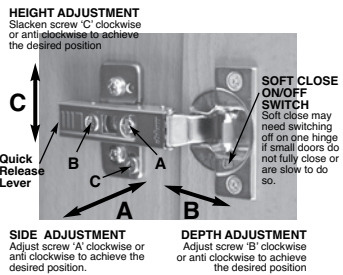

To avoid any surface damage when assembling units always ensure panels to be worked on are always placed onto a non abrasive protective surface.

It is recommended that door/s and adjustable shelves should only be fitted once units have been installed.

## HOLCOMBE BEDROOM FURNITURE

Note: End panels are handed, right or left, when assembling groove in panels should always face rear.

Instructions show assembly for double bridging cupboard. Assembly for single bridging cupboard is the same apart from only using one door.

#### SINGLE/DOUBLE BRIDGING UNITS

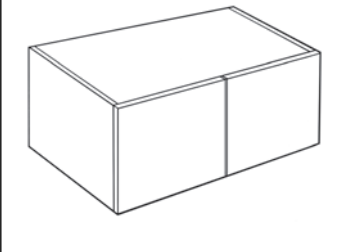

#### DOUBLE BRIDGING UNIT

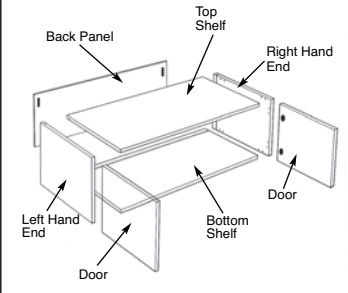

#### WALL HANGING BRACKET ADJUSTMENT

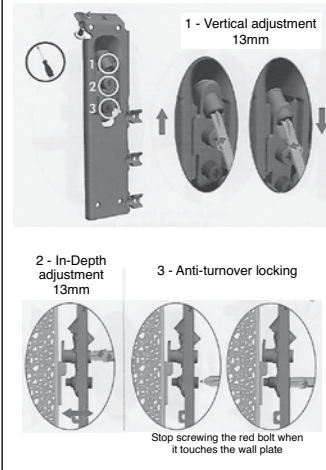

1

Lay end panel face down on protective surface with groove facing upwards. Fix Large Fixing Bolts & Hinge Plates into positions indicated. Repeat operation for Left Hand End Panel.

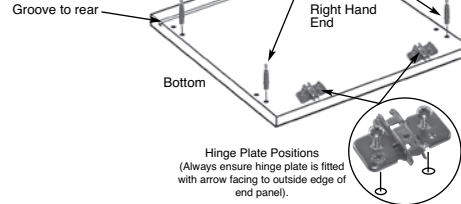

4

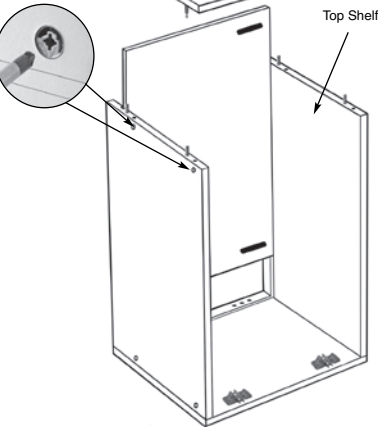

Bring back panel into position and locate into grooves in end panel and top & bottom shelves. Ensuring cut out's in back panel face top shelf. Bring other end panel into position and place onto back panel and top & bottom shelves, ensuring all cams & dowels are located correctly. Fully lock all Mini-fix cams.

6

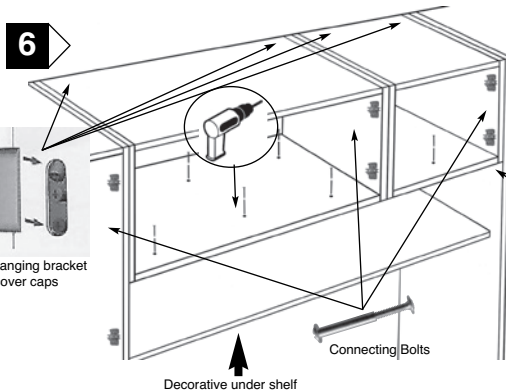

## SINGLE & DOUBLE BRIDGING CUPBOARDS. ASSEMBLY INSTRUCTIONS

2

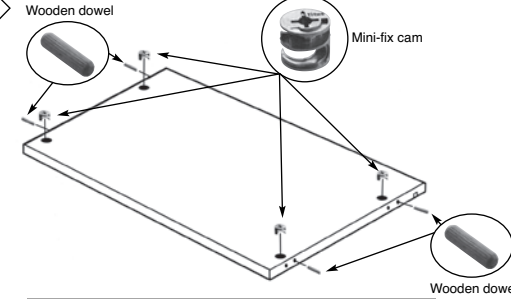

Lay Top Shelf & Bottom Shelf face down on protective surface (with groove facing downwards). Firmly press home Mini-fix Cams into pre-bored holes ensuring arrow on cams face outwards. Repeat operation for other shelf. Firmly press home wooden dowels into pre-bored holes, ensuring they are fully knocked in.

5

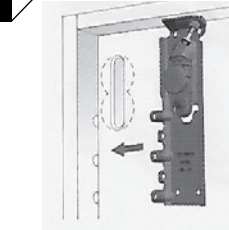

5A



Bring unit into upright position, ensuring cut out's in back panel are facing upwards, secure wall hanging bracket to end panels ensuring arms in bracket are fully pressed home into pre-bored holes in end panels. Secure bracket to top shelf with pre-installed screws.

Secure bridging unit/s to robes with connecting bolts, pre-bore holes in end panels in suitable positions and secure bolts. Fit hanging bracket cover caps into holes in back panel/s. With bridging units secured in position. If required an decorative under shelf can be fitted. Pre-bore holes in bottom shelf/s and secure with screws of the correct length. (Not supplied).

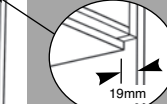

An allowance of 19mm should be left from front of the end panel to front of decorative under shelf, when fitting OPTIONAL decorative pelmet.

3

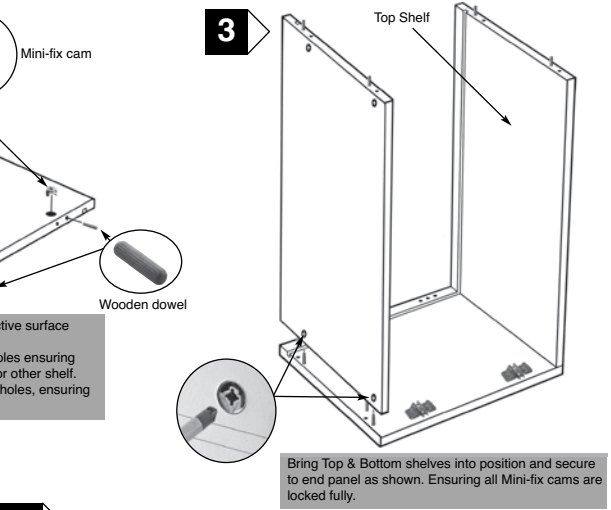

#### Wall Hanging Plate Positioning

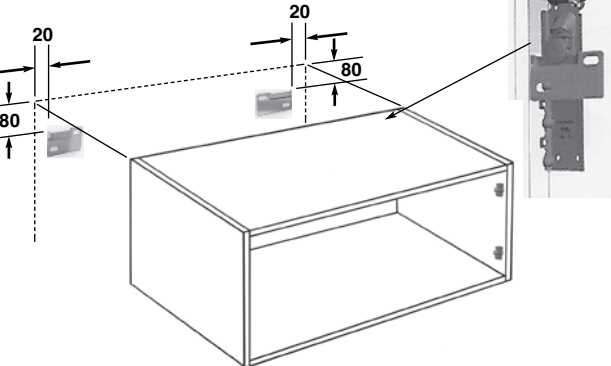

Fix wall hanging plates to walls in positions shown, using suitable screws, these are not provided because of differing wall construction. Bridging cupboards can be sited in multiple locations, if they are to be sited between robes always ensure robes are correctly levelled in all plains prior to bridging cupboard/s being installed. For adjustment of wall hanging brackets see diagrams opposite.

7

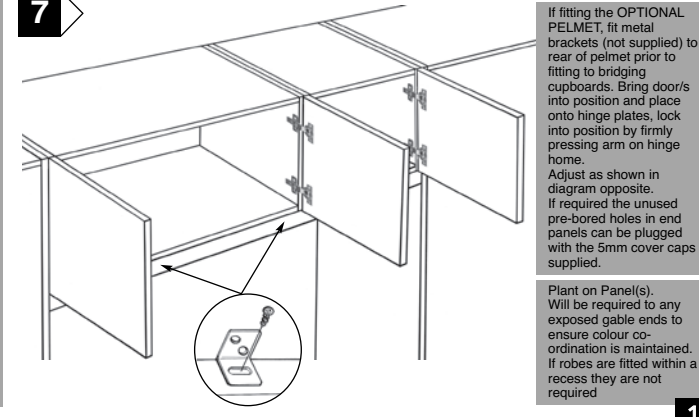

If fitting the OPTIONAL PELMET, fit metal brackets (not supplied) to rear of pelmet prior to fitting to bridging cupboards. Bring door/s into position and place onto hinge plates, lock into position by firmly pressing arm on hinge home. Adjust as shown in diagram opposite. If required the unused pre-bored holes in end panels can be plugged with the 5mm cover caps supplied.

Plant on Panel(s). Will be required to any exposed gable ends to ensure colour co-ordination is maintained. If robes are fitted within a recess they are not required



Please examine these drawings very carefully prior to assembly to determine the correct positions for hardware. Failure to do so could result in incorrect fitting or even damage to the items. Do not dispose of any packaging until you have checked the contents and completed assembly. Please check all panels for defects or damage, prior to installation.

#### CONTENTS CHECK LIST

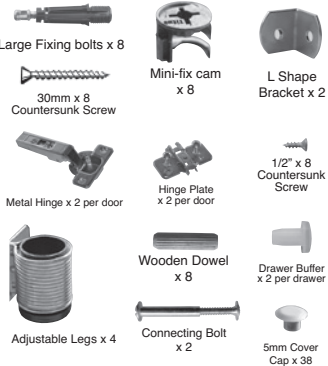

#### DRAWER BRACKET



#### FIXING DRAWER BRACKET TO DRAWER FRONT

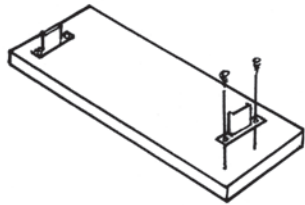

To avoid any surface damage when assembling units always ensure panels to be worked on are always placed onto a non abrasive protective surface.

It is recommended that drawers should only be fitted once units have been installed.

## HOLCOMBE BEDROOM FURNITURE

## SINGLE & DOUBLE DRAWER CHESTS. BEDSIDE/STANDARD HEIGHT.

For more information on product go to: [www.jjoplc.com](http://www.jjoplc.com)

Note: End panels are handed, right or left, when assembling groove in panels should always face to rear.

### ANTARO DRAWER SYSTEM

#### SINGLE/DOUBLE DRAWER CHESTS BEDSIDE/STANDARD HEIGHT

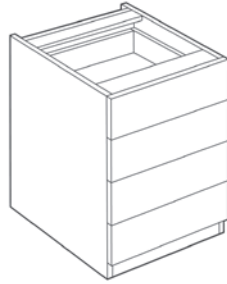

#### SINGLE/DOUBLE DRAWER CHESTS BEDSIDE/STANDARD HEIGHT

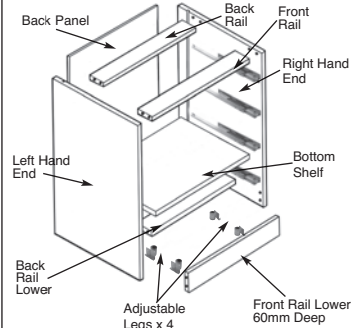

1

Lay end panels face down on protective surface with groove facing upwards. Fix Large Fixing Bolts into positions indicated. Bring Drawer runners into position and fix to end panels into pre-bored holes with runner screws. Repeat operation for Left hand end panel.

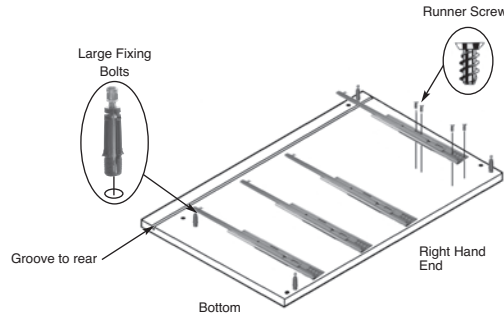

3

Bring all rails into position and secure to end panel as shown. Ensuring all Mini-fix cams are locked fully. Bring left hand end panel into position and secure to rails ensuring Mini-fix cams are locked fully.

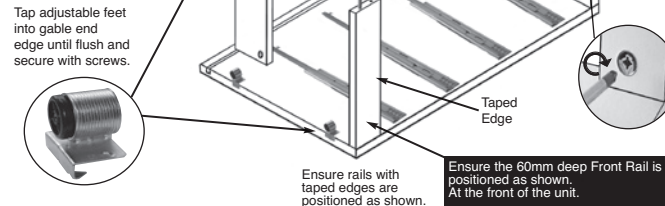

2

Lay Rails face down on protective surface. Firmly press home Mini Fix Cams into pre-bored holes ensuring arrow on cam faces outwards. Firmly press home wooden dowels into pre-bored holes, ensuring they are fully knocked in. NB: Back rail, front rail and back rail lower are 90mm deep, the front rail lower is 60mm deep. Always ensure the front rail is placed in the correct position when assembling.

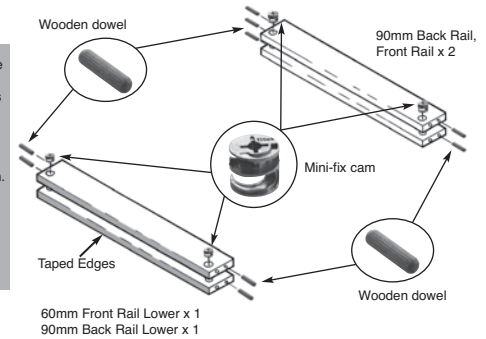

4

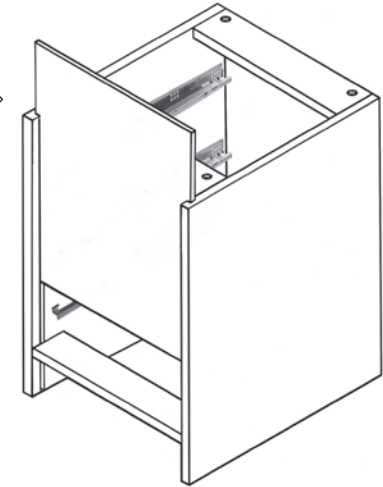

5

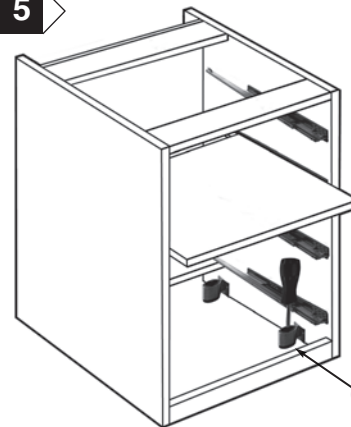

Place unit into position where it is to be located. Level unit by adjusting height in adjustable feet. Once unit is levelled place bottom shelf into position on back rail and front rail.



Levelling: To adjust legs insert flat head screwdriver, turn clockwise to raise, anti clockwise to lower.

6

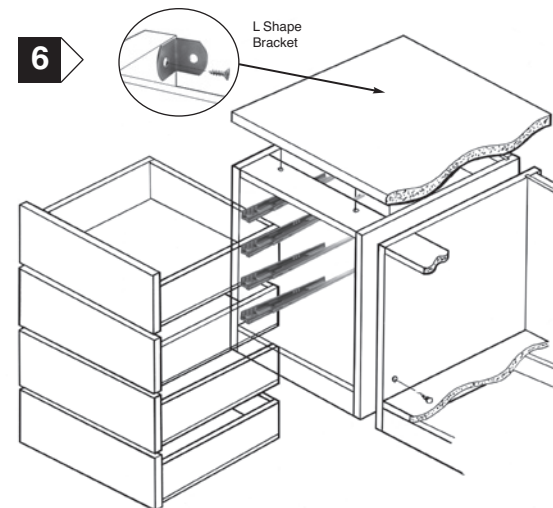

2 x 'L' shaped brackets are supplied for securing unit to wall or securing worktop to unit. If using brackets to secure worktop these will be placed in front of back panel. If using brackets to secure to wall position as indicated. Screws cannot be provided for securing to wall due to differing wall constructions.

Worktop can be secured to unit using 2 x 30mm screws provided. Prior to fitting it will be required for installer to drill holes in front rail where required. Bring screws into position and secure worktop. If unit is to be secured to an adjacent unit, 2 x connecting bolts are supplied. It is left for installer to decide on position and securing of connecting bolts.

Once drawer fronts are fitted to drawer boxes bring drawers into position and place onto fully extended runners. Ensure drawer runner locates into the rear of the drawer box (small pre drilled hole). Firmly close the drawer into the unit. The drawer should locate onto the runner. Repeat this action with each drawer. If required unused pre bored holes in end panels can be plugged using 5mm cover caps supplied.

Plant on Panel(s). Will be required to any exposed gable end(s) to ensure colour co-ordination maintained. Additional dimensional width of chest tops will be required to cover plant on gable end(s).



Please examine these drawings very carefully prior to assembly to determine the correct positions for hardware. Failure to do so could result in incorrect fitting or even damage to the items. Do not dispose of any packaging until you have checked the contents and completed assembly. Please check all panels for defects or damage, prior to installation.

#### CONTENTS CHECK LIST

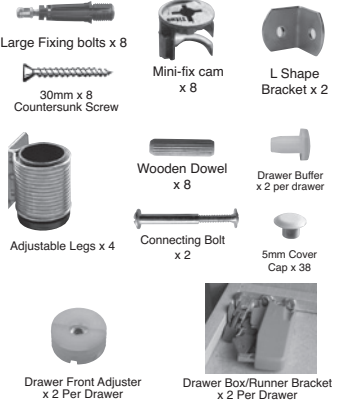

#### FIXING DRAWER FRONT TO DRAWER BOX

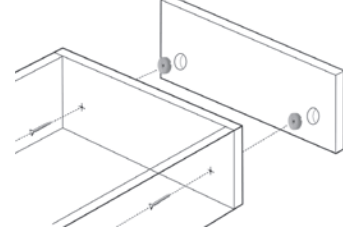

Firmly press drawer front adjusters into pre-bored holes in drawer front, bring drawer box into position and secure to drawer front with screws provided through pre-bored holes in drawer box. Turn drawer over and fit drawer runner brackets to underside of drawer box with screws provided as shown below.

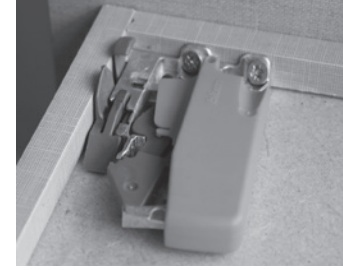

It is recommended that drawers should only be fitted once units have been installed.

## HOLCOMBE BEDROOM FURNITURE

Note: End panels are handed, right or left, when assembling groove in panels should always face rear.

### GREY TEXTILE DRAWER SYSTEM

#### SINGLE/DOUBLE DRAWER CHESTS BEDSIDE/STANDARD HEIGHT

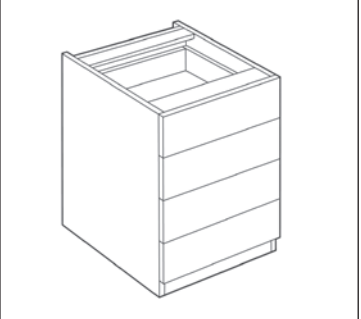

#### SINGLE/DOUBLE DRAWER CHESTS BEDSIDE/STANDARD HEIGHT

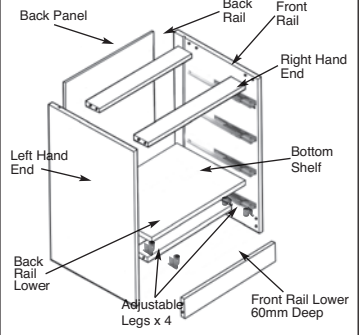

To avoid any surface damage when assembling units always ensure panels to be worked on are always placed onto a non abrasive protective surface.

1

Lay end panels face down on protective surface with groove facing upwards. Fix Large Fixing Bolts into positions indicated. Bring Drawer runners into position and fix to end panels into pre-bored holes with runner screws. Repeat operation for Left hand end panel.

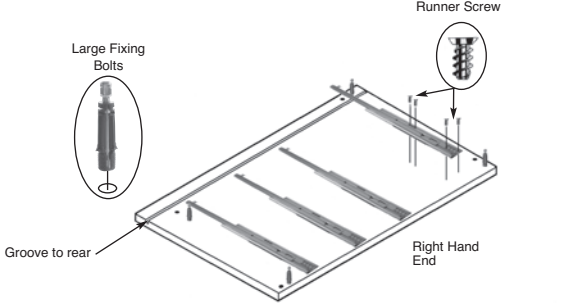

3

Bring all rails into position and secure to end panel as shown. Ensuring all Mini-fix cams are locked fully. Bring left hand end panel into position and secure to rails ensuring Mini-fix cams are locked fully.

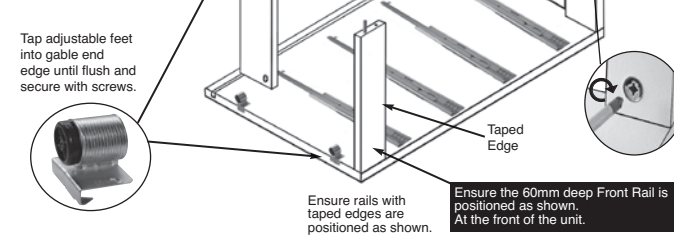

5

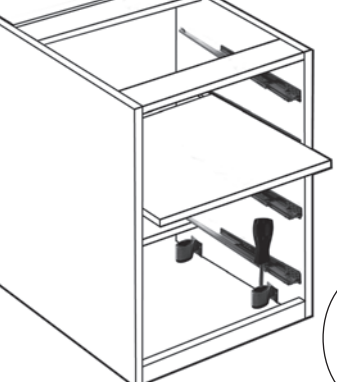

Place unit into position where it is to be located. Level unit by adjusting height in adjustable feet. Once unit is levelled place bottom shelf into position on back rail and front rail.

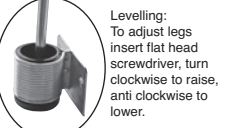

2

Lay Rails face down on protective surface. Firmly press home Mini Fix Cams into pre-bored holes ensuring arrow on cam faces outwards. Firmly press home wooden dowels into pre-bored holes, ensuring they are fully knocked in. NB: Back rail, front rail and back rail lower are 90mm deep, the front rail lower is 60mm deep. Always ensure the front rail is placed in the correct position when assembling.

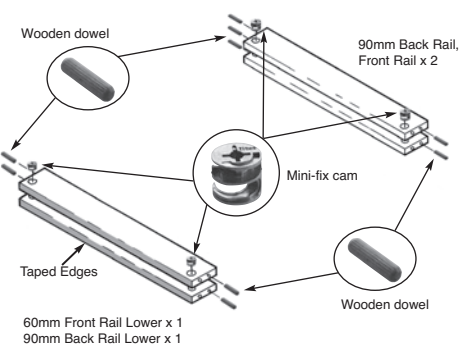

4

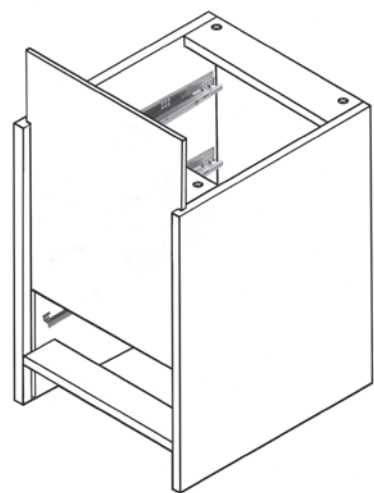

Bring unit into upright position and locate back panel into grooves in end panels.

6

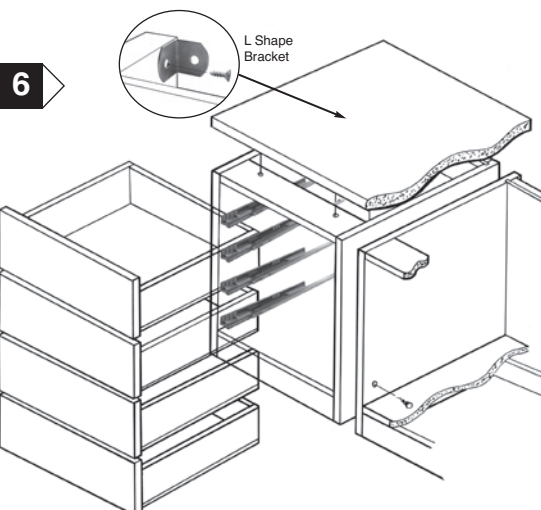

2 x 'L' shaped brackets are supplied for securing unit to wall or securing worktop to unit. If using brackets to secure worktop these will be placed in front of back panel. If using brackets to secure to wall position as indicated. Screws cannot be provided for securing to wall due to differing wall constructions.

Worktop can be secured to unit using 2 x 30mm screws provided. Prior to fitting it will be required for installer to drill holes in front rail where required. Bring screws into position and secure worktop. If unit is to be secured to an adjacent unit, 2 x connecting bolts are supplied. It is left for installer to decide on position and securing of connecting bolts.

Bring drawers into position and place on to fully extended runners. Ensure drawer runner locates into the rear of the drawer box (small pre drilled hole). Firmly close the drawer into the unit. The drawer should locate onto the runner. Repeat this action with each drawer. If drawer fascia adjustment is required, slacken drawer fascia retaining screws. Within the drawer front adjuster there is a floating mechanism which allows for 2mm adjustment in two directions. Adjust as necessary and tighten drawer fascia retaining screws. If required unused pre bored holes in end panels can be plugged using 5mm cover caps supplied.

Plant on Panel(s). Will be required to any exposed gable ends to ensure colour co-ordination is maintained. Additional dimensional width of chest tops will be required to cover plant on gable end(s).

Please examine these drawings very carefully prior to assembly to determine the correct positions for hardware. Failure to do so could result in incorrect fitting or even damage to the items. Do not dispose of any packaging until you have checked the contents and completed assembly. Please check all panels for defects or damage, prior to installation.

#### CONTENTS CHECK LIST



#### DRAWER BRACKET

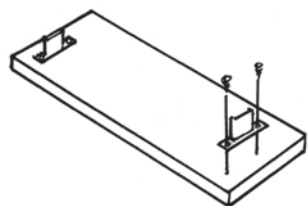

#### FIXING DRAWER BRACKET TO DRAWER FRONT

To avoid any surface damage when assembling units always ensure panels to be worked on are always placed onto a non abrasive protective surface.

It is recommended that drawers should only be fitted once units have been installed.

## HOLCOMBE BEDROOM FURNITURE

## TALL BOYS DRAWER CHESTS

For more information on product go to: [www.jjoplc.com](http://www.jjoplc.com)

Note: End panels are handed, right or left, when assembling groove in panels should always face rear.

### ANTARO DRAWER SYSTEM

#### TALL BOYS

There are multiple options of tall boys in various configurations. Shown is the 3 drawer pack. Assembly for other options is the same apart from the amount of drawers being fitted.

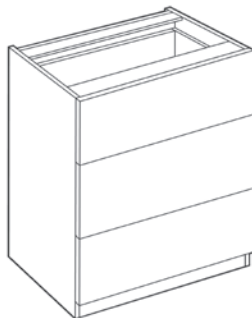

#### TALL BOYS

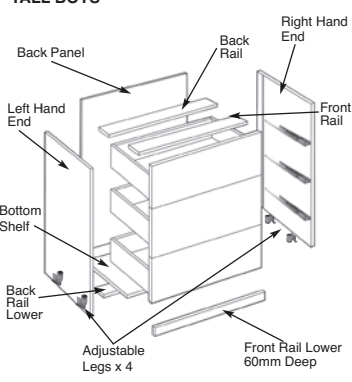

5

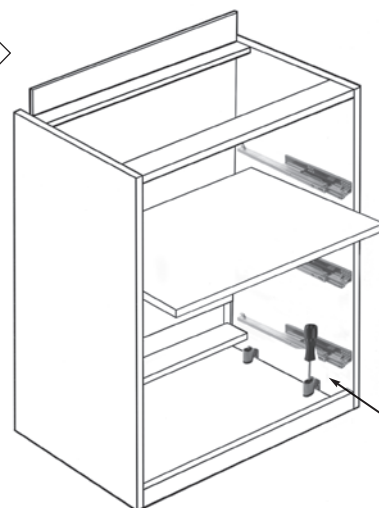

Place unit into position where it is to be located. Level unit by adjusting height in adjustable feet. Once unit is levelled place bottom shelf into position on back rail and front rail.



Levelling:  
To adjust legs insert flat head screwdriver, turn clockwise to raise, anti clockwise to lower.

1

Lay end panels face down on protective surface with groove facing upwards. Fix Large Fixing Bolts into positions indicated. Bring Drawer runners into position and fix to end panels into pre-bored holes with runner screws. Bring Drawer dampers into position on Left hand end panel and secure with screws provided. (Dampers can only be fitted to Left hand end panel).

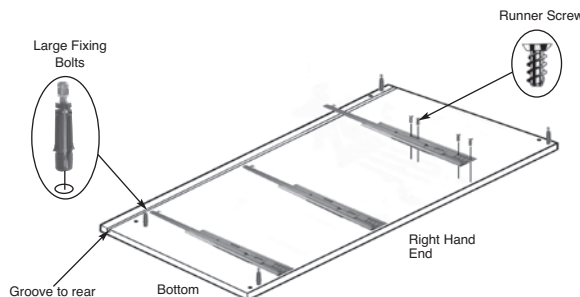

3

Bring all rails into position and secure to end panel as shown. Ensuring all Mini-fix cams are locked fully. Bring left hand end panel into position and secure to rails ensuring Mini-fix cams are locked fully.

Tap adjustable feet into gable end edge until flush and secure with screws.

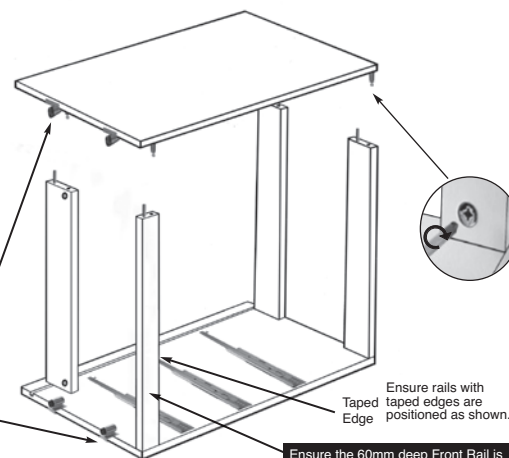

Ensure the 60mm deep Front Rail is positioned as shown. At the front of the unit.

2

Lay Rails face down on protective surface. Firmly press home Mini Fix Cams into pre-bored holes ensuring arrow on cam faces outwards. Firmly press home wooden dowels into pre-bored holes, ensuring they are fully knocked in. NB: Back rail, front rail and back rail lower are 90mm deep, the front rail lower is 60mm deep. Always ensure the front rail is placed in the correct position when assembling.

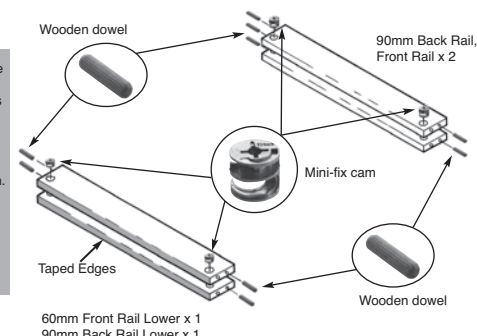

4

Bring unit into upright position and locate back panel into grooves in end panels.

6

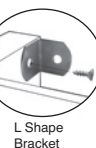
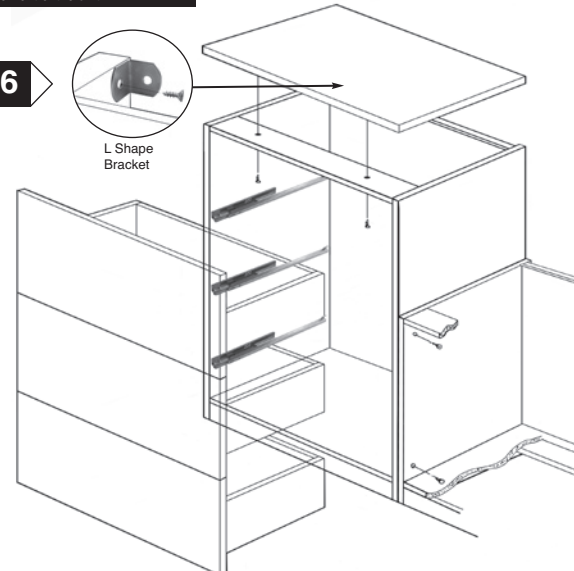

2 x 'L' shaped brackets are supplied for securing unit to wall or securing worktop to unit. If using brackets to secure worktop these will be placed in front of back panel. If using brackets to secure to wall position as indicated. Screws cannot be provided for securing to wall due to differing wall constructions.

Worktop can be secured to unit using 2 x 30mm screws provided. Prior to fitting it will be required for installer to drill holes in front rail where required. Bring screws into position and secure worktop. If unit is to be secured to an adjacent unit, 2 x connecting bolts are supplied. It is left for installer to decide on position and securing of connecting bolts.

Once drawer fronts are fitted to drawer boxes bring drawers into position and place onto fully extended runners. Ensure drawer runner locates into the rear of the drawer box (small pre drilled hole). Firmly close the drawer into the unit. The drawer should locate onto the runner. Repeat this action with each drawer. If required unused pre bored holes in end panels can be plugged using 5mm cover caps supplied.

Plant on Panel(s). Will be required to any exposed gable ends to ensure colour co-ordination is maintained. Additional dimensional width of chest tops will be required to cover plant on gable end(s).

Please examine these drawings very carefully prior to assembly to determine the correct positions for hardware. Failure to do so could result in incorrect fitting or even damage to the items. Do not dispose of any packaging until you have checked the contents and completed assembly. Please check all panels for defects or damage, prior to installation.

#### CONTENTS CHECK LIST

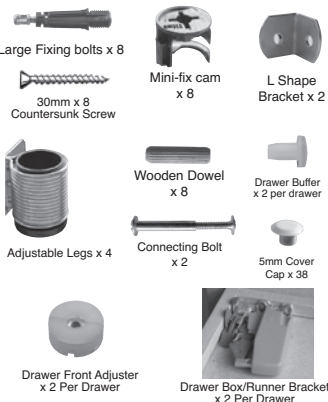

#### FIXING DRAWER FRONT TO DRAWER BOX

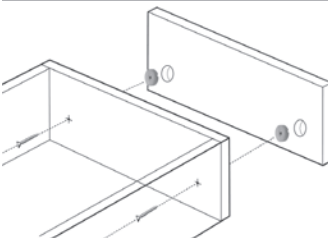

Firmly press drawer front adjusters into pre-bored holes in drawer front, bring drawer box into position and secure to drawer front with screws provided through pre-bored holes in drawer box. Turn drawer over and fit drawer runner brackets to underside of drawer box with screws provided as shown below.

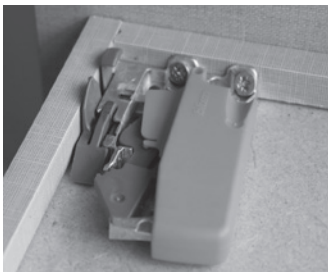

It is recommended that drawers should only be fitted once units have been installed.

## HOLCOMBE BEDROOM FURNITURE

Note: End panels are handed, right or left, when assembling groove in panels should always face to rear.

### GREY TEXTILE DRAWER SYSTEM

#### TALL BOYS

There are multiple options of tall boys in various configurations. Shown is the 3 drawer pack. Assembly for other options is the same apart from the amount of drawers being fitted.

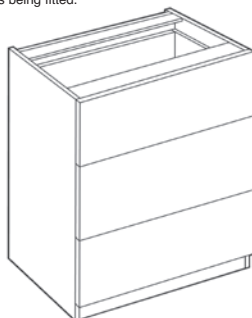

#### TALL BOYS

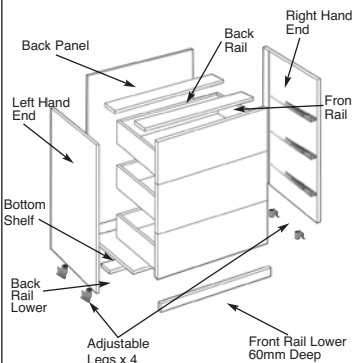

To avoid any surface damage when assembling units always ensure panels to be worked on are always placed onto a non abrasive protective surface.

1

Lay end panels face down on protective surface with groove facing upwards. Fix Large Fixing Bolts into positions indicated. Bring Drawer runners into position and fix to end panels into pre-bored holes with runner screws. Bring Drawer dampers into position on Left hand end panel and secure with screws provided. (Dampers can only be fitted to Left hand end panel).

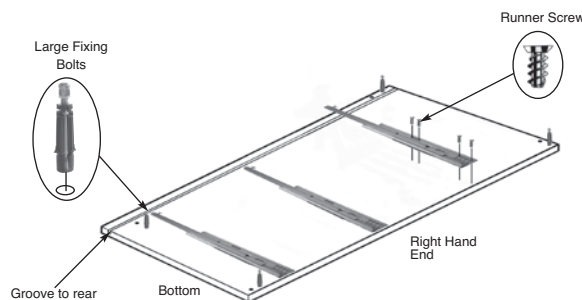

3

Bring all rails into position and secure to end panel as shown. Ensuring all Mini-fix cams are locked fully. Bring left hand end panel into position and secure to rails ensuring Mini-fix cams are locked fully.

Tap adjustable feet into gable end edge until flush and secure with screws.

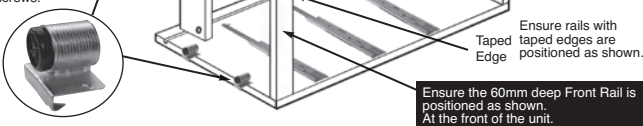

5

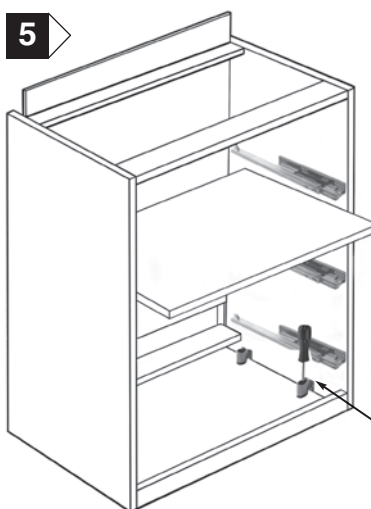

Place unit into position where it is to be located. Level unit by adjusting height in adjustable feet. Once unit is levelled place bottom shelf into position on back rail and front rail.

Levelling: To adjust legs insert flat head screwdriver, turn clockwise to raise, anti clockwise to lower.



## TALL BOYS DRAWER CHESTS

2

Lay Rails face down on protective surface. Firmly press home Mini Fix Cams into pre-bored holes ensuring arrow on cam faces outwards. Firmly press home wooden dowels into pre-bored holes, ensuring they are fully knocked in. NB: Back rail, front rail and back rail lower are 90mm deep, the front rail lower is 60mm deep. Always ensure the front rail is placed in the correct position when assembling.

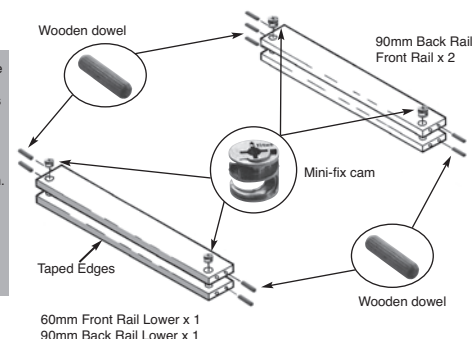

4

Bring unit into upright position and locate back panel into grooves in end panels.

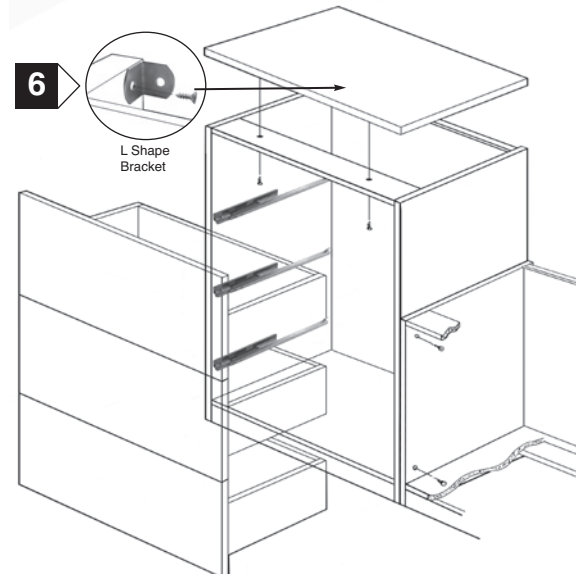

2 x 'L' shaped brackets are supplied for securing unit to wall or securing worktop to unit. If using brackets to secure worktop these will be placed in front of back panel. If using brackets to secure to wall position as indicated. Screws cannot be provided for securing to wall due to differing wall constructions.

Worktop can be secured to unit using 2 x 30mm screws provided. Prior to fitting it will be required for installer to drill holes in front rail where required. Bring screws into position and secure worktop. If unit is to be secured to an adjacent unit, 2 x connecting bolts are supplied. It is left for installer to decide on position and securing of connecting bolts.

Bring drawers into position and place on to fully extended runners. Ensure drawer runner locates into the rear of the drawer box (small pre drilled hole). Firmly close the drawer into the unit. The drawer should locate onto the runner. Repeat this action with each drawer. If drawer fascia adjustment is required, slacken drawer fascia retaining screws. Within the drawer front adjuster there is a floating mechanism which allows for 2mm adjustment in two directions. Adjust as necessary and tighten drawer fascia retaining screws. If required unused pre bored holes in end panels can be plugged using 5mm cover caps supplied.

Plant on Panel(s). Will be required to any exposed gable ends to ensure colour co-ordination is maintained. Additional dimensional width of chest tops will be required to cover plant on gable end(s).



Please examine these drawings very carefully prior to assembly to determine the correct positions for hardware. Failure to do so could result in incorrect fitting or even damage to the items. Do not dispose of any packaging until you have checked the contents and completed assembly. Please check all panels for defects or damage, prior to installation.

#### CONTENTS CHECK LIST

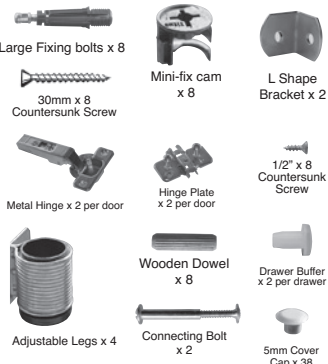

#### DRAWER BRACKET



#### FIXING DRAWER BRACKET TO DRAWER FRONT

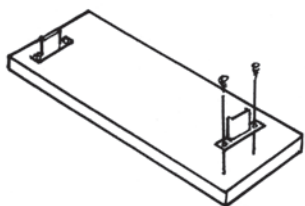

To avoid any surface damage when assembling units always ensure panels to be worked on are always placed onto a non abrasive protective surface.

It is recommended that drawers should only be fitted once units have been installed.

## HOLCOMBE BEDROOM FURNITURE

## SINGLE & DOUBLE DRAWER WINDOW SEATS

For more information on product go to: [www.jjoplc.com](http://www.jjoplc.com)

Note: End panels are handed, right or left, when assembling groove in panels should always face rear.

### ANTARO DRAWER SYSTEM

#### SINGLE/DOUBLE DRAWER WINDOW SEATS

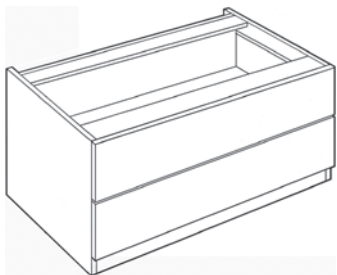

#### SINGLE/DOUBLE DRAWER WINDOW SEATS

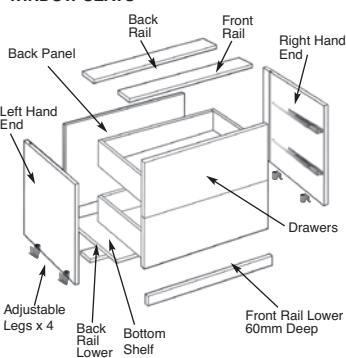

5

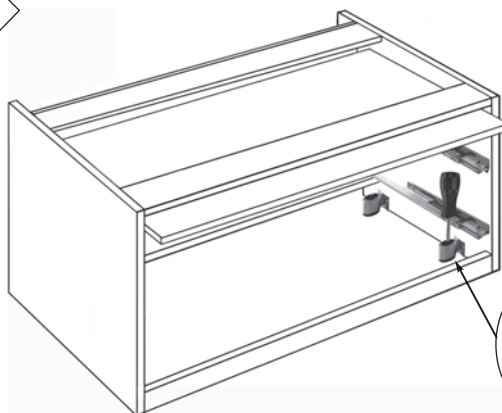

Place unit into position where it is to be located. Level unit by adjusting height in adjustable feet. Once unit is levelled place bottom shelf into position on back rail and front rail.



Levelling:  
To adjust legs insert flat head screwdriver, turn clockwise to raise, anti clockwise to lower.

1

Lay end panels face down on protective surface with groove facing upwards. Fix Large Fixing Bolts into positions indicated. Bring Drawer runners into position and fix to end panels into pre-bored holes with runner screws. Repeat operation for Left hand end panel.

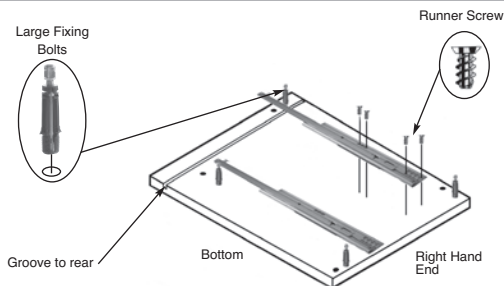

3

Bring all rails into position and secure to end panel as shown. Ensuring all Mini-fix cams are locked fully. Bring left hand end panel into position and secure to rails ensuring Mini-fix cams are locked fully.



Tap adjustable feet into gable end until flush and secure with screws.

Ensure rails with taped edges are positioned as shown.

Ensure the 60mm deep Front Rail is positioned as shown. At the front of the unit.

2

Lay Rails face down on protective surface. Firmly press home Mini Fix Cams into pre-bored holes ensuring arrow on cam faces outwards. Firmly press home wooden dowels into pre-bored holes, ensuring they are fully knocked in. NB: Back rail, front rail and back rail lower are 90mm deep, the front rail lower is 60mm deep. Always ensure the front rail is placed in the correct position when assembling.

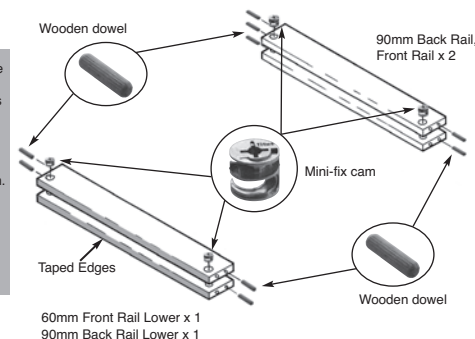

4

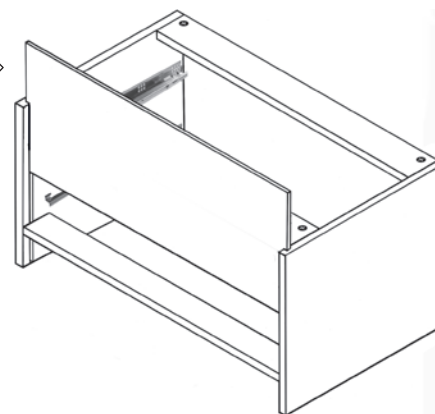

Bring unit into upright position and locate back panel into grooves in end panels.

6

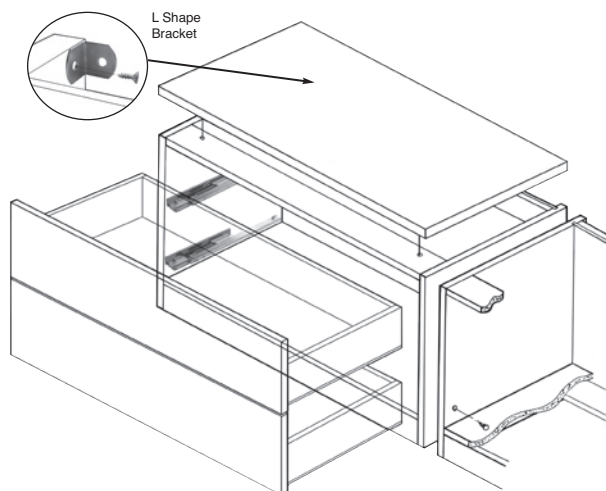

2 x 'L' shaped brackets are supplied for securing unit to wall or securing worktop to unit. If using brackets to secure worktop these will be placed in front of back panel. If using brackets to secure to wall position as indicated. Screws cannot be provided for securing to wall due to differing wall constructions.

Worktop can be secured to unit using 2 x 30mm screws provided. Prior to fitting it will be required for installer to drill holes in front rail where required. Bring screws into position and secure worktop. If unit is to be secured to an adjacent unit, 2 x connecting bolts are supplied. It is left for installer to decide on position and securing of connecting bolts.

Once drawer fronts are fitted to drawer boxes bring drawers into position and place onto fully extended runners. Ensure drawer runner locates into the rear of the drawer box (small pre drilled hole). Firmly close the drawer into the unit. The drawer should locate onto the runner. Repeat this action with each drawer. If required unused pre bored holes in end panels can be plugged using 5mm cover caps supplied.

Plant on Panel(s). Will be required to any exposed gable ends to ensure colour co-ordination is maintained. Additional dimensional width of chest tops will be required to cover plant on gable end(s).

Please examine these drawings very carefully prior to assembly to determine the correct positions for hardware. Failure to do so could result in incorrect fitting or even damage to the items. Do not dispose of any packaging until you have checked the contents and completed assembly. Please check all panels for defects or damage, prior to installation.

## HOLCOMBE BEDROOM FURNITURE

## SINGLE & DOUBLE DRAWER WINDOW SEATS

For more information on product go to: [www.jjopl.com](http://www.jjopl.com)

Note: End panels are handed, right or left, when assembling groove in panels should always face to rear.

### GREY TEXTILE DRAWER SYSTEM

#### SINGLE/DOUBLE DRAWER WINDOW SEATS

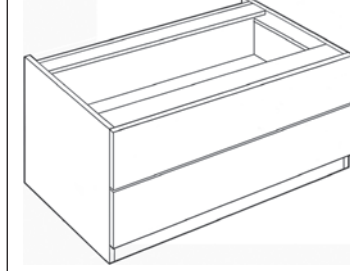

#### SINGLE/DOUBLE DRAWER WINDOW SEATS

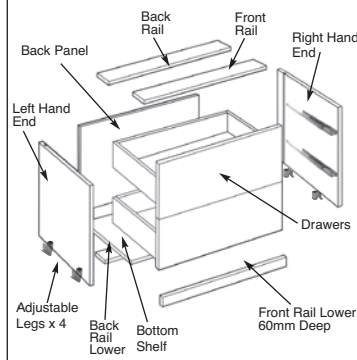

To avoid any surface damage when assembling units always ensure panels to be worked on are always placed onto a non abrasive protective surface.

5

Firmly press drawer front adjusters into pre-bored holes in drawer front, bring drawer box into position and secure to drawer front with screws provided through pre-bored holes in drawer box. Turn drawer over and fit drawer runner brackets to underside of drawer box with screws provided as shown below.



It is recommended that drawers should only be fitted once units have been installed.

1

Lay end panels face down on protective surface with groove facing upwards. Fix Large Fixing Bolts into positions indicated. Bring Drawer runners into position and fix to end panels into pre-bored holes with runner screws. Repeat operation for Left hand end panel.

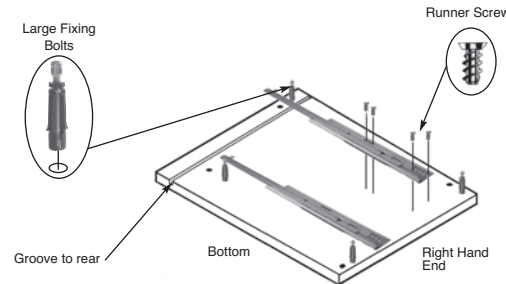

3

Bring all rails into position and secure to end panel as shown. Ensuring all Mini-fix cams are locked fully. Bring left hand end panel into position and secure to rails ensuring Mini-fix cams are locked fully.



Tap adjustable feet into gable end until flush and secure with screws.

Ensure rails with taped edges are positioned as shown.

Ensure the 60mm deep Front Rail is positioned as shown. At the front of the unit.

2

Lay Rails face down on protective surface. Firmly press home Mini Fix Cams into pre-bored holes ensuring arrow on cam faces outwards. Firmly press home wooden dowels into pre-bored holes, ensuring they are fully knocked in. NB: Back rail, front rail and back rail lower are 90mm deep, the front rail lower is 60mm deep. Always ensure the front rail is placed in the correct position when assembling.

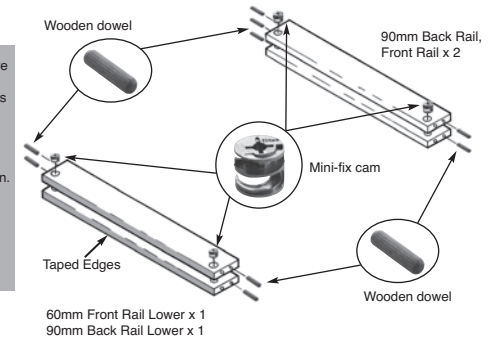

4

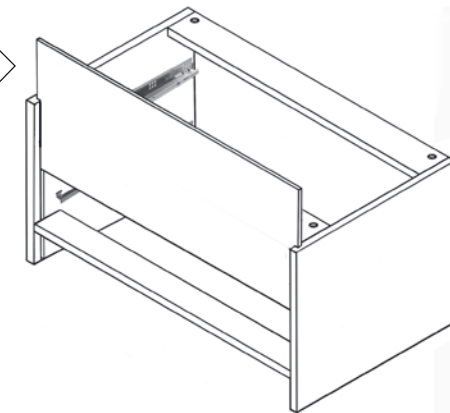

Bring unit into upright position and locate back panel into grooves in end panels.

6

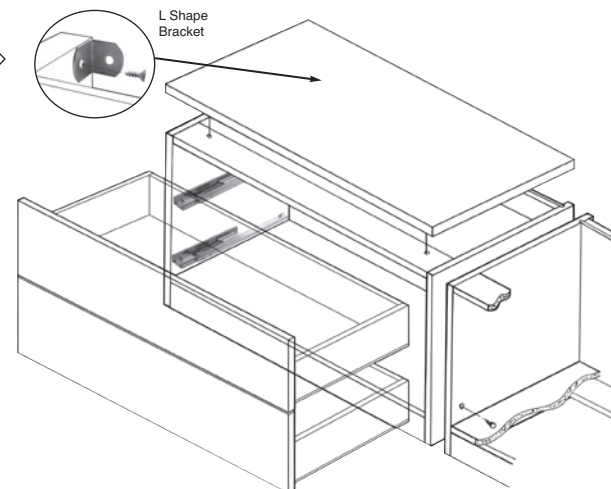

Place unit into position where it is to be located. Level unit by adjusting height in adjustable feet. Once unit is levelled place bottom shelf into position on back rail and front rail.

Levelling: To adjust legs insert flat head screwdriver, turn clockwise to raise, anti clockwise to lower.

2 x 'L' shaped brackets are supplied for securing unit to wall or securing worktop to unit. If using brackets to secure worktop these will be placed in front of back panel. If using brackets to secure to wall position as indicated. Screws cannot be provided for securing to wall due to differing wall constructions.

Worktop can be secured to unit using 2 x 30mm screws provided. Prior to fitting it will be required for installer to drill holes in front rail where required. Bring screws into position and secure worktop. If unit is to be secured to an adjacent unit, 2 x connecting bolts are supplied. It is left for installer to decide on position and securing of connecting bolts.

Once drawer fronts are fitted to drawer boxes bring drawers into position and place onto fully extended runners. Ensure drawer runner locates into the rear of the drawer box (small pre drilled hole). Firmly close the drawer into the unit. The drawer should locate onto the runner. Repeat this action with each drawer. If required unused pre bored holes in end panels can be plugged using 5mm cover caps supplied.

Plant on Panel(s). Will be required to any exposed gable ends to ensure colour co-ordination is maintained. Additional dimensional width of chest tops will be required to cover plant on gable end(s).

Please examine these drawings very carefully prior to assembly to determine the correct positions for hardware. Failure to do so could result in incorrect fitting or even damage to the items. Do not dispose of any packaging until you have checked the contents and completed assembly. Please check all panels for defects or damage, prior to installation.

#### CONTENTS CHECK LIST

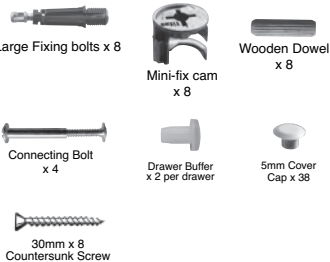

#### DRAWER BRACKET



#### FIXING DRAWER BRACKET TO DRAWER FRONT

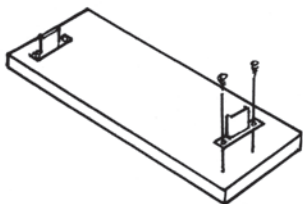

To avoid any surface damage when assembling units always ensure panels to be worked on are always placed onto a non abrasive protective surface.

It is recommended that drawers should only be fitted once units have been installed.

## HOLCOMBE BEDROOM FURNITURE

## DRESSING TABLE & KNEE HOLES

For more information on product go to: [www.jjoplc.com](http://www.jjoplc.com)

Note: End panels are handed, right or left, when assembling groove in panels should always face to rear.

### ANTARO DRAWER SYSTEM

#### DRESSING TABLE & KNEE HOLES

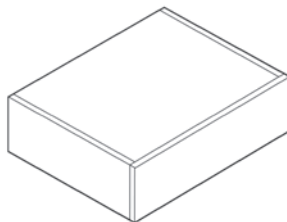

#### DRESSING TABLE & KNEE HOLES

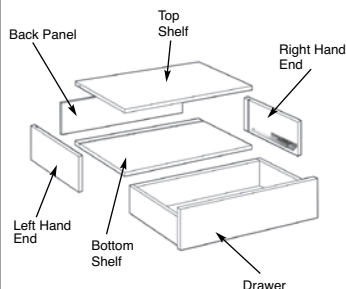

1

Lay end panels face down on protective surface with groove facing upwards. Fix Large Fixing Bolts into positions indicated. Bring Drawer runners into position and fix to end panels into pre-bored holes with runner screws. Repeat operation for Left hand end panel.

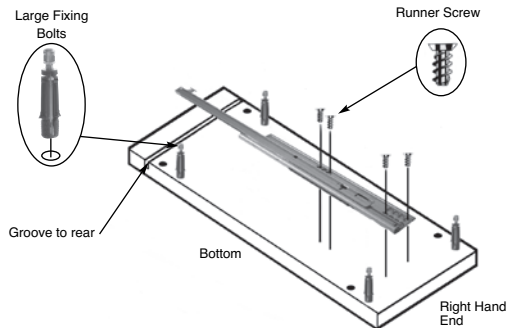

3

Bring top & bottom shelves into position and secure to end panel as shown. Ensuring all Mini-fix cams are locked fully. NB. Ensure grooves in shelves are facing inwards.

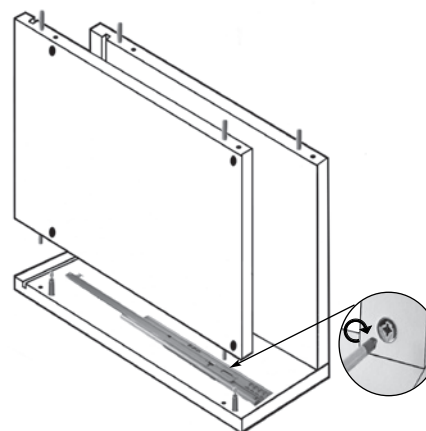

5

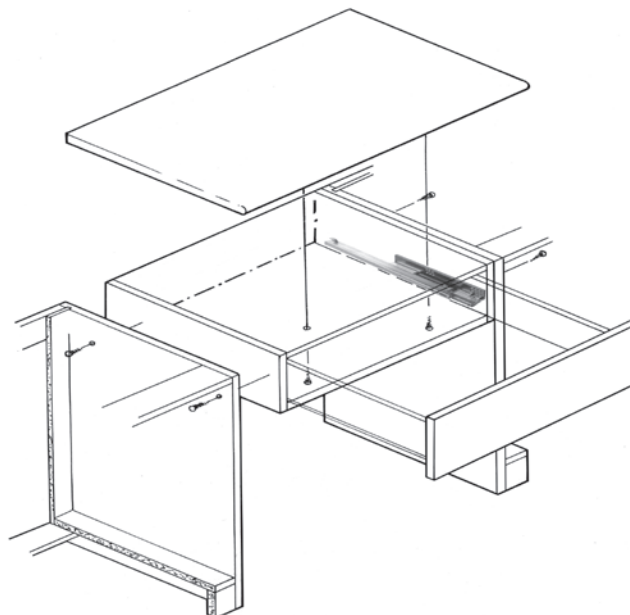

2

Lay Top & Bottom shelves face down on protective surface. Firmly press home Mini Fix Cams into pre-bored holes ensuring arrow on cam faces outwards. Firmly press home wooden dowels into pre-bored holes, ensuring they are fully knocked in.

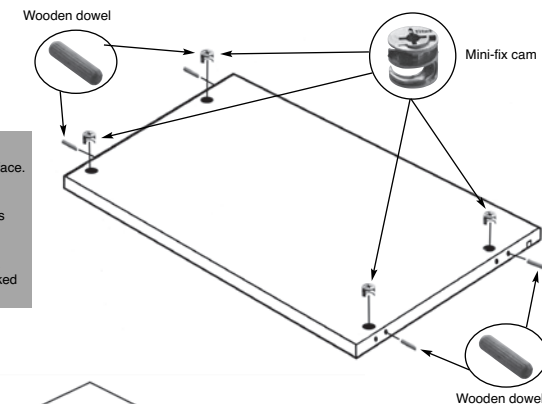

4

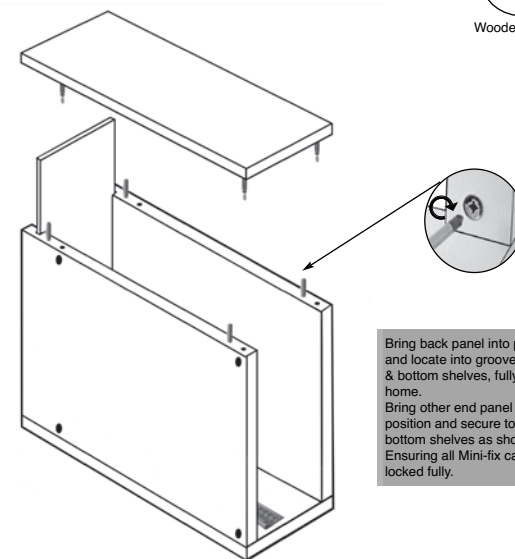

Bring back panel into position and locate into grooves in top & bottom shelves, fully press home. Bring other end panel into position and secure to top & bottom shelves as shown. Ensuring all Mini-fix cams are locked fully.

The dressing table should be positioned between two units and secured with either connecting bolts (these are supplied) or screws. It is left to the installer to decide on the position of the holes which require drilling to secure the units together. Worktop can be secured to unit using 2 x 30mm screws provided. Prior to fitting it will be required for installer to drill holes in top shelf where required. Bring screws into position and secure worktop.

Once drawer fronts are fitted to drawer boxes bring drawers into position and place onto fully extended runners. Ensure drawer runner locates into the rear of the drawer box (small pre drilled hole). Firmly close the drawer into the unit. The drawer should locate onto the runner. If required unused pre bored holes in end panels can be plugged using 5mm cover caps supplied.



Please examine these drawings very carefully prior to assembly to determine the correct positions for hardware. Failure to do so could result in incorrect fitting or even damage to the items. Do not dispose of any packaging until you have checked the contents and completed assembly. Please check all panels for defects or damage, prior to installation.

#### CONTENTS CHECK LIST

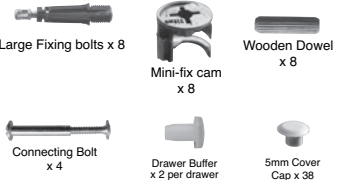

#### FIXING DRAWER FRONT TO DRAWER BOX

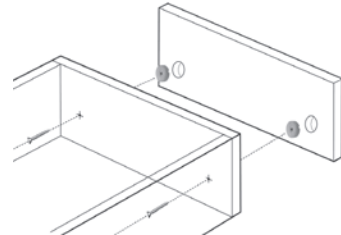

Firmly press drawer front adjusters into pre-bored holes in drawer front, bring drawer box into position and secure to drawer front with screws provided through pre-bored holes in drawer box. Turn drawer over and fit drawer runner brackets to underside of drawer box with screws provided as shown below.

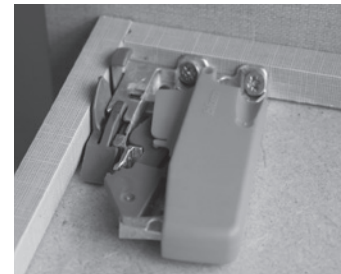

It is recommended that drawers should only be fitted once units have been installed.

## HOLCOMBE BEDROOM FURNITURE

Note: End panels are handed, right or left, when assembling groove in panels should always face to rear.

### GREY TEXTILE DRAWER SYSTEM

#### DRESSING TABLE & KNEE HOLES

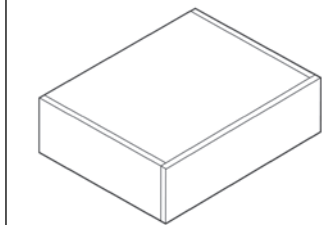

#### DRESSING TABLE & KNEE HOLES

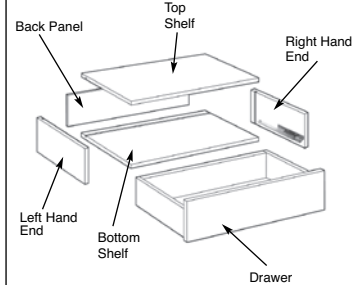

To avoid any surface damage when assembling units always ensure panels to be worked on are always placed onto a non abrasive protective surface.

1

Lay end panels face down on protective surface with groove facing upwards. Fix Large Fixing Bolts into positions indicated. Bring Drawer runners into position and fix to end panels into pre-bored holes with runner screws. Repeat operation for Left hand end panel.

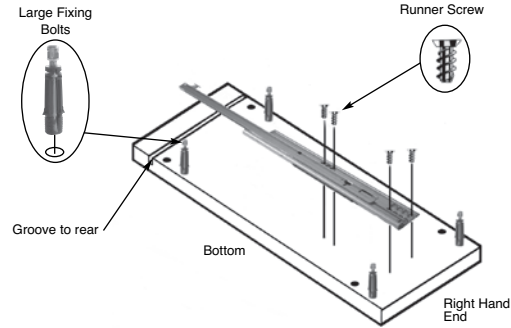

3

Bring top & bottom shelves into position and secure to end panel as shown. Ensuring all Mini-fix cams are locked fully. NB. Ensure grooves in shelves are facing inwards.

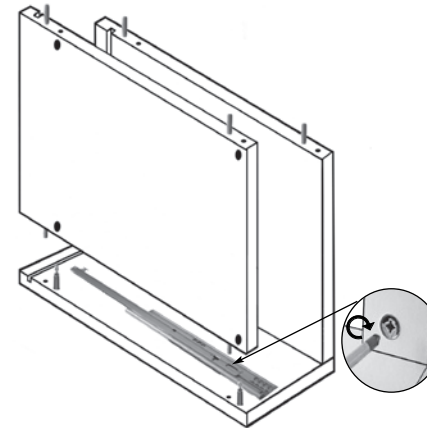

5

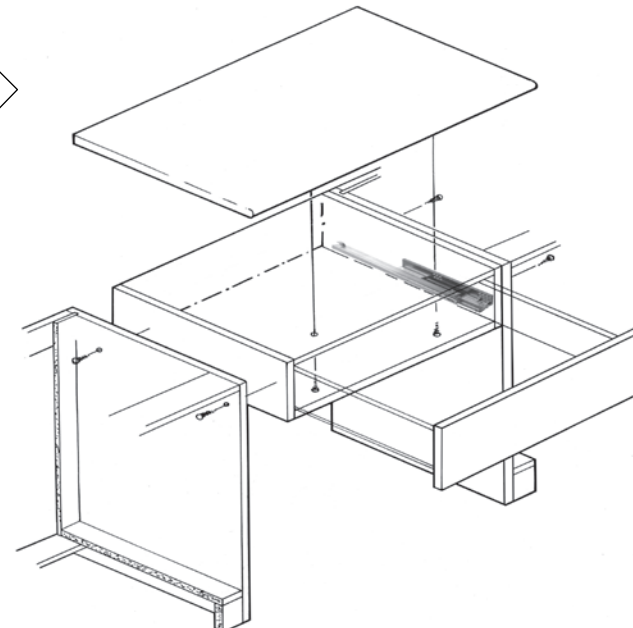

The dressing table should be positioned between two units and secured with either connecting bolts (these are supplied) or screws. It is left to the installer to decide on the position of the holes which require drilling to secure the units together. Worktop can be secured to unit using 2 x 30mm screws provided. Prior to fitting it will be required for installer to drill holes in top shelf where required. Bring screws into position and secure worktop.

Once drawer fronts are fitted to drawer boxes bring drawers into position and place onto fully extended runners. Ensure drawer runner locates into the rear of the drawer box (small pre drilled hole). Firmly close the drawer into the unit. The drawer should locate onto the runner. If drawer fascia adjustment is required, slacken drawer fascia retaining screws. Within the drawer front adjuster there is a floating mechanism which allows for 2mm adjustment in two directions. Adjust as necessary and tighten drawer fascia retaining screws. If required unused pre bored holes in end panels can be plugged using 5mm cover caps supplied.

## DRESSING TABLE & KNEE HOLES

For more information on product go to: [www.jjoplc.com](http://www.jjoplc.com)

2

Lay Top & Bottom shelves face down on protective surface. Firmly press home Mini Fix Cams into pre-bored holes ensuring arrow on cam faces outwards. Firmly press home wooden dowels into pre-bored holes, ensuring they are fully knocked in.

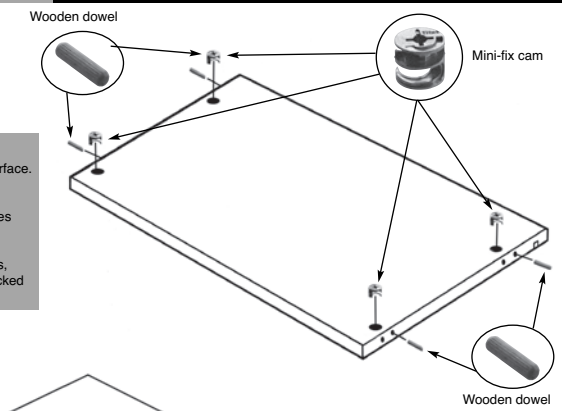

4

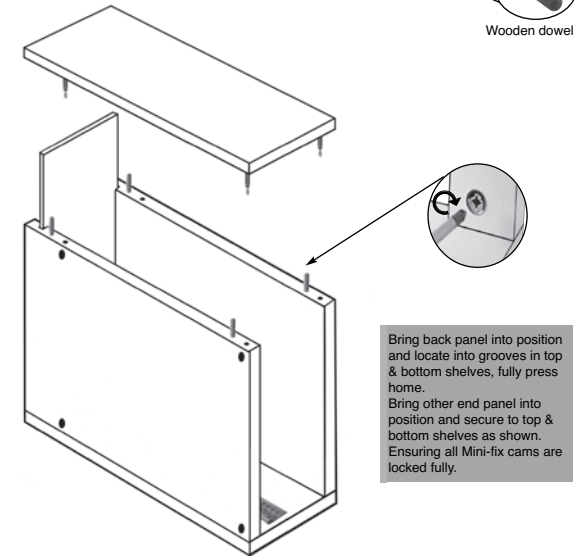

Bring back panel into position and locate into grooves in top & bottom shelves, fully press home. Bring other end panel into position and secure to top & bottom shelves as shown. Ensuring all Mini-fix cams are locked fully.

Please examine these drawings very carefully prior to assembly to determine the correct positions for hardware. Failure to do so could result in incorrect fitting or even damage to the items. Do not dispose of any packaging until you have checked the contents and completed assembly. Please check all panels for defects or damage, prior to installation.

#### CONTENTS CHECK LIST

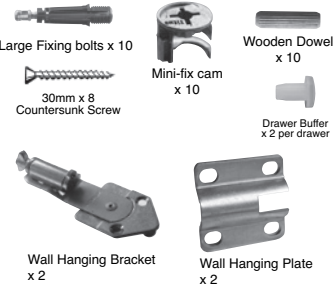

#### DRAWER BRACKET



#### FIXING DRAWER BRACKET TO DRAWER FRONT

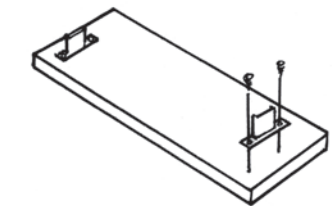

To avoid any surface damage when assembling units always ensure panels to be worked on are always placed onto a non abrasive protective surface.

It is recommended that drawers should only be fitted once units have been installed.

## HOLCOMBE BEDROOM FURNITURE

## FLOATING BEDSIDE CABINET WITH DRAWER.

For more information on product go to: [www.jjoplac.com](http://www.jjoplac.com)

Note: End panels are handed, right or left, when assembling always ensure correct handing has been selected.

### ANTARO DRAWER SYSTEM

#### FLOATING BEDSIDE CABINET WITH DRAWER

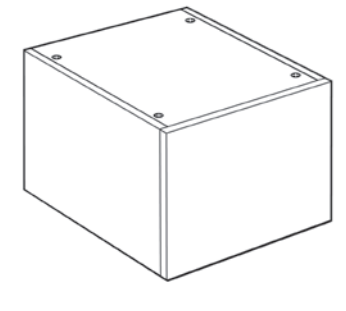

#### FLOATING BEDSIDE CABINET WITH DRAWER

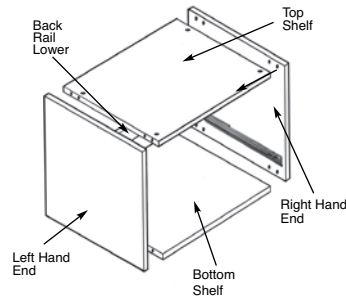

#### WALL HANGING BRACKET FIXING & ADJUSTMENT

**1** Locate the arms of the wall hanging brackets through the slots in wall hanging plates, firmly push home.



**2** Turn the arm 'B' through 90° to secure.

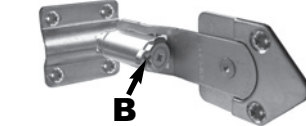

**3** Turn the screw in the arm 'C', clockwise, to fully tighten.

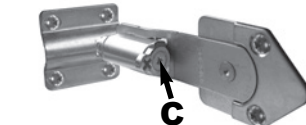

**1**

Lay end panels face down on protective surface. Fix Large Fixing Bolts into positions indicated. Bring Drawer runner into position and fix to end panel into pre-bored holes with runner screws. Bring Wall hanging bracket into position, firmly press home into pre-bored holes, secure with screws provided. Repeat operation for Left hand end panel.

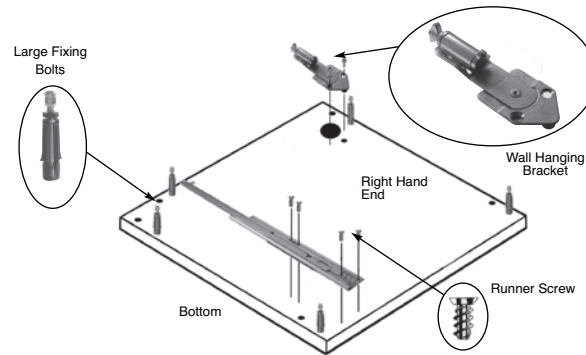

**3**

Bring top & bottom shelves & back rail into position and secure to end panel as shown. Ensuring all Mini-fix cams are locked fully.

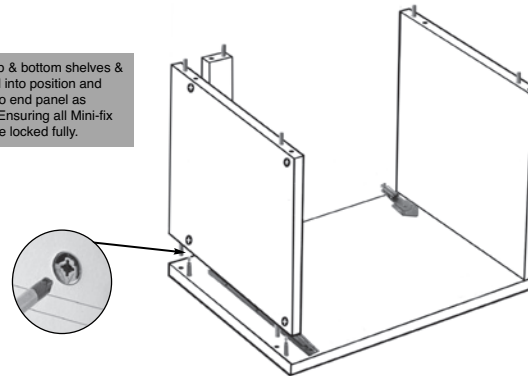

**5**

#### Wall Hanging Plate Positioning

Floating bedside cabinets can be sited in multiple positions, it is left to the installer to finalise exact location and positioning on wall. Fix wall hanging plates to walls in agreed positions, using suitable screws, these are not provided because of differing wall construction. For adjustment of wall hanging brackets see diagrams opposite.

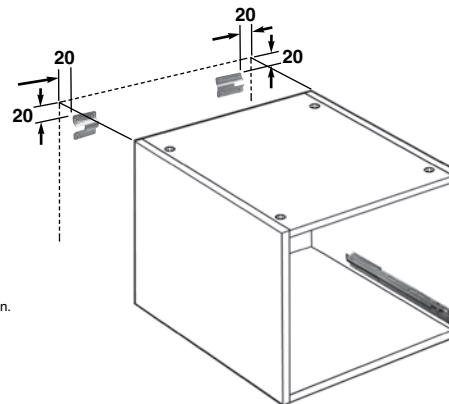

Place unit into position on wall hanging brackets and secure. See diagrams opposite for securing wall hanging bracket to wall hanging plate.

**2**

Lay back rail, top & bottom shelves face down on protective surface. Firmly press home Mini Fix Cams into pre-bored holes ensuring arrow on cam faces outwards. Firmly press home wooden dowels into pre-bored holes, ensuring they are fully knocked in. NB: The back rail lower is 60mm deep.

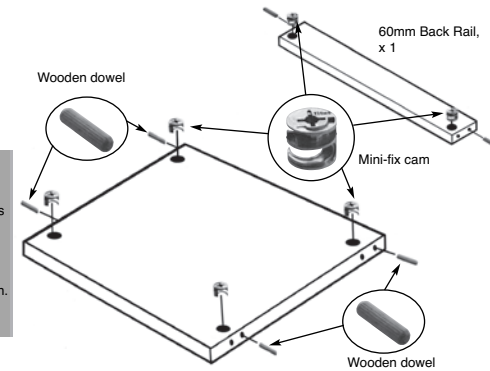

**4**

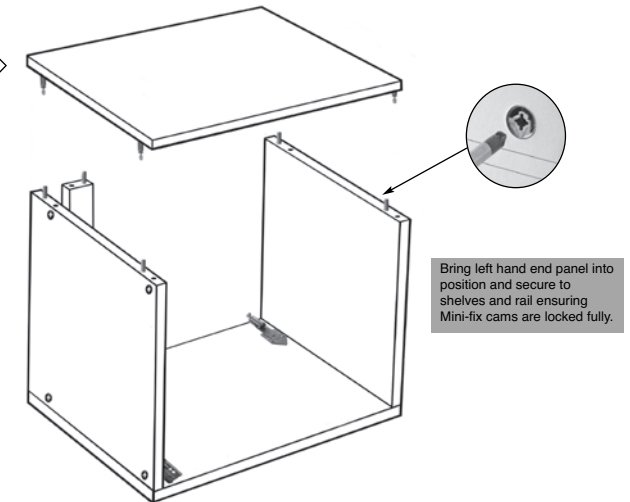

Bring left hand end panel into position and secure to shelves and rail ensuring Mini-fix cams are locked fully.

**6**

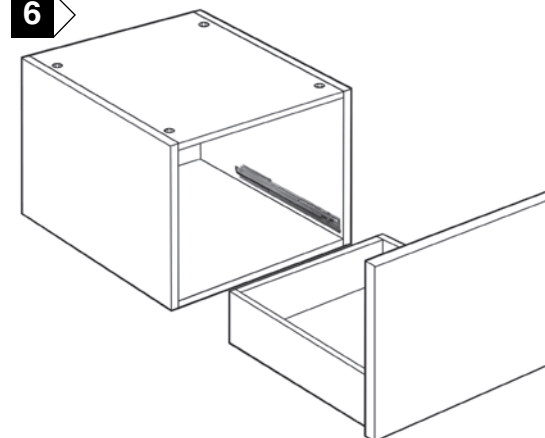

Once drawer front is fitted to drawer box bring drawer into position and place onto fully extended runners. Ensure drawer runner locates into the rear of the drawer box (small pre drilled hole). Firmly close the drawer into the unit. The drawer should locate onto the runner. If required unused pre bored holes in end panels can be plugged using 5mm cover caps supplied.

#### Plant on Panel(s).

Will be required to any exposed gable ends to ensure colour co-ordination is maintained. Additional dimensional width of chest tops will be required to cover plant on gable end(s).

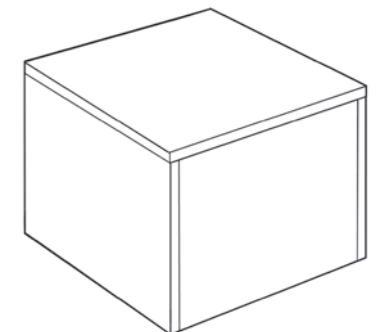

Worktop can be secured to unit using 2 x 30mm screws provided. Prior to fitting it will be required for installer to drill holes in top panel where required. Bring screws into position and secure worktop.

Please examine these drawings very carefully prior to assembly to determine the correct positions for hardware. Failure to do so could result in incorrect fitting or even damage to the items. Do not dispose of any packaging until you have checked the contents and completed assembly. Please check all panels for defects or damage, prior to installation.

#### CONTENTS CHECK LIST

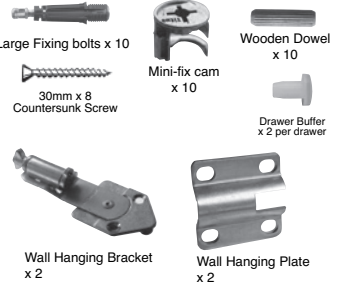

#### FIXING DRAWER FRONT TO DRAWER BOX

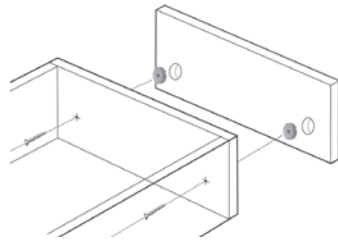

Firmly press drawer front adjusters into pre-bored holes in drawer front, bring drawer box into position and secure to drawer front with screws provided through pre-bored holes in drawer box.  
Turn drawer over and fit drawer runner brackets to underside of drawer box with screws provided as shown below.

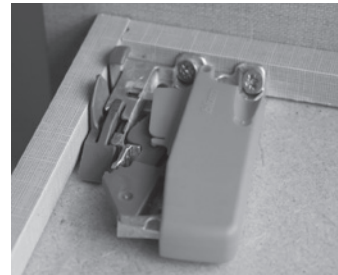

To avoid any surface damage when assembling units always ensure panels to be worked on are always placed onto a non abrasive protective surface.

It is recommended that drawers should only be fitted once units have been installed.

## HOLCOMBE BEDROOM FURNITURE

Note: End panels are handed, right or left, when assembling always ensure correct handing has been selected.

### GREY TEXTILE DRAWER SYSTEM

#### FLOATING BEDSIDE CABINET WITH DRAWER

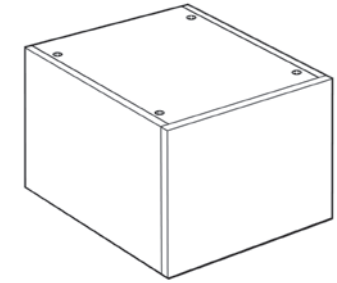

#### FLOATING BEDSIDE CABINET WITH DRAWER

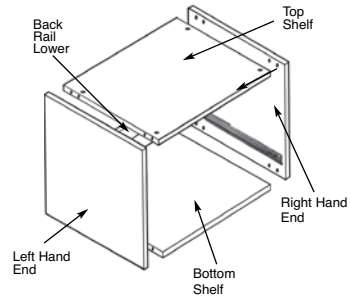

#### WALL HANGING BRACKET FIXING & ADJUSTMENT

**1** Locate the arms of the wall hanging brackets through the slots in wall hanging plates, firmly push home.



**2** Turn the arm 'B' through 90° to secure.

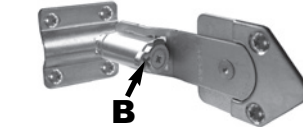

**3** Turn the screw in the arm 'C', clockwise, to fully tighten.

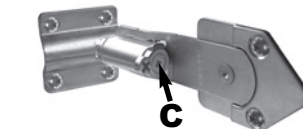

**1**

Lay end panels face down on protective surface. Fix Large Fixing Bolts into positions indicated. Bring Drawer runner into position and fix to end panel into pre-bored holes with runner screws. Bring Wall hanging bracket into position, firmly press home into pre-bored holes, secure with screws provided. Repeat operation for Left hand end panel.

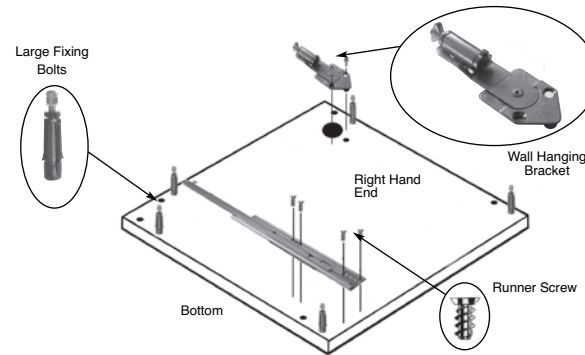

**3**

Bring top & bottom shelves & back rail into position and secure to end panel as shown. Ensuring all Mini-fix cams are locked fully.



**5**

#### Wall Hanging Plate Positioning

Floating bedside cabinets can be sited in multiple positions, it is left to the installer to finalise exact location and positioning on wall. Fix wall hanging plates to walls in agreed positions, using suitable screws, these are not provided because of differing wall construction. For adjustment of wall hanging brackets see diagrams opposite.

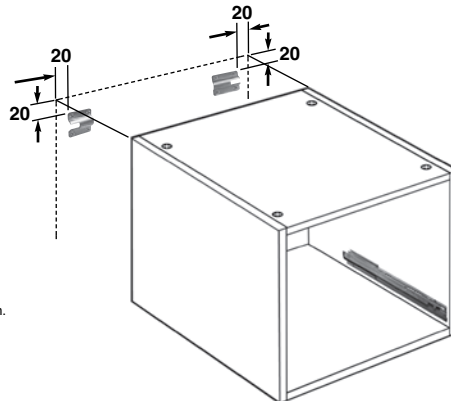

Place unit into position on wall hanging brackets and secure. See diagrams opposite for securing wall hanging bracket to wall hanging plate.

## FLOATING BEDSIDE CABINET WITH DRAWER.

**2**

Lay back rail, top & bottom shelves face down on protective surface. Firmly press home Mini Fix Cams into pre-bored holes ensuring arrow on cam faces outwards. Firmly press home wooden dowels into pre-bored holes, ensuring they are fully knocked in. NB: The back rail lower is 60mm deep.

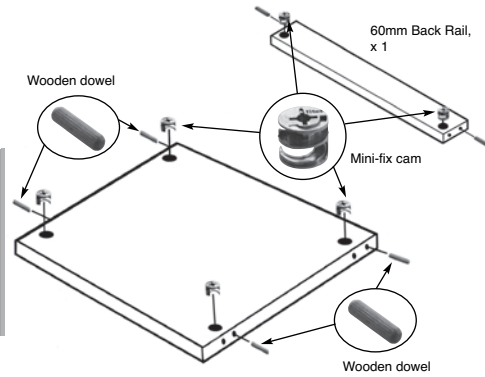

**4**

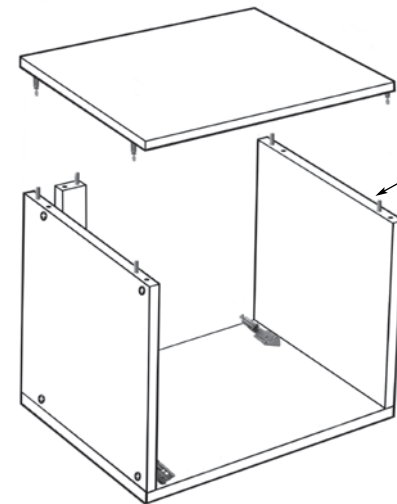

Bring left hand end panel into position and secure to shelves and rail ensuring Mini-fix cams are locked fully.

**6**

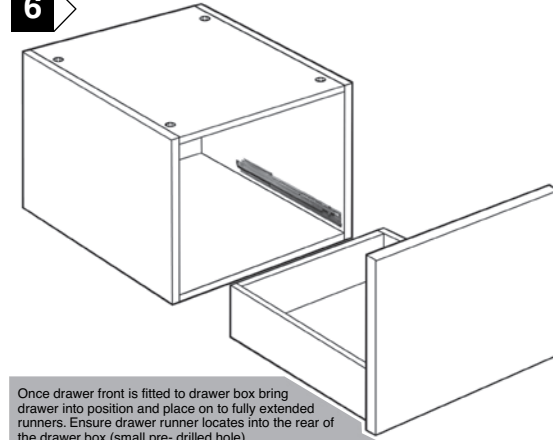

Once drawer front is fitted to drawer box bring drawer into position and place on to fully extended runners. Ensure drawer runner locates into the rear of the drawer box (small pre-drilled hole). Firmly close the drawer into the unit. The drawer should locate onto the runner. If drawer fascia adjustment is required, slacken drawer fascia retaining screws. Within the drawer front adjuster there is a floating mechanism which allows for 2mm adjustment in two directions. Adjust as necessary and tighten drawer fascia retaining screws. If required unused pre bored holes in end panels can be plugged using 5mm cover caps supplied.

#### Plant on Panel(s).

Will be required to any exposed gable ends to ensure colour co-ordination is maintained. Additional dimensional width of chest tops will be required to cover plant on gable end(s).

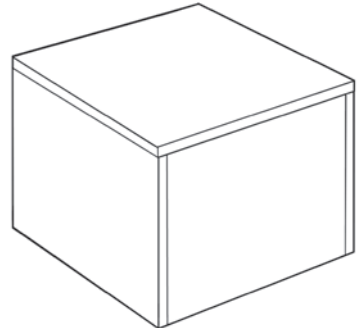

Worktop can be secured to unit using 2 x 30mm screws provided. Prior to fitting it will be required for installer to drill holes in top panel where required. Bring screws into position and secure worktop.



Please examine these drawings very carefully prior to assembly to determine the correct positions for hardware. Failure to do so could result in incorrect fitting or even damage to the items. Do not dispose of any packaging until you have checked the contents and completed assembly. Please check all panels for defects or damage, prior to installation.

#### CONTENTS CHECK LIST



#### DOORS

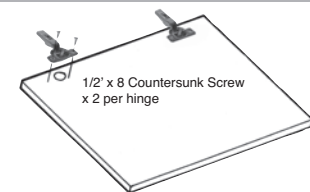

#### CLIP-ON HINGE ADJUSTMENT

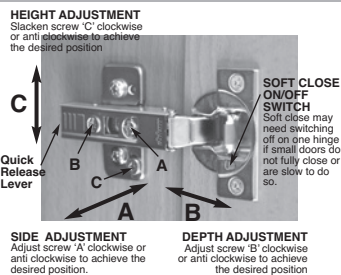

It is recommended that door/s and adjustable shelves should only be fitted once units have been installed.

To avoid any surface damage when assembling units always ensure panels to be worked on are always placed onto a non abrasive protective surface.

#### Double Units

The assembly for double units is the same as single units. Double units have two doors.

## HOLCOMBE BEDROOM FURNITURE

Note: End panels are handed, right or left. when assembling groove in panels should always face rear.

### SINGLE/DOUBLE CABINETS BEDSIDE/STANDARD HEIGHT

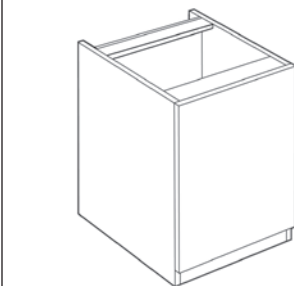

### SINGLE/DOUBLE CABINETS BEDSIDE/STANDARD HEIGHT

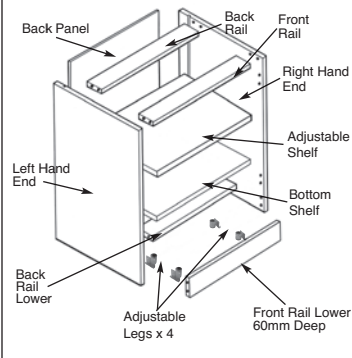

1

Lay end panel face down on protective surface with groove facing upwards. Fix Large Fixing Bolts, & Hinge Plates into positions indicated. Repeat operation for Left Hand End Panel. (For single doored unit hinge plates are not required in left hand end panel).

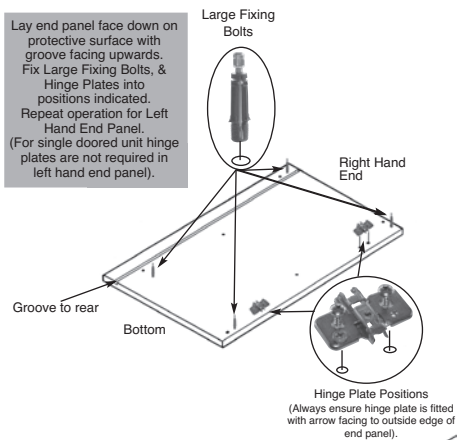

4

Bring all rails into position and secure to end panel as shown. Ensuring all Mini-fix cams are locked fully. Bring left hand end panel into position and secure to rails ensuring Mini-fix cams are locked fully.

Tap adjustable feet into gable end edge until flush and secure with screws.



## SINGLE & DOUBLE CABINETS. BEDSIDE/STANDARD HEIGHT.

2

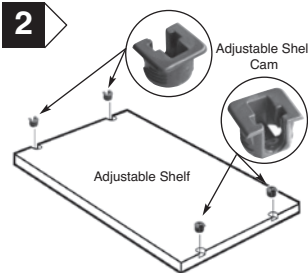

Lay adjustable shelf face down on protective surface. Firmly press home Fixed Shelf Cams into pre-bored holes ensuring opening in cams face outwards.

3

Lay Rails face down on protective surface. Firmly press home Mini Fix Cams into pre-bored holes ensuring arrow on cam faces outwards. Firmly press home wooden dowels into pre-bored holes, ensuring they are fully knocked in. NB: Back rail, front rail and back rail lower are 90mm deep, the front rail lower is 60mm deep. Always ensure the front rail is placed in the correct position when assembling.

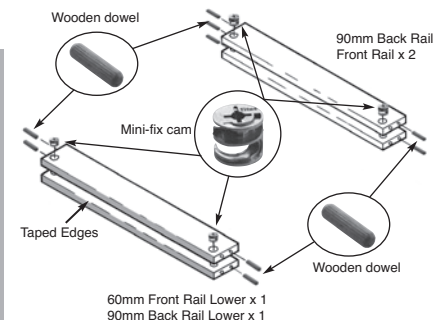

5

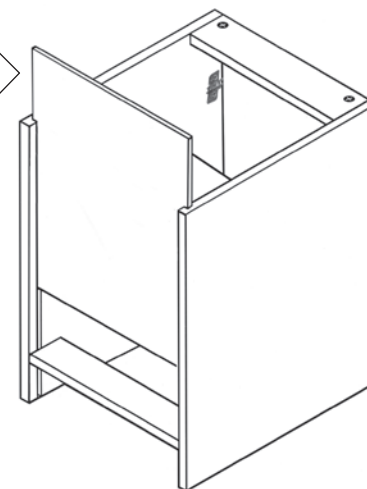

Bring unit into upright position and locate back panel into grooves in end panels.

6

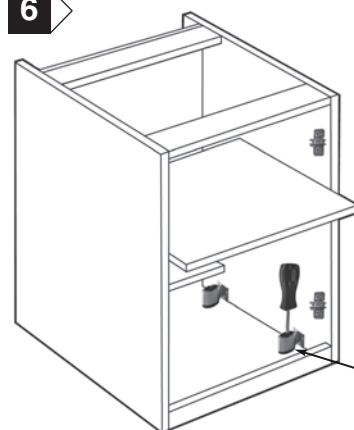

Place unit into position where it is to be located. Level unit by adjusting height in adjustable feet. Once unit is levelled place bottom shelf into position on back rail and front rail.



Levelling: To adjust legs insert flat head screwdriver, turn clockwise to raise, anti clockwise to lower.

7

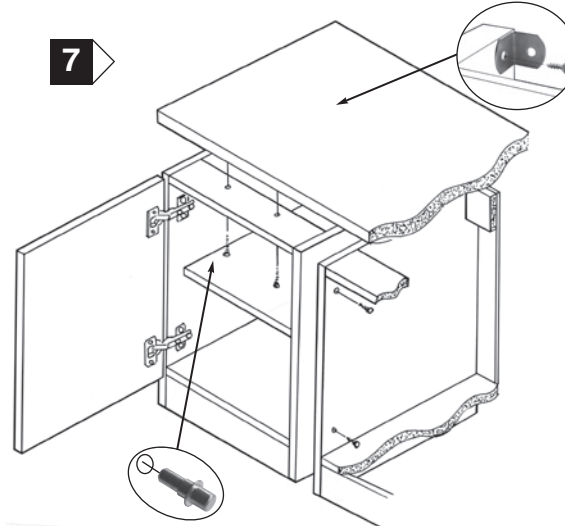

2 x 'L' shaped brackets are supplied for securing unit to wall or securing worktop to unit. If using brackets to secure worktop these will be placed in front of back panel. If using brackets to secure to wall position as indicated. Screws cannot be provided for securing to wall due to differing wall constructions.

Worktop can be secured to unit using 2 x 30mm screws provided. Prior to fitting it will be required for installer to drill holes in front rail where required. Bring screws into position and secure worktop. If unit is to be secured to an adjacent unit, 2 x connecting bolts are supplied. It is left for installer to decide on position and securing of connecting bolts.

Bring door/s into position and place onto hinge plates, lock into position by firmly pressing arm on hinge home. Adjust as shown in diagram opposite. Push adjustable shelf supports firmly into pre-bored holes in end panels, bring adjustable shelf into position on adjustable shelf supports and firmly press home. If required the unused pre-bored holes in end panels can be plugged with the 5mm cover caps supplied.

Plant on Panel(s). Will be required to any exposed gable ends to ensure colour co-ordination is maintained.

Please examine these drawings very carefully prior to assembly to determine the correct positions for hardware. Failure to do so could result in incorrect fitting or even damage to the items. Do not dispose of any packaging until you have checked the contents and completed assembly. Please check all panels for defects or damage, prior to installation.

#### CONTENTS CHECK LIST

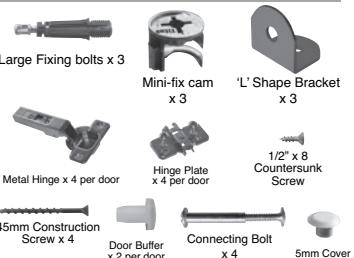

#### DOORS

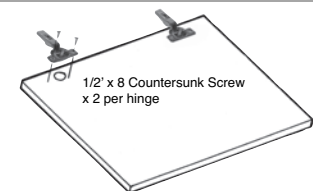

#### CLIP-ON HINGE ADJUSTMENT

**HEIGHT ADJUSTMENT**  
Slacken screw 'C' clockwise or anti clockwise to achieve the desired position.

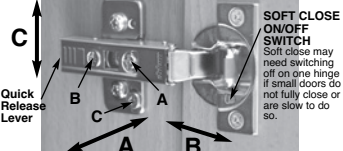

**SIDE ADJUSTMENT**  
Adjust screw 'A' clockwise or anti clockwise to achieve the desired position.

**DEPTH ADJUSTMENT**  
Adjust screw 'B' clockwise or anti clockwise to achieve the desired position.

To avoid any surface damage when assembling units always ensure panels to be worked on are always placed onto a non abrasive protective surface.

It is recommended that door/s and adjustable shelves should only be fitted once units have been installed.

## HOLCOMBE BEDROOM FURNITURE

Please Note:  
Follow steps 1 - 6 of single & double base assembly. (Do not fit hinge plates to end panels). Prior to fitting corner post please ensure that the correct handing of door has been decided. Failure to do so could result in unnecessary damage.

#### DOUBLE CORNER BASE UNITS

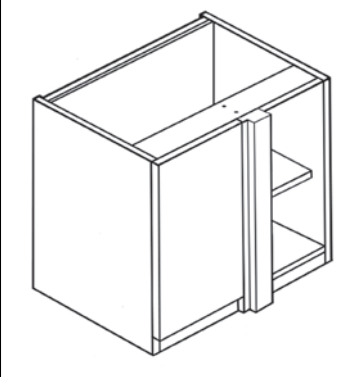

#### DOUBLE CORNER BASE UNIT

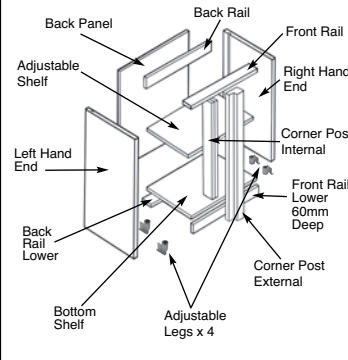

1

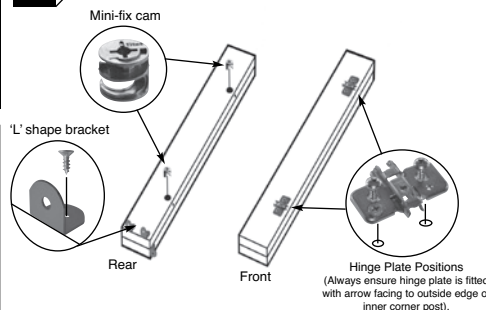

Lay inner corner post face down on protective surface with pre-bored holes facing upwards, firmly press home into holes Mini Fix Cams ensuring arrow on cam faces outwards. Fit 'L' shape brackets x 3 to inner corner post with screws provided. Turn post over and fix Hinge Plates into positions indicated.

3

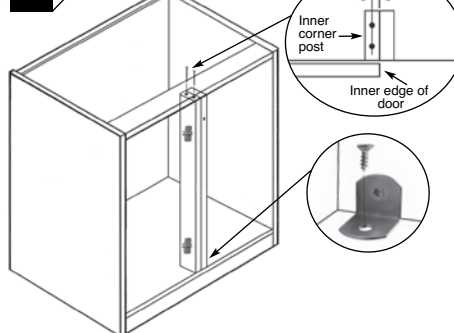

From the pencil mark measure 9mm from outer edge of door, two pre bored holes will be required to be drilled through the front rail by the installer in suitable positions, secure post to top rail with 45mm screws provided. Secure bottom of post to bottom shelf through 'L' shape brackets with screws provided.

6

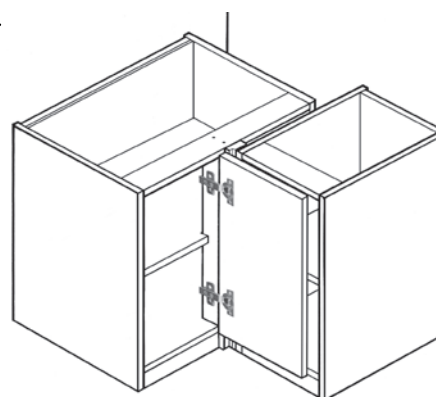

## DOUBLE CORNER BASE UNITS. ASSEMBLY INSTRUCTIONS

1A

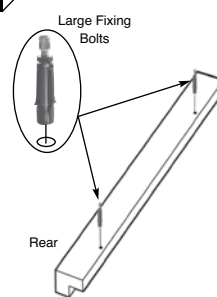

Lay corner post face down on protective surface with pre-bored holes facing upwards. Fix Large Fixing Bolts into positions indicated.

4

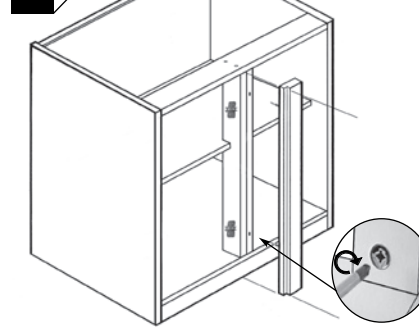

Bring corner post into position and secure to inner corner post as shown. Ensuring all Mini-fix cams are locked fully. As the internal space is reduced by the internal corner post the adjustable shelf will require scribing around the internal corner post, once this has been completed bring adjustable shelf into position and fully press down onto Mini-fixing bolts. Fully lock all Fixed shelf cams.

2

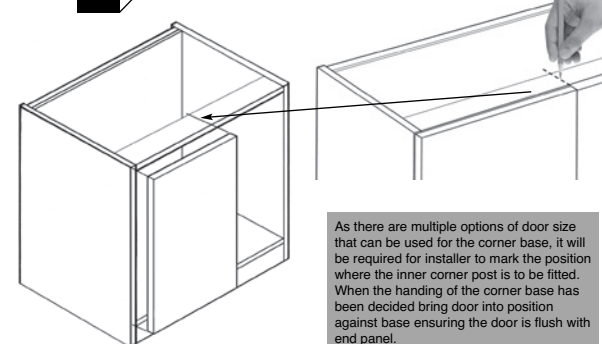

As there are multiple options of door size that can be used for the corner base, it will be required for installer to mark the position where the inner corner post is to be fitted. When the handing of the corner base has been decided bring door into position against base ensuring the door is flush with end panel. With the door flush against top rail & bottom shelf mark with pencil the inner edge of the door, this is where the centre of the inner corner post will sit.

5

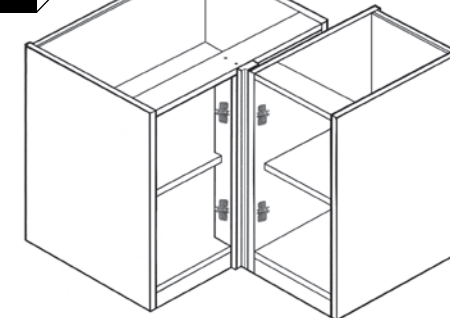

Place unit into position where it is to be located. Ensuring gap to wall is correct to size of door being used, (see diagrams below for spacing details). Bring adjoining unit into position as shown and secure to corner post with suitable size screws.

#### CORNER SITUATIONS

All dimensions in Millimeters

When fitting corner bases the following dimensions should be used.

##### 600mm CORNER BASE

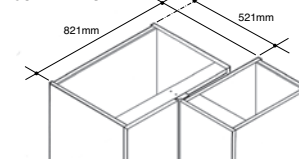

##### 800mm CORNER BASE

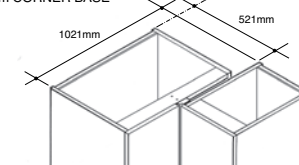

Bring door into position and place onto hinge plates, lock into position by firmly pressing arm on hinge home. Adjust as shown in diagram opposite. If required the unused pre-bored holes in end panels can be plugged with the 5mm cover caps supplied.

Plant on Panel(s). Will be required to any exposed gable ends to ensure colour co-ordination is maintained. If robes are fitted within a recess they are not required

## **Guarantee Details**

**Congratulations on your purchase of Holcombe bedroom furniture.**

**Proudly manufactured in Great Britain since 1868.**

**We are confident in the quality of the furniture we manufacture.**

**In the unlikely event that of any of the units prove defective, as a result of faults within materials or manufacturing processes, during a period of ten years from date of purchase, we will repair or replace at our discretion, providing proof of purchase has been retained by the original purchaser.**

**The guarantee applies to cabinets, doors and drawers only and excludes colour fade due to mellowing and exposure to sunlight.**

**Any claims must be made, as soon as the fault becomes apparent by the original purchaser, through the retailer whom the product was purchased.**

**Guarantee covers domestic use only and is non transferable.**



## **Care/Maintenance**

**PVC Wrapped, Image Gloss, & Tempo – Once the protective film has been removed, we recommend cleaning using a damp (not wet) soft cloth with a mild soap solution (5% detergent, 95% water).**

**Use a dry cloth to polish away any streaks.**

**Never leave standing water on Chest tops.**

**Do not use furniture polish or abrasive or aggressive cleaning agents, as these will damage the surface of the furniture.**

**Likewise any spirit based cleaner.**

**Painted Timber (Pendle) – Please try to avoid any clashes with your painted furniture, as like any painted finish it will dent & chip if accidentally struck with a blunt object.**

**Only clean with a damp soft cloth, with a 5% mild detergent solution.**

**Dry immediately afterwards with a soft dry cloth.**

**Avoid rubbing vigorously as this action will damage and wear the paint off.**

**Hinges and drawers may need some minor adjustment over time.**

**This is to be expected and will re-align drawers and doors.**

# **HOLCOMBE**

---

## **BEDROOM FURNITURE**

---

### **ASSEMBLY INSTRUCTIONS & AFTER CARE**

---

