

DOOR CARE GUIDE

PLEASE READ CAREFULLY BEFORE COMMENCING ANY WORK ON YOUR KITCHEN

Before commencing any work on this door / accessory, i.e. drilling for hinges or handles, cutting etc., please inspect the product thoroughly making sure that it meets your requirements for colour consistency and is free from scratches or polishing blemishes. Once the product has been altered in any way from the state it was supplied it **CANNOT BE REPLACED.**

FITTING DOOR / DRAWER FASCIAS - When fitting handles and hinges to doors / drawers, ensure the door is placed on a soft cushioned surface, to avoid scratching the fascia.

LAMINATE, FOIL WRAPPED OR PVC FASCIA - These doors are supplied with a protective film over the front. Remove this only after they are installed as the curing process continues for around 72 hours after the film is removed. This means the doors will be liable to scratching and other marks. Avoid cleaning the doors for at least a few days to prevent any marks appearing on the surface. Look closely at the protective film for a tab or raised area that can be pulled and fully removed. Clean the smooth surface of any residual adhesive with a no more than 5% citrus soap solution after the protective film has been removed. For product cleaning only use a 5% soap, 95% water (liquid soap) solution, wiping with a damp (not wet) cloth, finally drying with a soft clean cloth. No water should ever be left on any surface of the door for any length of time. Dust with a soft cloth only. Do not use wax-furniture polish, abrasive or aggressive cleaners, bleach or other hypochlorate (chlorine) based cleaners, multi-purpose cleaners, dilutes, acetone, alcohol, solvent or similar products on the door, as this will damage the surface. Cooking splashes should be wiped up immediately using a damp cloth. Under NO circumstances must the hob be used without having pans above the ignited jets as the heat may cause damage to the doors which cannot be exchanged under the guarantee. Please note that the doors on the wall units either side of the hob must be fitted with doors buffers to allow air circulation. When installing PVC doors next to a cooker please refer overleaf. Failure to follow the instruction detailed on this sheet will invalidate any warranty

TIMBER AND PAINTED TIMBER KITCHEN DOORS - For product cleaning only use a 5% soap, 95% water (liquid soap) solution, wiping with a damp (not wet) cloth, finally drying with a soft clean cloth. Dust with a soft cloth only, following the grain pattern of the wood. No water should ever be left on any surface of the door for any length of time. Do not use abrasive or aggressive cleaners, bleach or other hypochlorate (chlorine) based cleaners, multi-purpose cleaners, dilutes, acetone, alcohol, solvent or similar products on the door as this will damage the surface. Some household furniture polishes, when used over time, may leave a sheen on the surface of the door that cannot be removed. It is advisable to use a damp (not wet) cloth to remove fingerprints and marks, followed at once with a clean and dry soft cloth. Cooking splashes should be wiped up immediately using a damp cloth. All timbers are adversely affected by the environment in which they are installed, particularly a moist climate and in high levels of humidity. Timber is hygroscopic which means the material will take up or let out moisture depending on the environment it is placed in. We therefore recommend that timber doors only be installed in areas that have been suitably acclimatized so that the timber is allowed to find its EMC (Equilibrium moisture content). Feint paint cracks within timber joints are as a consequence of expansion & contraction within the seasons of the year and are not recognised as a fault. Natural timber & painted timber changes colour when exposed to light, the rate of change being dependent upon the species and the intensity of exposure. Therefore, please consider when ordering an additional timber door sometime after the original kitchen has been installed that a variation in colour is probable.

HUMIDITY/ATMOSPHERE - Newly plastered rooms and plaster repairs should be left to environmentally stabilise before storage and installation of doors, whatever their material. Please note that intense heat or steam can have an adverse effect on the performance of your kitchen fascia, subsequently the use of small appliances such as kettles, irons, toasters or sterilising units in close proximity to your kitchen fascia should be avoided.

IMPORTANT INSTALLATION NOTES - When fitting this fascia next to a built under oven it is most important that the top rail of the oven housing cabinet has been removed and that the fascia is fitted with door buffers to allow air circulation.

IMPORTANT NOTICE WHEN FITTING OVENS NEXT TO PVC DOORS.

HEAT DEFLECTOR FITTING INSTRUCTIONS FOR USE ON ALL PVC DOORS.

600mm Built Under Oven Housings

When Installing an Oven into the above situation the following steps must be adhered to:-

Carcase Modifications:

1. Remove the front top rail of the carcass.
2. Cut an opening into the fixed bottom shelf 450mm wide by 50mm deep to assist air flow from beneath the carcass.
3. Ensure that the oven support shelf is only held in position at the front and sides only, with the back left open to allow unobstructed airflow

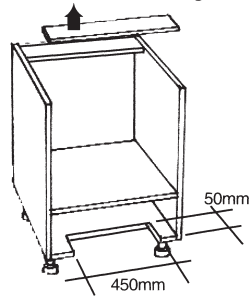

Heat Deflector Installation:

1. Screw the heat deflectors to the front edge of the carcass gables using the four holes provided.

Ensure that the top of the deflector is firmly pressed to the worktop, apply a thin bead of heat resistant clear silicone to form an airtight seal between the worktop and the deflector

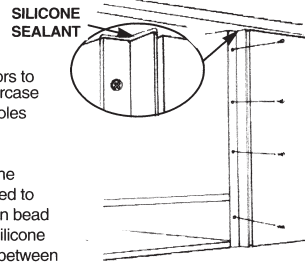

2. Position the oven into place in the carcass and mark the positions of the oven securing holes on the heat deflector.

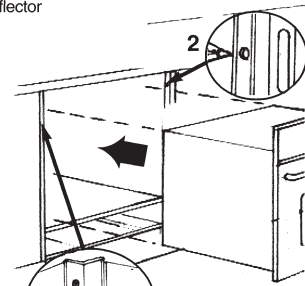

3. Remove the oven and drill through the deflectors in the positions marked, using a suitable drill for the screw being used.

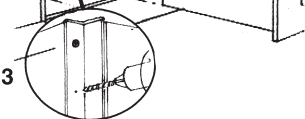

4. Replace the oven back into the carcass and firmly secure to the carcass using suitable screws.

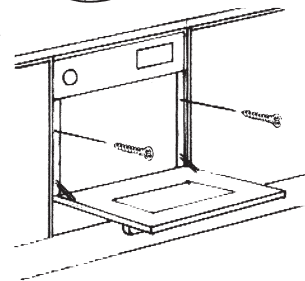

5. Always ensure that the doors/drawers on either side of the deflectors are adjusted so that the maximum clearance from the deflector is achieved.

Note: The doors must not be in contact with the deflectors.

600mm Built Under Oven Housings that do not require a Carcase

When Installing an Oven into the above situation the following steps must be adhered to:-

Heat Deflector Installation:

1. Using two 720mm deflectors, screw them tightly to the gables of the carcasses on either side of the oven using all the holes provided. Ensure that the top of the deflector is in firm contact with the bottom of the worktop and apply a thin bead of heat resistant clear silicone to form an airtight joint between the worktop and the deflector.

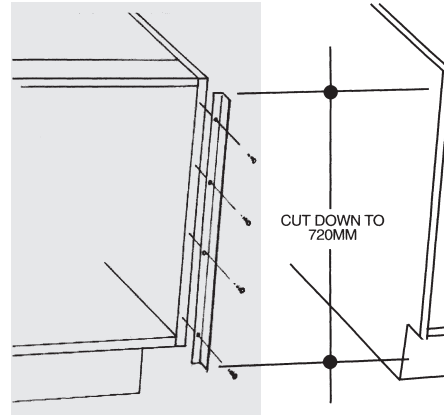

SILICONE SEALANT

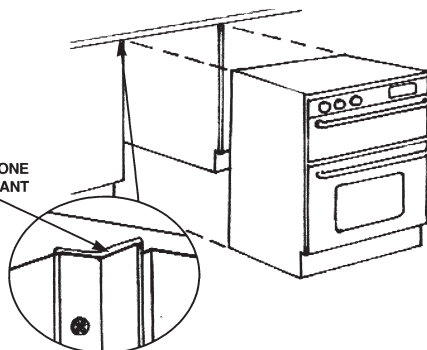

2. Fit the oven according to the manufacturers instructions.
3. Always ensure that the doors/drawers on either side of the deflectors are adjusted so that the maximum clearance from the deflector is achieved.

Note: The doors must not be in contact with the deflectors.

Ovens in Tall Appliance Housings

When Installing an Oven into the above situation the following steps must be adhered to:-

Heat Deflector Installation:

1. Using four suitably sized heat deflectors, make up a framework around Oven Housing Aperture as indicated. Screw the heat deflectors to the front edge of the carcass gables using the holes provided, ensure that the deflectors are pressed tightly together in each corner, apply a thin bead of heat resistant clear silicone to form an airtight seal.

2

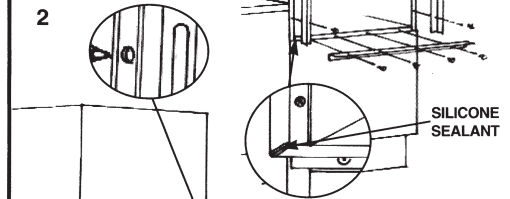

2. Position the oven into place in the carcass and mark the positions of the oven securing holes on the heat deflector.

3

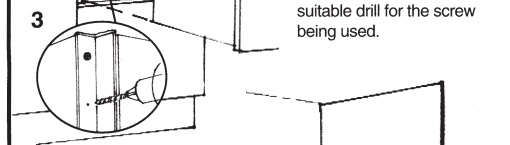

4. Replace the oven back into the carcass and firmly secure to the carcass using suitable screws.

5. Always ensure that the doors/drawers on either side of the deflectors are adjusted so that the maximum clearance from the deflector is achieved.

Note: The doors must not be in contact with the deflectors.

Range Slot in Ovens

When Installing a Range Type Oven into the above situation next to P. V. C. doors the following instructions must be adhered to:-

Heat Deflector Assembly:

1. Make up the 'L' Shaped Fillers by cutting two pieces of suitable co-ordinating melamine to achieve a dimension of 50mm x 35mm x 720mm.
2. Secure both pieces together using suitable screws.

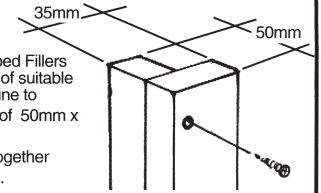

3. Secure suitable fixing brackets to the front edge of the carcass gables using suitable screws as indicated.

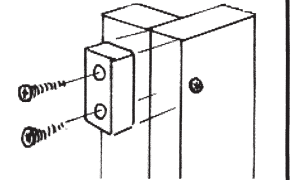

4. Secure 'L' shaped fillers to carcass gables through fixing brackets, using suitable screws as indicated.

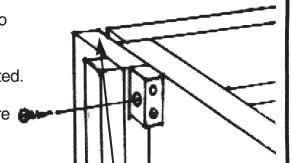

5. Ensuring that the fillers are positioned as diagram A.

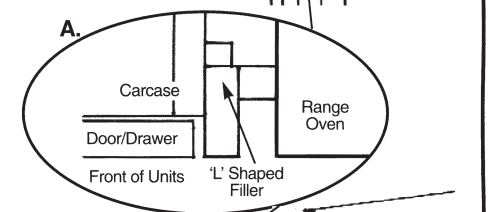

6. Fit the Oven according to the manufacturers instructions.

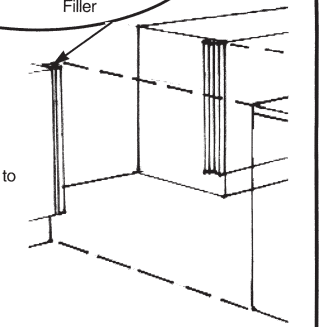

Note: Do not make these fillers out of P. V. C. wrapped material.